

5. PREPARE ENGINE FOR FLIGHT

A. Separate igniter & igniter plug.

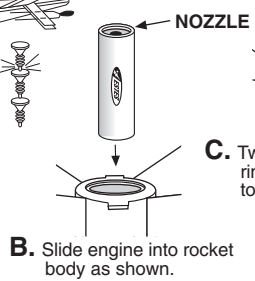

WARNING: FLAMMABLE
To avoid serious injury, read instructions & NAR Safety Code included with engines before proceeding. **PREPARE YOUR ENGINE ONLY WHEN YOU ARE OUTSIDE AT THE LAUNCH SITE PREPARING TO LAUNCH!** If you do not use your prepared engine, remove the igniter before storing your engine.



B. Slide engine into rocket body as shown.

C. Twist engine retainer ring into locked position to hold engine in place.

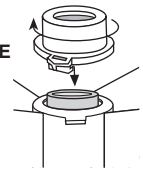

D. Drop in igniter as shown.



E. Insert igniter plug.

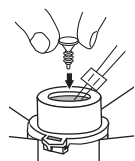

F. Firmly push igniter plug all the way in.

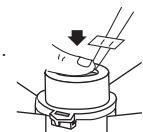

G. Gently bend igniter wires to form leads as shown.

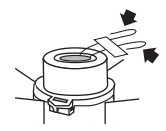

COUNTDOWN AND LAUNCH

KEY ALWAYS OUT UNTIL FINAL COUNTDOWN!

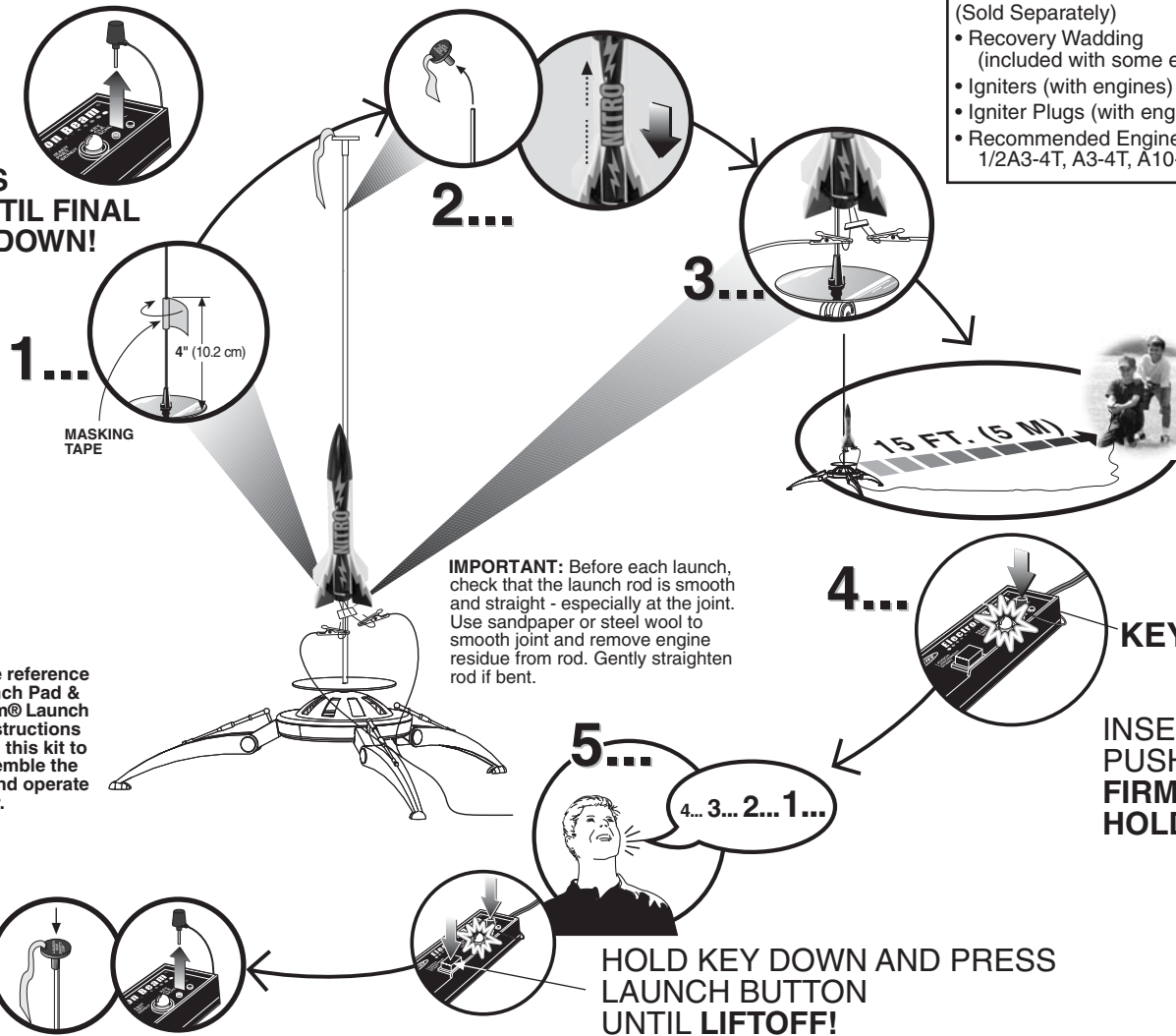

1...
4" (10.2 cm)
MASKING TAPE

2...

3...

4...

5...

4... 3... 2... 1...

IMPORTANT: Before each launch, check that the launch rod is smooth and straight - especially at the joint. Use sandpaper or steel wool to smooth joint and remove engine residue from rod. Gently straighten rod if bent.

NOTE: Please reference the Mini Launch Pad & Electron Beam® Launch Controller instructions included with this kit to properly assemble the launch pad and operate the controller.

HOLD KEY DOWN AND PRESS LAUNCH BUTTON UNTIL LIFTOFF!

ESTES LAUNCH SUPPLIES

- (Sold Separately)
- Recovery Wadding (included with some engines)
 - Igniters (with engines)
 - Igniter Plugs (with engines)
 - Recommended Engines: 1/4A3-3T, 1/2A3-4T, A3-4T, A10-3T

PRECAUTIONS

NAR Safety Code



NO DRY GRASS OR WEEDS

PRE-LAUNCH CHECK

For safety, never launch a damaged rocket. Check the rocket's body, nose cone and fins. Also, check the engine mount, recovery system and launch lug(s). Repair any damage before launching the rocket.

FLYING YOUR ROCKET

Choose a large field (250 ft. [76 m] square) free of dry weeds and brown grass. The larger the launch area, the better your chance of recovering your rocket. Football fields and playgrounds are great. Launch only with little or no wind and good visibility. Always follow the National Association of Rocketry (NAR) SAFETY CODE.

MISFIRES

TAKE THE KEY OUT OF THE CONTROLLER. WAIT ONE MINUTE BEFORE GOING NEAR THE ROCKET! Disconnect the igniter clips and remove the engine. Take the plug and igniter out of the engine. If the igniter has burned, it worked but did not ignite the engine because it was not touching the propellant inside the engine. Put a new igniter all the way inside the engine without bending it. Push the plug in place. Repeat the steps under Countdown and Launch.

FLYING MODEL ROCKET KIT INSTRUCTIONS

KEEP FOR FUTURE REFERENCE



ASSEMBLY TIP: Read all instructions before beginning work on your model. Make sure you have all parts and supplies.

TEST FIT ALL PARTS TOGETHER BEFORE APPLYING ANY GLUE!
If any parts don't fit properly, sand as required for precision assembly.

SUPPLIES In addition to the parts included in the kit you will also need:



PARTS Locate the parts shown below and lay them out on the table in front of you. DO NOT USE THIS DRAWING TO ASSEMBLE YOUR ROCKET.

PLASTIC ROCKET PARTS SET (61422)

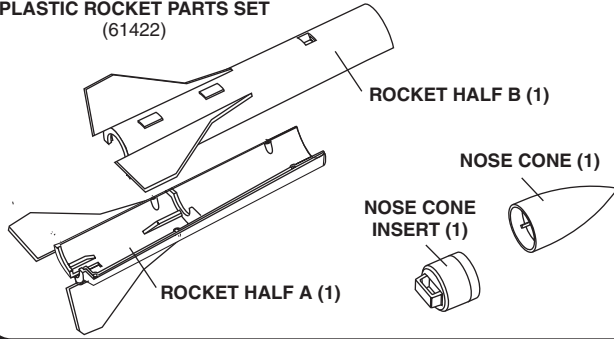

LAUNCH LUG (1) (33356)

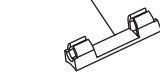

ENGINE RETAINER (2) (33313)

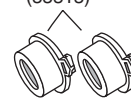

RUBBER SHOCK CORD (1) (38371)



STREAMER (1) (60034)

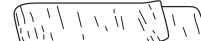

HELPFUL HINT: IF NOSE CONE FIT IS...

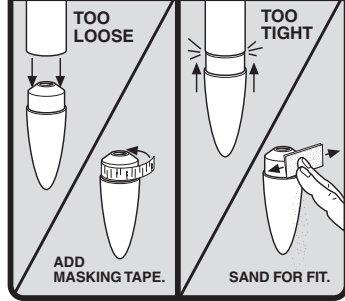

1. ASSEMBLE NOSE CONE

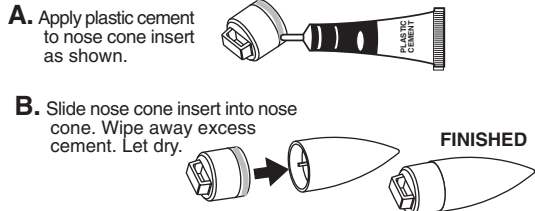

2. INSTALL SHOCK CORD

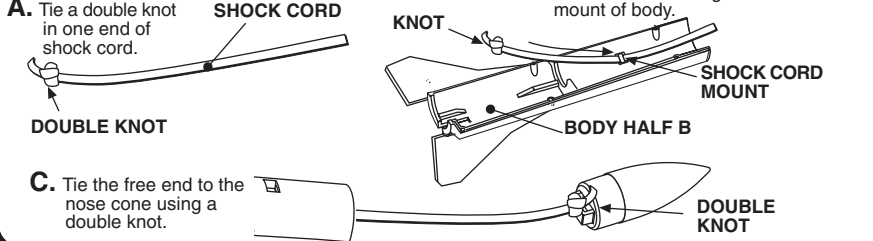

3. ASSEMBLE BODY HALVES

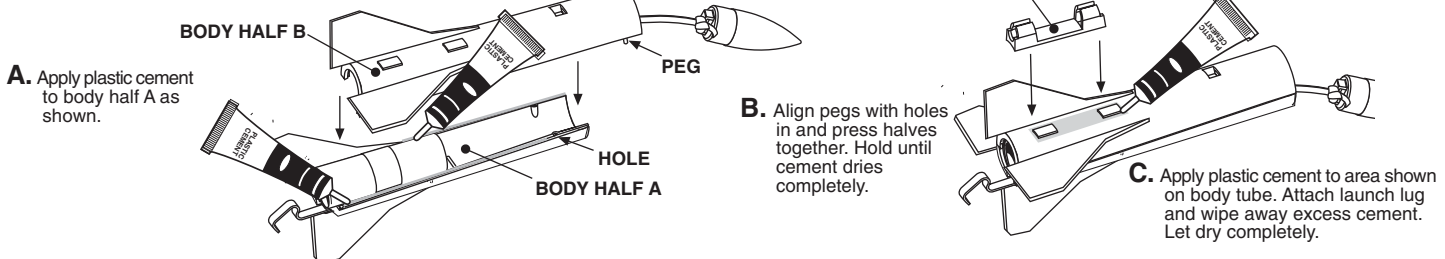

4. PREPARE STREAMER FOR FLIGHT

