



ESTES INDUSTRIES  
1295 H Street  
Penrose, CO 81240  
Printed In China



ALMOST READY TO FLY  
(7/01) 84476

# BANDIT™

## FLYING MODEL ROCKET KIT INSTRUCTIONS

### TOOLS REQUIRED:

ALL GLUED AREAS  
ARE SHADED IN RED



SCISSORS



MODELING KNIFE



PLASTIC CEMENT

### PARTS LAYOUT

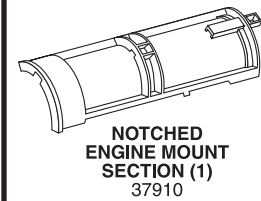

NOTCHED  
ENGINE MOUNT  
SECTION (1)  
37910

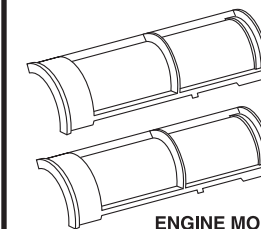

ENGINE MOUNT  
SECTIONS (2)  
37910

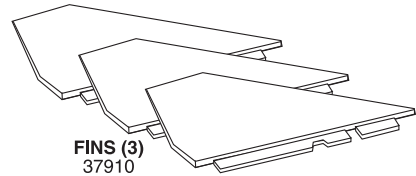

FINS (3)  
37910

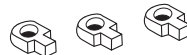

LAUNCH LUGS  
(USE 2)  
37910



FRONT ENGINE RING (1)  
37910



ENGINE MOUNT  
TUBE - 735A (1)  
30331



REAR ENGINE  
RING (1)  
37910

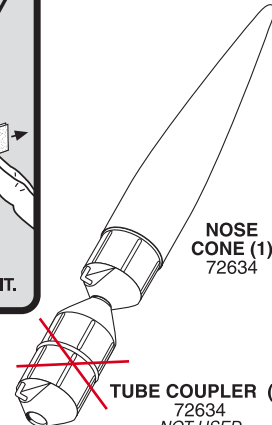
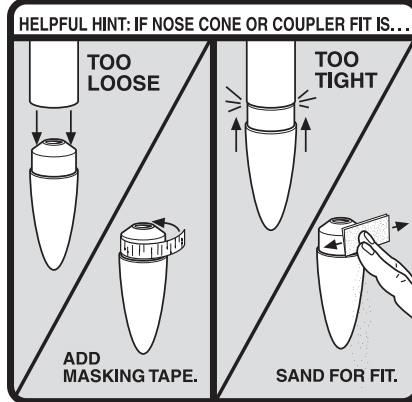

NOSE  
CONE (1)  
72634



TUBE COUPLER (1)  
72634  
NOT USED



LOCK (1)  
37910  
NOT USED



SHOCK CORD  
MOUNT (1)  
37910

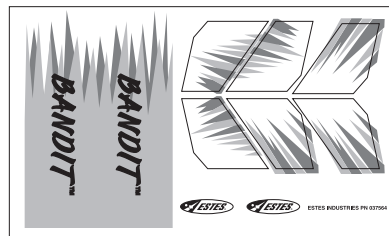

DECAL (1)  
37564

Assembled Parachute 12" (30 cm)  
w/engine hook and shock cord (1)  
(035804)-Supplied as set

1. A. Apply plastic cement as shown and slide front engine ring inside engine mount tube. Line up with **long** notch.

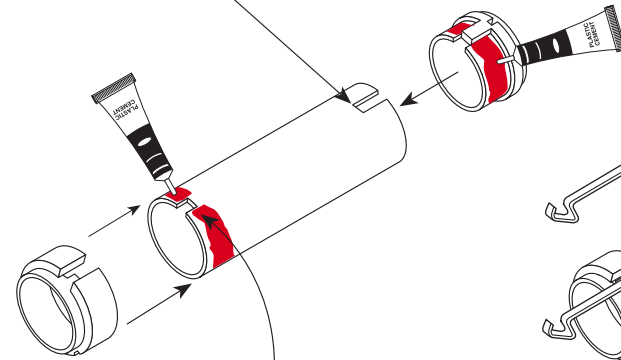

B. Slide rear engine ring over tube. Line up with **short** notch.

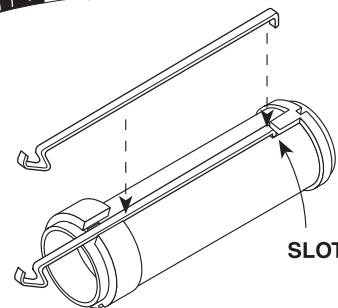

C. Attach engine hook. Push front tab through slot in tube.

IMPORTANT! THIS NOTCH GOES OVER ENGINE HOOK

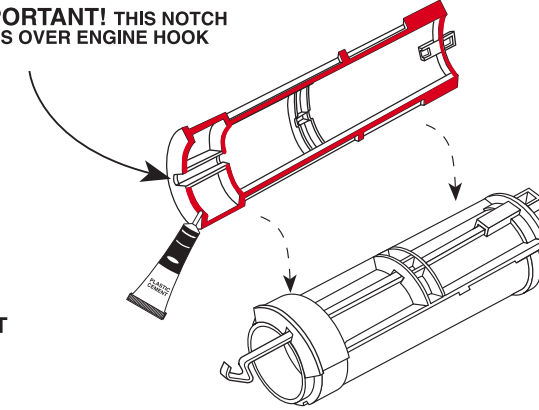

D. Apply cement to underside of **notched** engine mount section and attach.

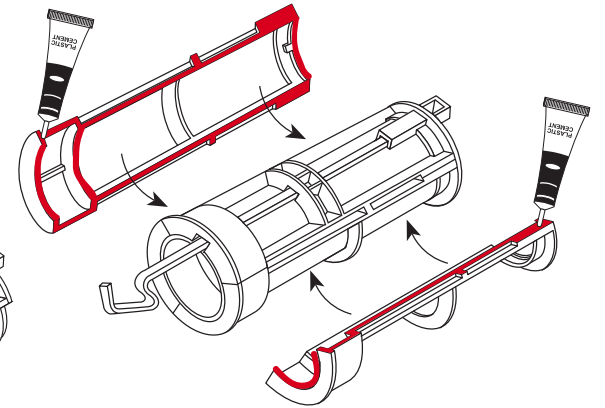

E. Now attach the remaining sections with cement as shown.

2. IMPORTANT! LINE UP LAUNCH LUG OPENINGS!

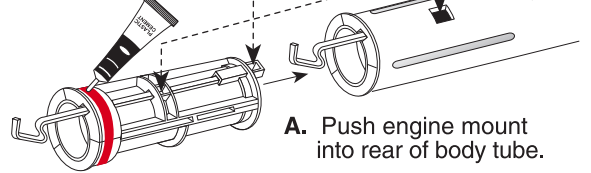

A. Push engine mount into rear of body tube.

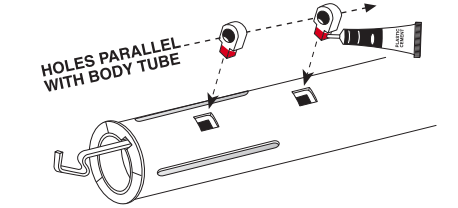

B. Attach launch lugs with plastic cement.

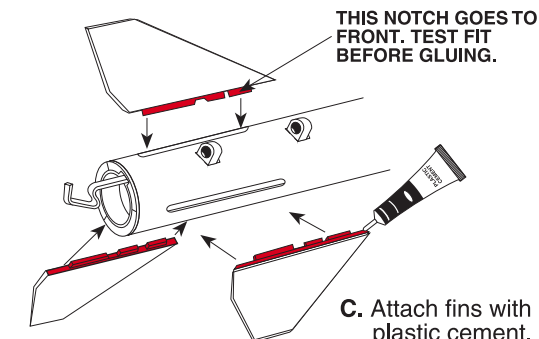

C. Attach fins with plastic cement.

D. Set rocket on table as shown so fins will stay straight while cement sets.

3. A. Locate elastic shock cord and shock cord mount.



B. Apply plastic cement to shock cord mount as shown. Attach to body tube through square hole. Let dry.

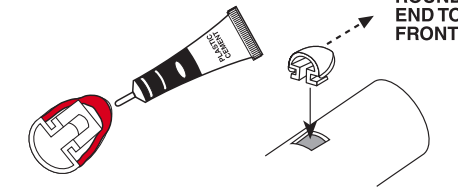

C. Tie double knot in end of shock cord. Push other end through until knot is tight against shock cord mount.

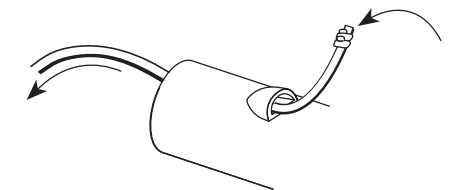

4. A. Snap the tube coupler and the nose cone apart. The tube coupler is not used in this kit.

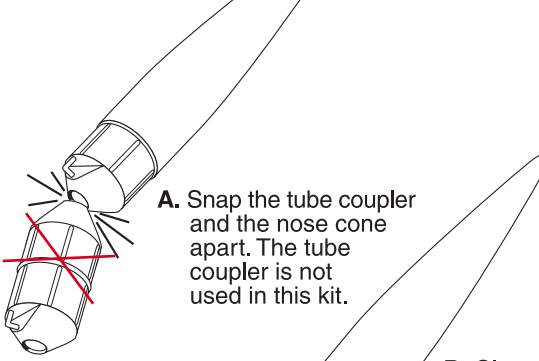

B. Clean the eye of the nose cone.

CAUTION: DO NOT CUT OFF.

5. A. Form loop with shroud lines.

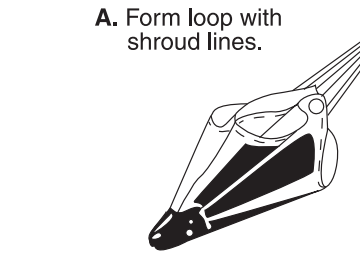

B. Push loop through eye of nose cone.

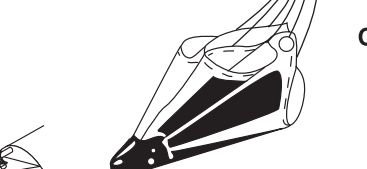

C. Pass parachute through loop.

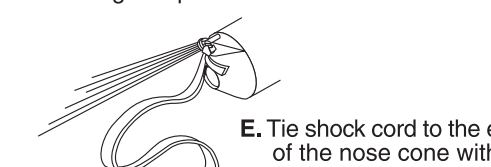

E. Tie shock cord to the eye of the nose cone with a double knot.

SHOCK CORD

D. Pull tight.



## 6. PACKING PARACHUTE

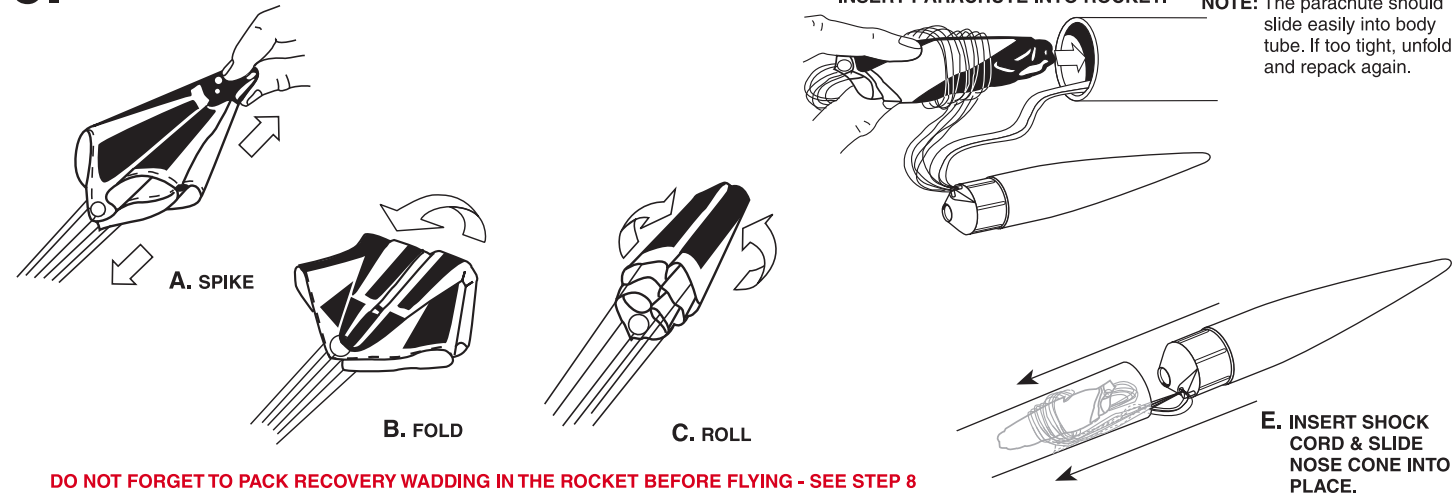

DO NOT FORGET TO PACK RECOVERY WADDING IN THE ROCKET BEFORE FLYING - SEE STEP 8

## 7. APPLYING DECALS

REMOVE DECALS FROM BACKING PAPER. APPLY DECALS AS SHOWN ON BOX ART. WHEN POSITIONED CORRECTLY, RUB DOWN TO REMOVE BUBBLES.



## 8. FLYING YOUR ROCKET

**WARNING: FLAMMABLE**  
Before proceeding read instructions & NAR Safety Code included with engines.

**PREPARE YOUR ENGINE ONLY WHEN YOU ARE OUTSIDE AT THE LAUNCH SITE PREPARING TO**

If you do not use your prepared engine, remove the igniter before storing your engine.

### ENGINE PREPARATION

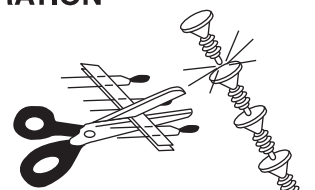

A. Separate igniter and igniter plug.

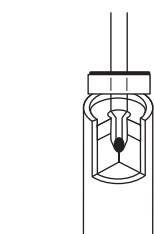

B. Hold engine upright, drop in igniter. Igniter must touch propellant. Do not bend igniter.



C. Insert igniter plug.

### ROCKET PREPARATION

Remove nose cone, shock cord and parachute.

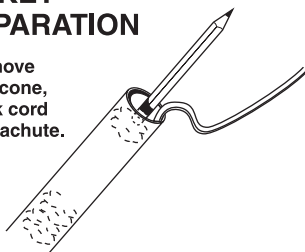

Crumple and insert three squares of recovery wadding. Repack and insert parachute, shock cord and nose cone.

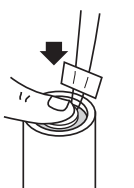

D. Push plug all the way in.

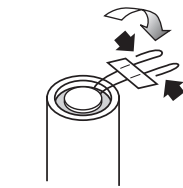

E. Bend igniter wires back.

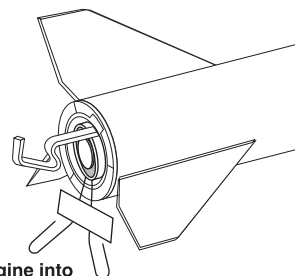

F. Insert engine into rocket.

## COUNTDOWN AND LAUNCH

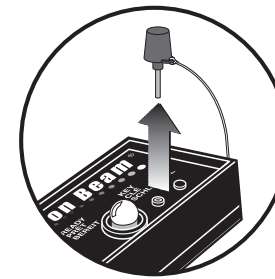

KEY ALWAYS OUT UNTIL FINAL COUNTDOWN!

1...

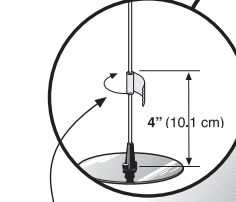

MASKING TAPE

2...



3...



4...

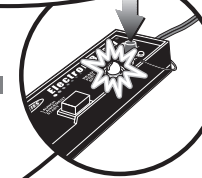

PRESS KEY DOWN & HOLD

5...

4...3...2...1...



HOLD KEY DOWN AND PRESS BUTTON UNTIL LIFT-OFF!

## PRECAUTIONS

NAR Safety Code



NO DRY GRASS OR WEEDS

## FLYING YOUR ROCKET

Choose a large field (500 ft. [152 m] square) free of dry weeds and brown grass. The larger the launch area, the better your chance of recovering your rocket. Football fields and playgrounds are great. Launch only with little or no wind and good visibility.

Always follow the National Association of Rocketry (NAR) SAFETY CODE.

## MISFIRES

**TAKE THE KEY OUT OF THE CONTROLLER. WAIT ONE MINUTE BEFORE GOING NEAR THE ROCKET!** Disconnect the igniter clips and remove the engine. Take the plug and igniter out of the engine. If the igniter has burned, it worked but did not ignite the engine because it was not touching the propellant inside the engine. Put a new igniter all the way inside the engine without bending it. Push the plug in place. Repeat the steps under Countdown and Launch.

## LAUNCH SUPPLIES

(Sold Separately)

- Estes® Porta Pad® II Launch Pad and Electron Beam® Controller
- Recovery Wadding
- Igniters (with Engines)
- Igniter Plugs (with Engines)
- Estes® Recommended Engines: A8-3, (First Flight) B4-4, B6-4, B6-6, C6-5, C6-7