

## RECOVERY SYSTEM ATTACHMENT

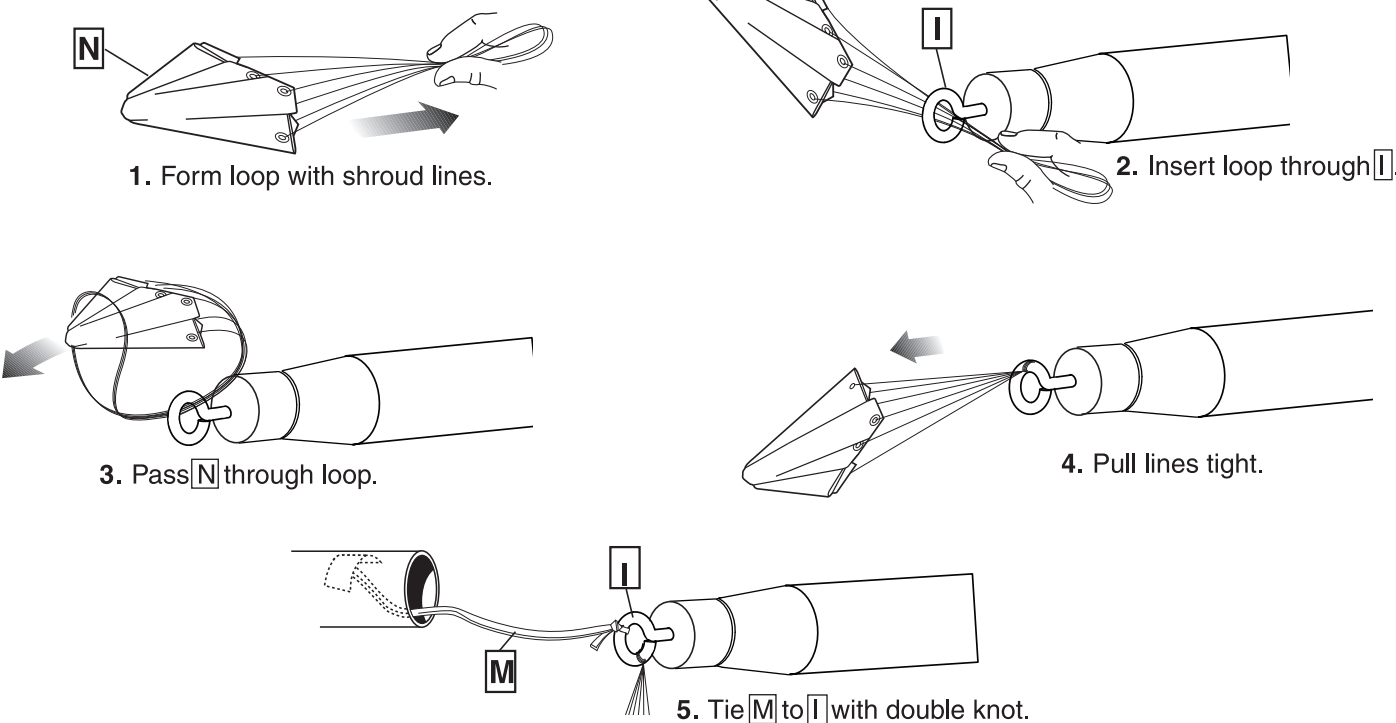

## PREPARE FLIGHT RECOVERY

NOTE: Only Estes Recovery Wadding (302274) recommended.

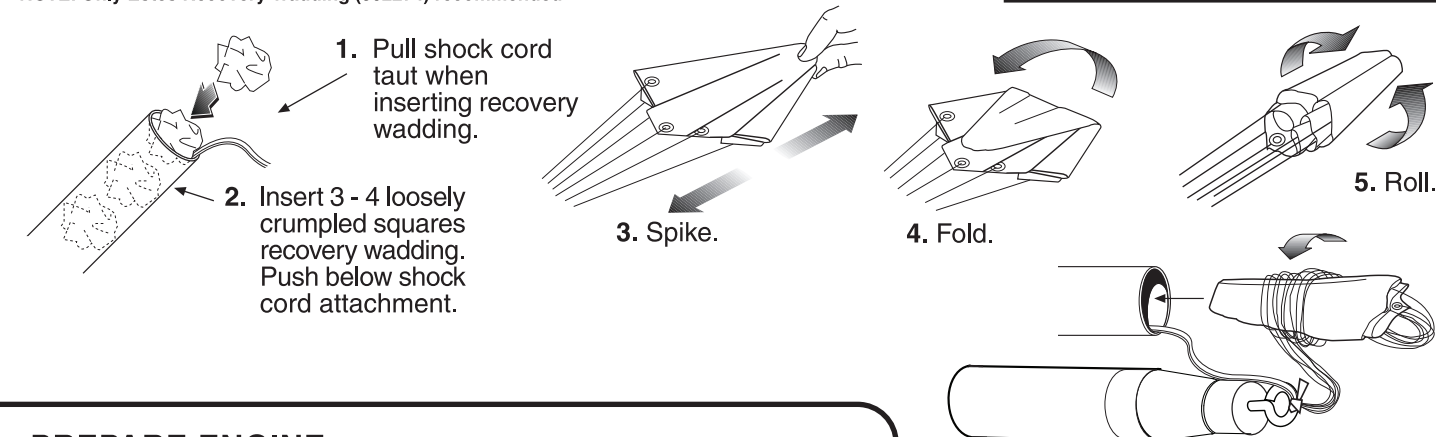

NOTE: Recovery wadding and parachute must slide easily into body tube. If too tight, redo.

## PREPARE ENGINE

### WARNING: FLAMMABLE

To avoid serious injury, read instructions & NAR Safety Code included with engines. **PREPARE ENGINE ONLY WHEN YOU ARE OUTSIDE AT THE LAUNCH SITE PREPARING TO LAUNCH!** If you do not use your prepared engine, remove the igniter before storing engine.

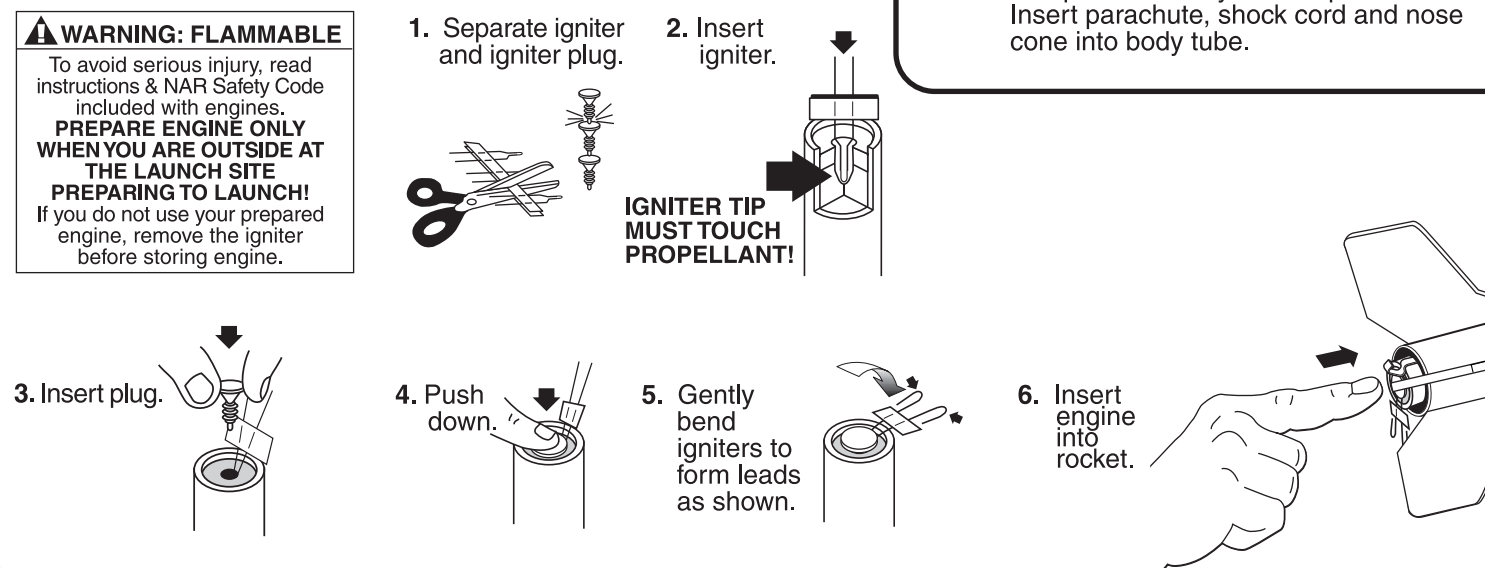

IGNITER TIP MUST TOUCH PROPELLANT!

## COUNTDOWN AND LAUNCH

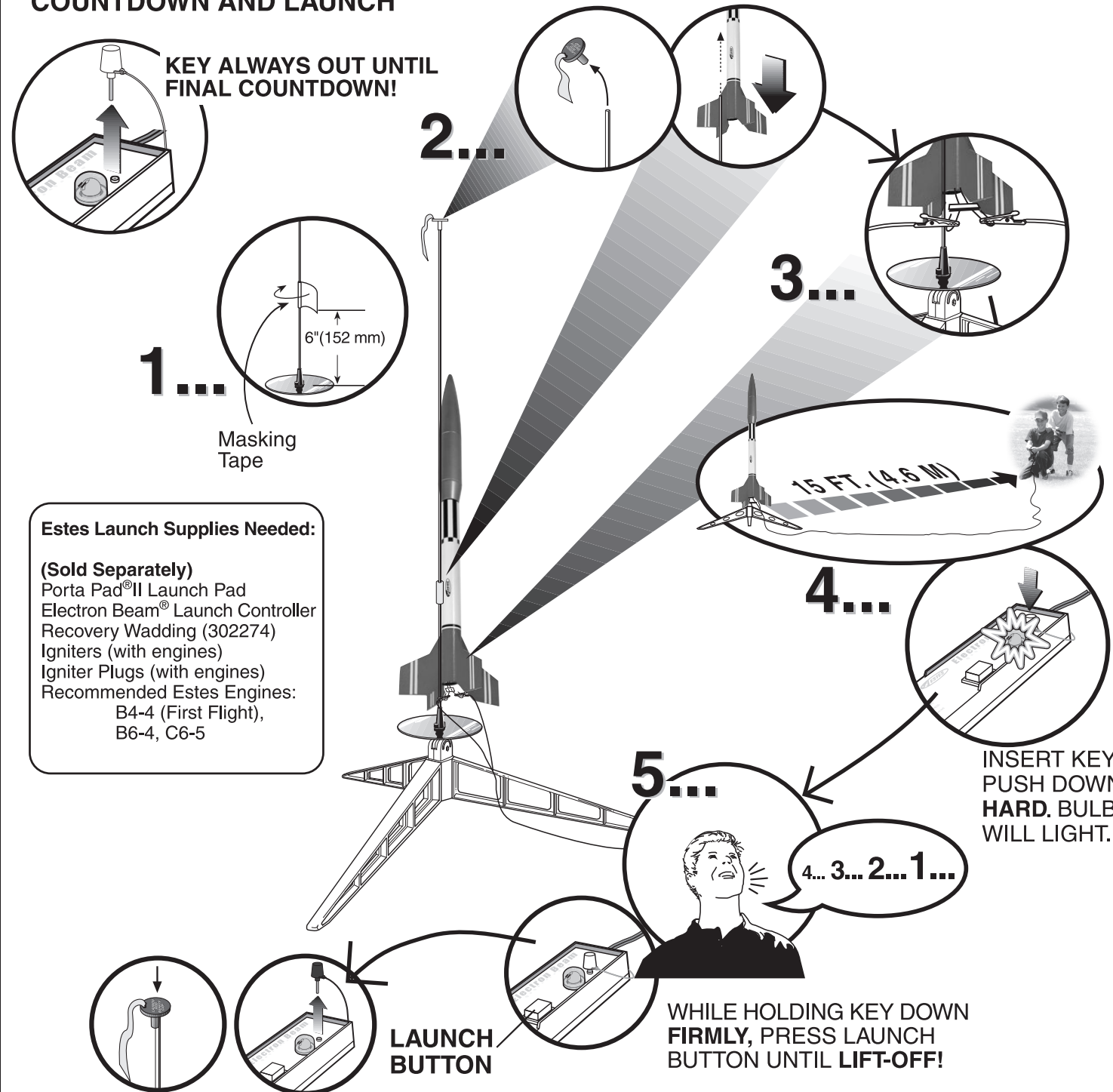

## PRECAUTIONS



Estes-Cox Corp.  
1295 H Street, PO Box 227  
Penrose, CO 81240-0227  
Printed in China

# REFLECTOR™

#2422

FLYING MODEL ROCKET KIT INSTRUCTIONS  
KEEP FOR FUTURE REFERENCE

**ASSEMBLY TIP:** Read all instructions before beginning work on your model. Make sure you have all parts and supplies.



www.estesrockets.com

NOTE: Test fit all parts together before applying glue. If parts don't fit properly, sand as required for precision assembly.

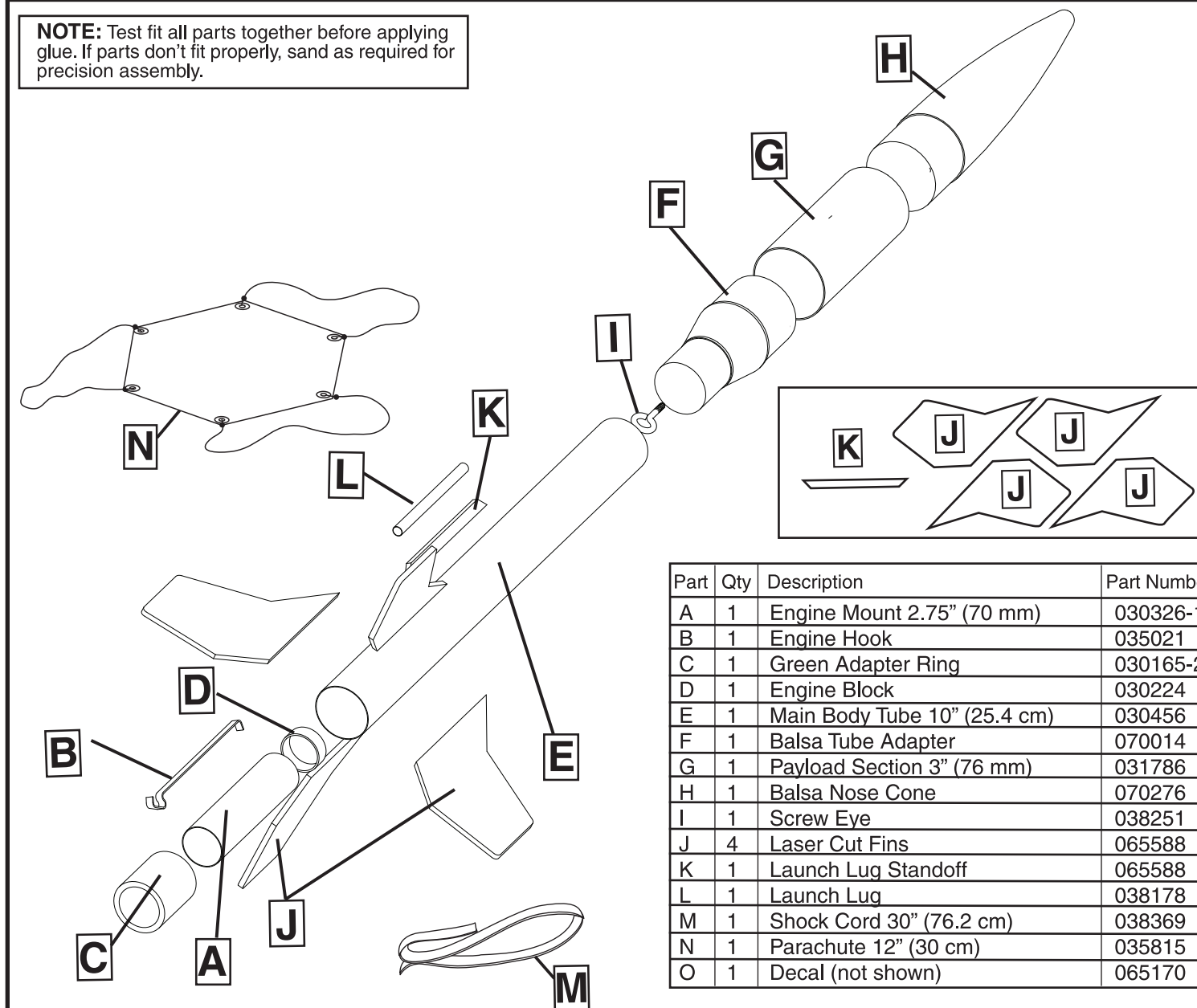

## SUPPLIES

In addition to the parts included in the kit you will also need:

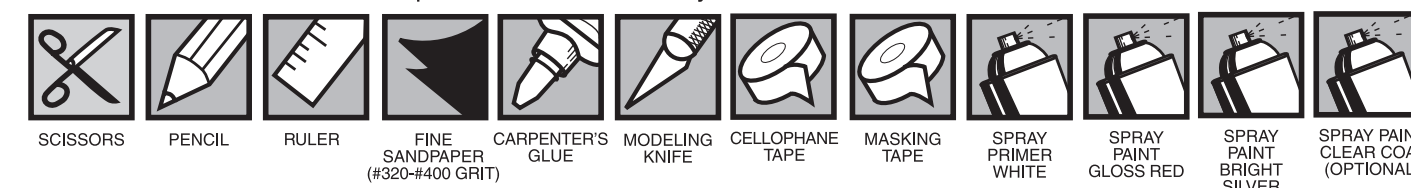

## TUBE MARKING GUIDE AND SHOCK CORD MOUNT (Make a copy if you want to keep instructions.)

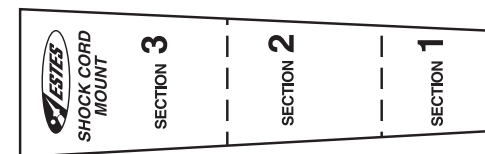
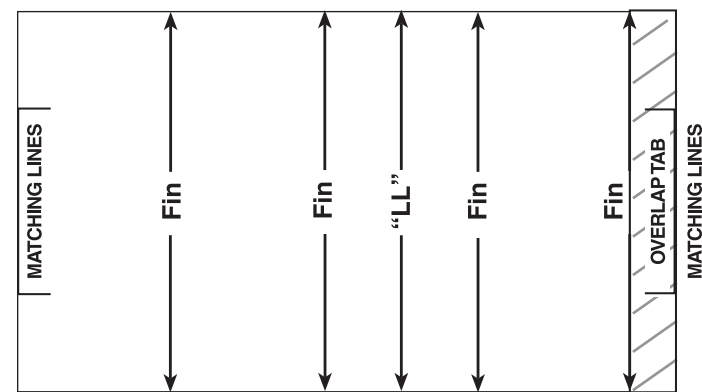

## FIN PREPARATION

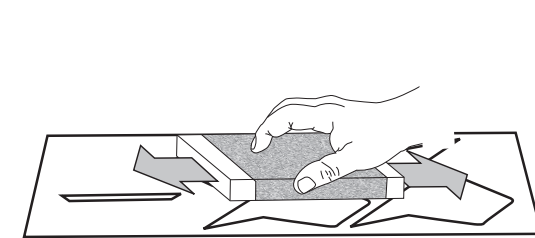

1. Sand both sides of balsa sheet with fine sandpaper (#320 or #400 grit).

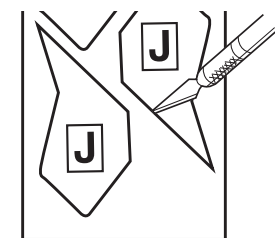

2. Cut **J** and **K** from sheet.

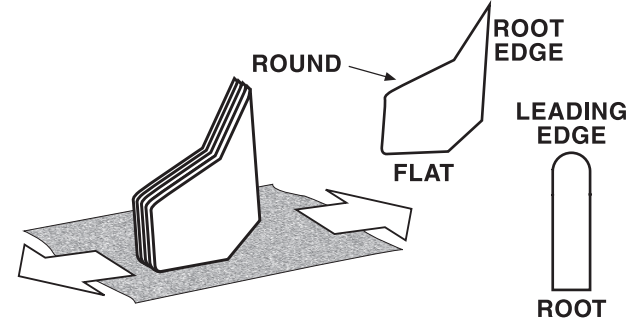

3. Stack like fins together. Sand edges smooth. Do not sand root edge round.

## ENGINE MOUNT ASSEMBLY

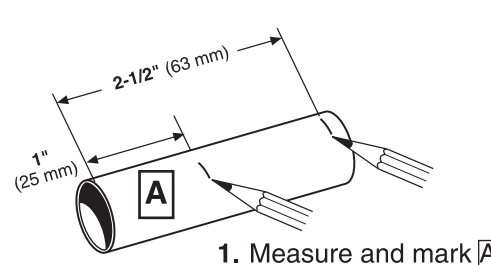

1. Measure and mark **A**.

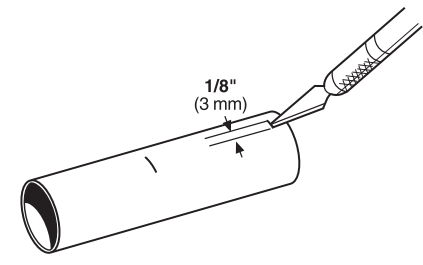

2. Cut slit at mark.

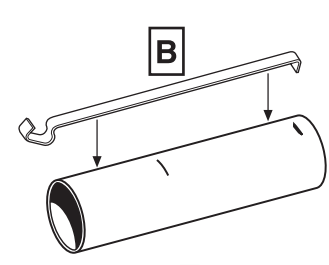

3. Insert **B** in slit.

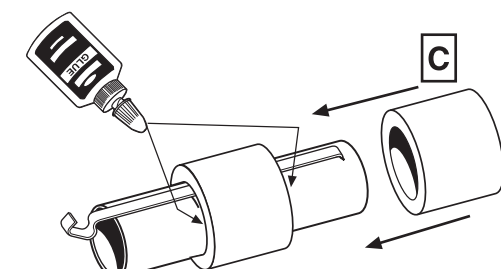

4. Slide **C** to mark. Apply glue to both sides of **C**.

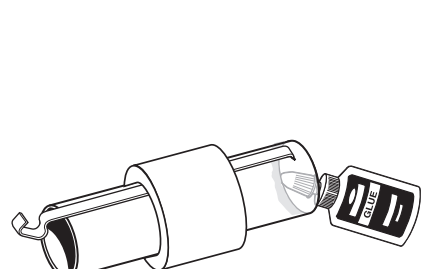

5. Apply glue in end of **A**.

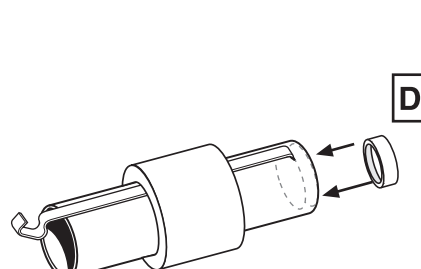

6. Insert **D** until it stops. Let dry.

## TUBE MARKING

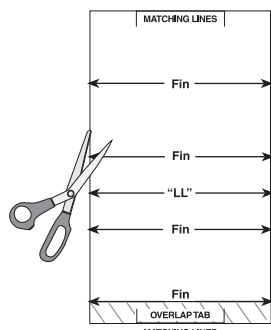

1. Cut tube marking guide from instructions.

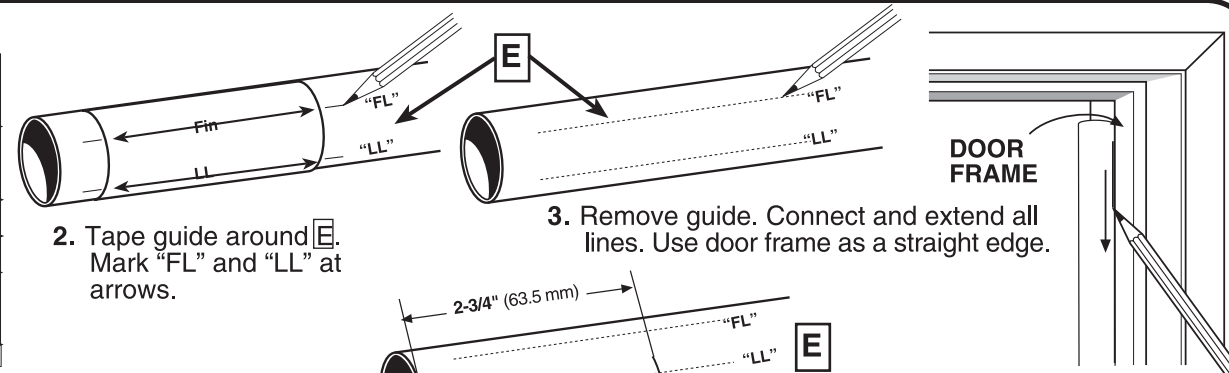

2. Tape guide around **E**. Mark "FL" and "LL" at arrows.

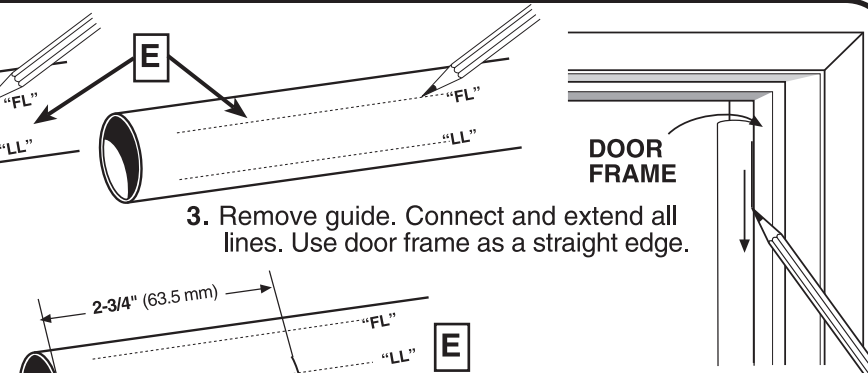

3. Remove guide. Connect and extend all lines. Use door frame as a straight edge.



4. Measure and mark "LL".

## FIN ATTACHMENT

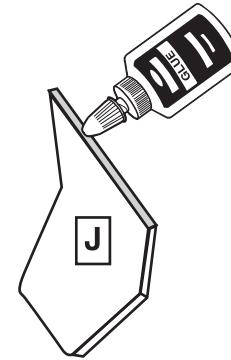

1. Apply glue to root edge of **J**. Allow to dry 1 minute. Apply 2nd layer of glue and position **J** centered on "FL" at end of **E**. Use fin alignment guide for fin attachment accuracy. Let dry.

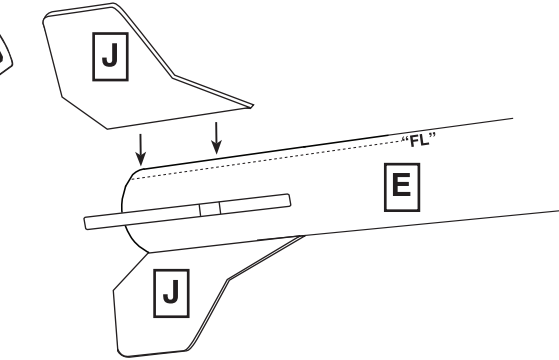

2. Repeat for remaining **J**.

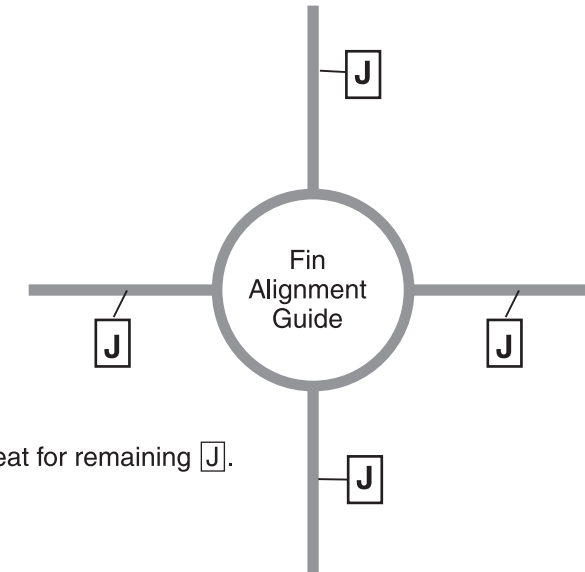

## LAUNCH LUG ATTACHMENT

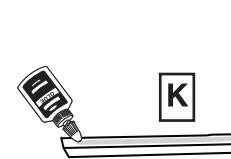

1. Apply glue to long edge of **K**.

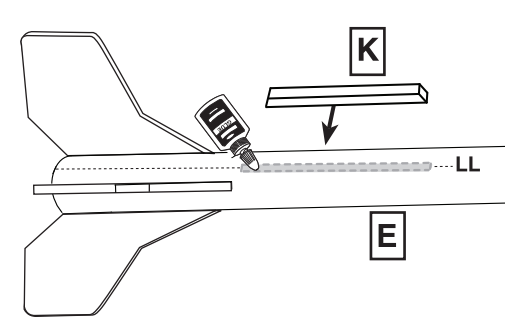

2. Position **K** over "LL" forward of mark. Let dry.

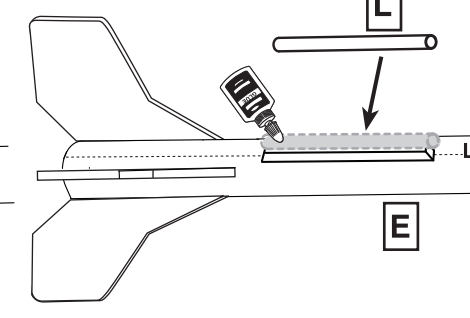

3. When dry, glue **L** centered on **K**.

## ENGINE MOUNT INSTALLATION

NOTE: Fin removed from drawing for clarity.

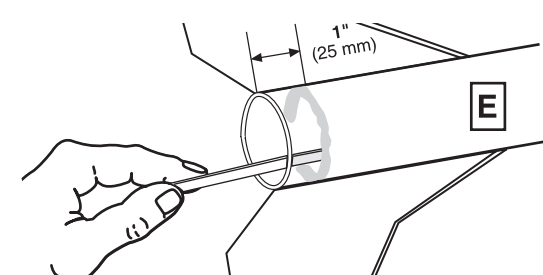

1. Apply glue inside of **E**.

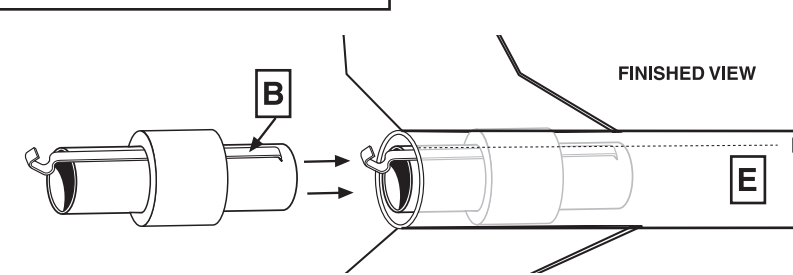

2. Align **B** with "LL" and slide engine mount assembly into **E** even with end. Let dry.

## PAYLOAD SECTION ASSEMBLY

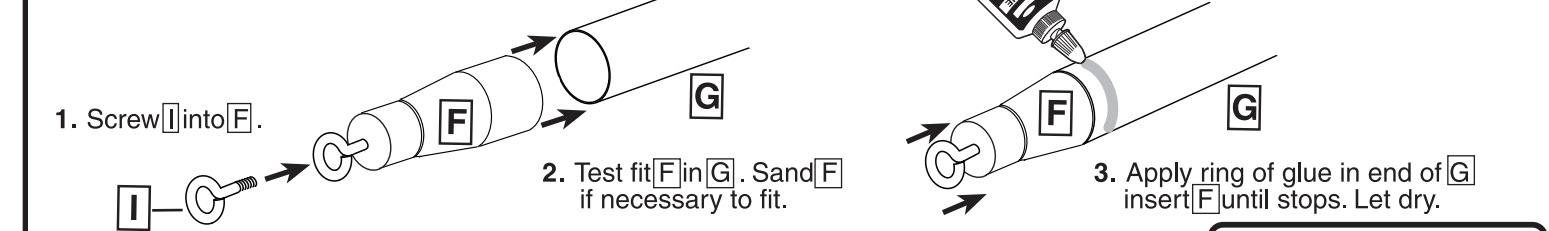

1. Screw **I** into **F**.

2. Test fit **F** in **G**. Sand **F** if necessary to fit.

3. Apply ring of glue in end of **G** insert **F** until stops. Let dry.

## NOSE CONE ASSEMBLY

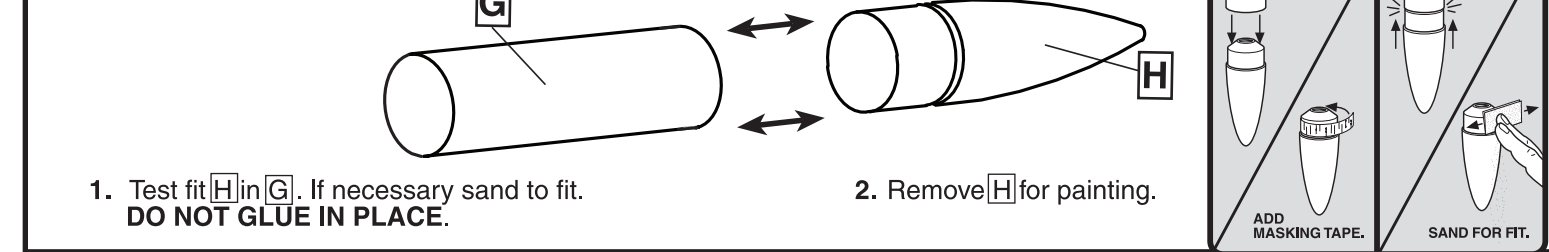

1. Test fit **H** in **G**. If necessary sand to fit. DO NOT GLUE IN PLACE.

2. Remove **H** for painting.

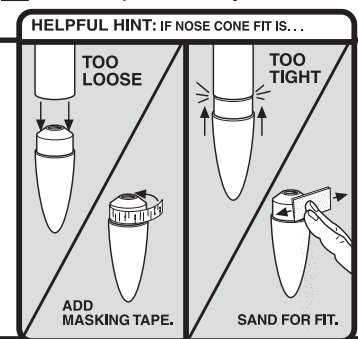

## SHOCK CORD MOUNT INSTALLATION

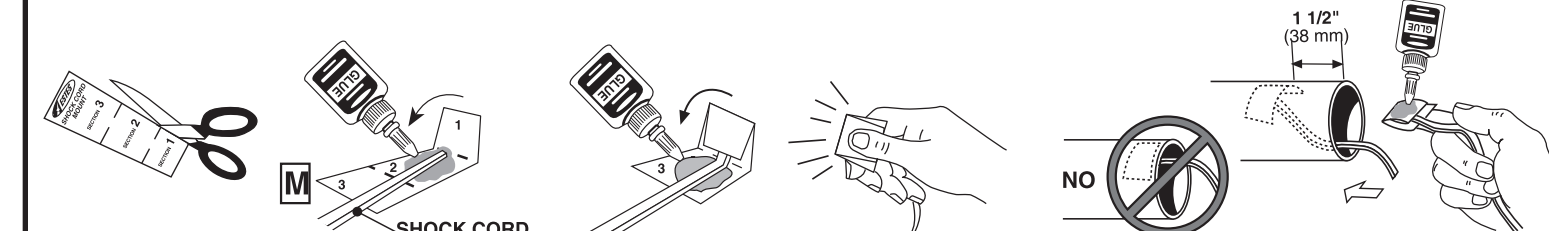

1. Cut shock cord mount from instructions.

2. Apply glue to section 2. Place **M** on glue. Fold forward.

3. Apply glue and fold forward.

4. Squeeze tight!

5. Apply glue to shock cord mount and insert in body tube. Hold until glue sets. Let dry.

## ROCKET FINISHING

NOTE: We have found Testors spray primers (Testors #2948 White Primer), Testors One Coat Lacquer spray paints (color of your choice), Testors Model Master spray paints (color of your choice) and Testors Gloss Lacquer (#1961) to be excellent for providing a long lasting and durable finish on your rocket. Always be sure to spray your models outside or in a well ventilated area.

## STEPS FOR A QUALITY FINISH

- Insert shock cord into body tube and hold in place with paper.
- Lightly sand entire rocket with fine sandpaper (#320 or #400 grit).
- Apply glue fillet to fins and launch lug joints.
  - Let glue dry overnight.
- Paint the main rocket body, payload section and nose cone separately. Assemble after painting is complete.
- Use a stick inserted into the motor tube end of the rocket body for painting.
- Hold the payload section by the screw eye with a clip or pliers for painting.
- Insert a small nail into the base of the nose cone for painting.
- We recommend a good filler/primer to be applied to the balsa fins, tube adapter and nose cone before painting.
- Sand after each application for a smooth finish.
- Apply 1-2 light coats of white primer to upper and lower rocket sections.
- Lightly sand with fine sandpaper (#320 or #400 grit) between coats. Allow to dry between each coat.
- Spray paint main rocket body gloss white.
  - Let paint dry overnight (24 hours is best).
- Apply masking tape and protective cover around main rocket body above fins.
  - Let paint dry overnight (24 hours is best). Remove tape.
- Spray paint payload section bright silver or platinum.
  - Let paint dry overnight (24 hours is best).
- Spray paint nose cone bright silver or platinum.
  - Let paint dry overnight (24 hours is best). Remove tape.
- Apply waterslide decals where shown.
  - Cut the decal to be applied from the decal sheet, trimming close to the decal edge.
  - Hold the decal in warm water until decal begins to curl.
  - Remove the entire decal, position in place and slide the decal from the backing material and onto the model as close to final position as possible.
  - Gently blot out excess water with a clean paper towel.
  - Let decals set overnight before applying protective clear coat.
- When decals are dry, spray entire rocket (main body, payload section and nose cone separately) with a light coat of Testors Gloss Lacquer (#1961). This will provide added protection and shine to your Reflector™ rocket!

