

- Hold the nose cone by the screw eye with a clip or pliers for painting.
- We recommend a good filler/primer to be applied to the balsa fins and nose cone before painting.
- Apply 1-2 light coats of primer to rocket body and nose cone, lightly sanding with fine sandpaper (#320 or #400 grit) between coats.
  - Allow to dry between each coat.
- When satisfied with base finish, paint main rocket and nose cone gloss white (paint separately).
  - Let paint dry overnight (24 hours is best).
- Measure 1/4" (6 mm) from the lower end of (F) and mark with a pencil.
- Apply masking tape at mark and cover the lower end of the rocket.
- Measure 6 1/2" (165 mm) from front end of rocket and mark (F) with a pencil.
- Apply masking tape at mark and cover the front end of the rocket.
- Spray middle section bright orange.
  - Let paint dry overnight (24 hours is best). Remove masking tape.
- Apply waterslide decals where shown.
  - Cut the decal to be applied from the decal sheet, trimming close to the decal edge.
  - Hold the decal in warm water until decal begins to curl.
  - Remove the entire decal, position in place and slide the decal backing material from under the decal and onto the model as close to final position as possible.
  - Gently blot out excess water with a clean paper towel.
  - Allow decals to set overnight before applying protective clear coat.
- When decals are dry, spray entire rocket (body and nose cone separately) with a light coat of Testors Gloss Lacquer (#1961). This will provide added protection and shine to your Photon Disruptor™ rocket!

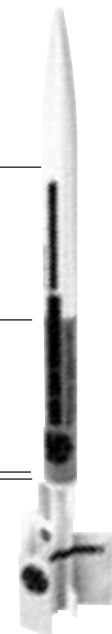

### RECOVERY SYSTEM ATTACHMENT

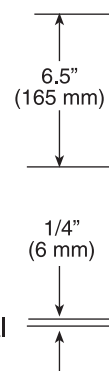
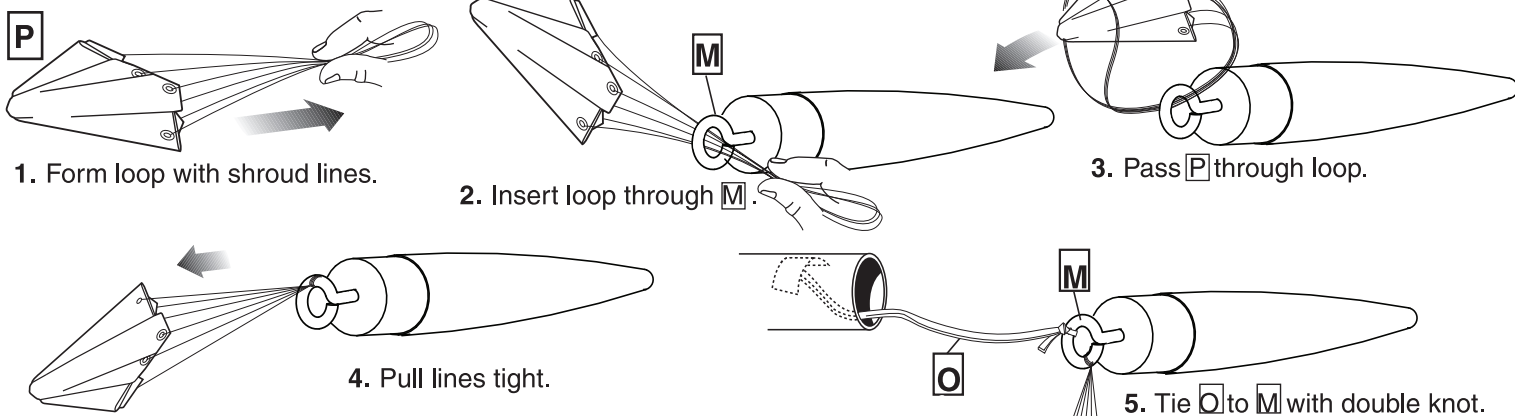

### PREPARE FLIGHT RECOVERY

NOTE: Only Estes Recovery Wadding (302274) recommended.

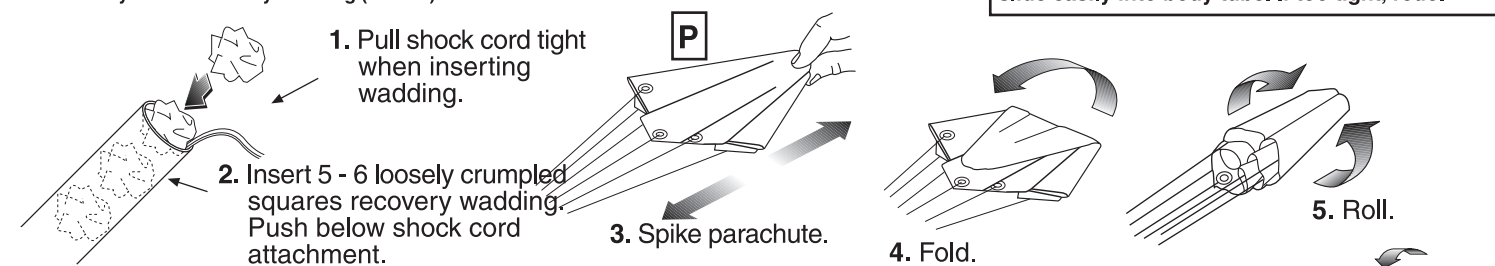

NOTE: Recovery wadding and parachute must slide easily into body tube. If too tight, redo.

### PREPARE ENGINE

#### ⚠ WARNING: FLAMMABLE

To avoid serious injury, read instructions & NAR Safety Code included with engines.  
**PREPARE ENGINE ONLY WHEN YOU ARE OUTSIDE AT THE LAUNCH SITE PREPARING TO LAUNCH!**  
 If you do not use your prepared engine, remove the igniter before storing engine.

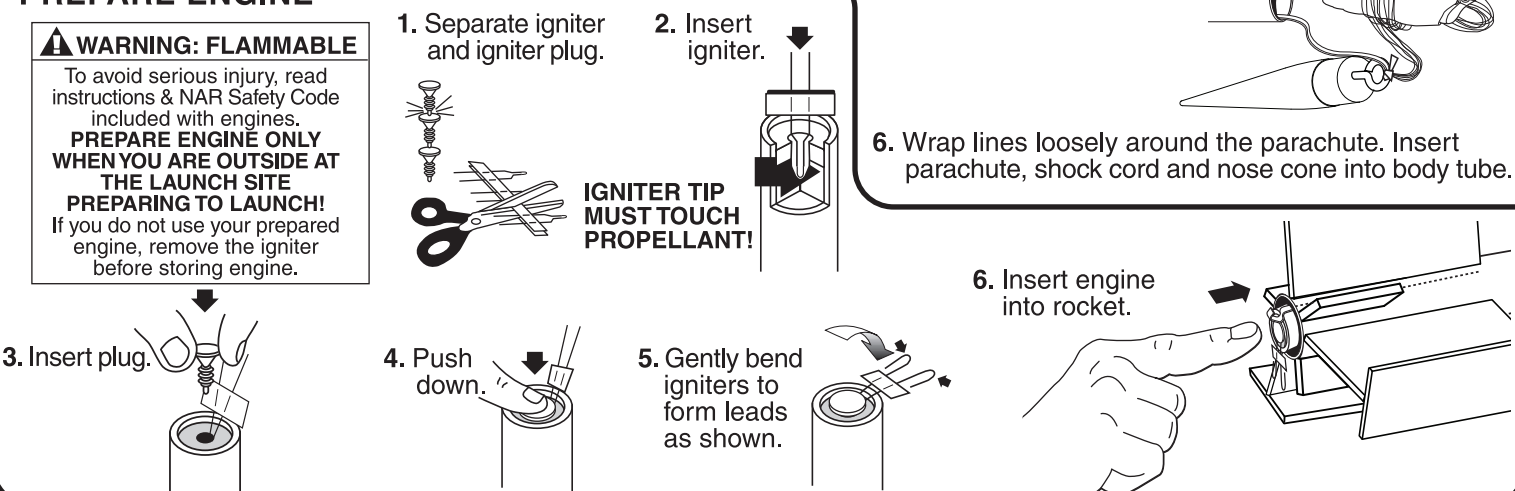

### COUNTDOWN AND LAUNCH

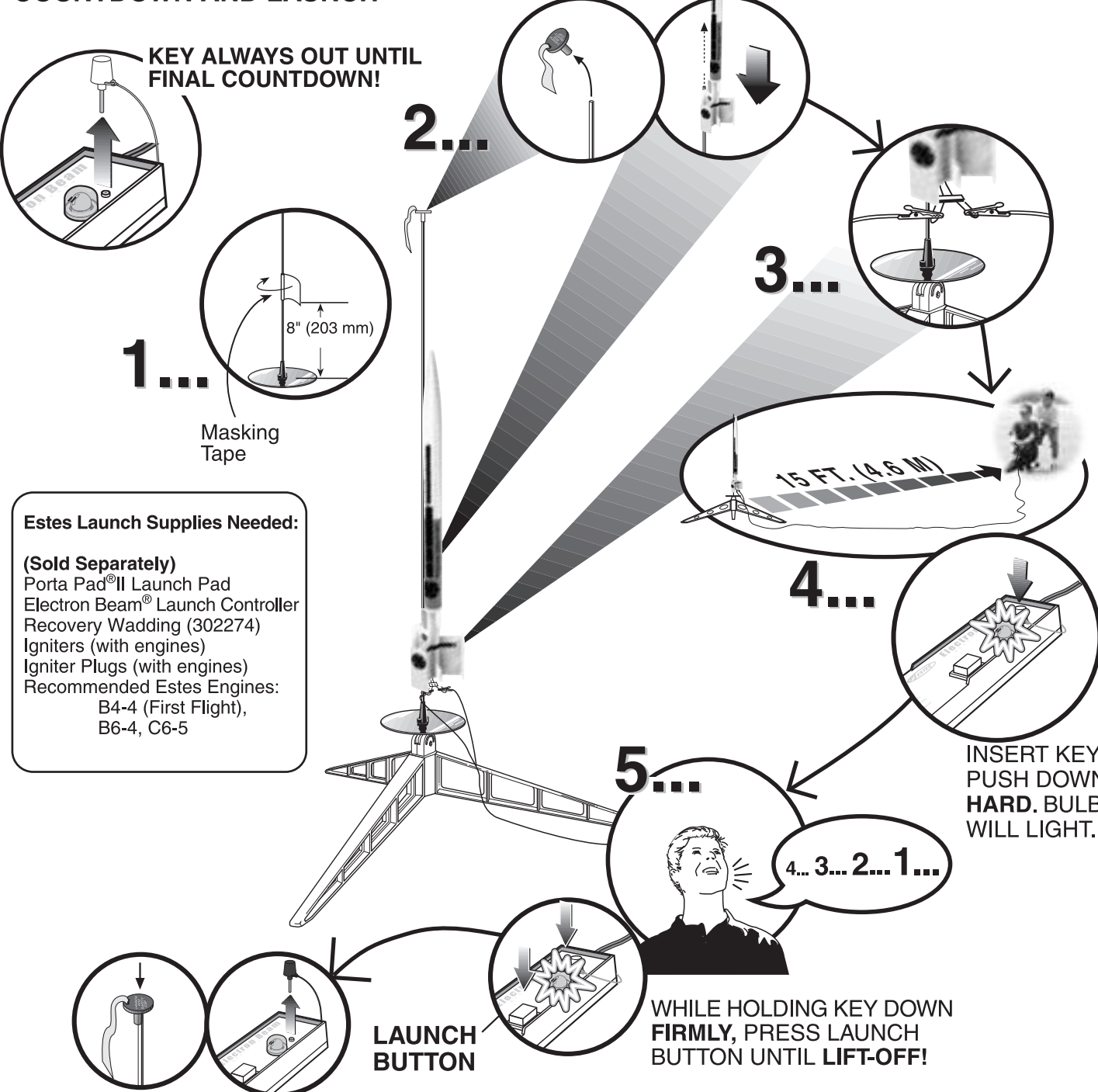

#### Estes Launch Supplies Needed:

(Sold Separately)  
 Porta Pad® II Launch Pad  
 Electron Beam® Launch Controller  
 Recovery Wadding (302274)  
 Igniters (with engines)  
 Igniter Plugs (with engines)  
 Recommended Estes Engines:  
 B4-4 (First Flight),  
 B6-4, C6-5

### PRECAUTIONS



Estes-Cox Corp.  
 1295 H Street, PO Box 227  
 Penrose, CO 81240-0227  
 Printed in China

# PHOTON DISRUPTOR™

FLYING MODEL ROCKET KIT INSTRUCTIONS  
 KEEP FOR FUTURE REFERENCE

#3025



**ASSEMBLY TIP:** Read all instructions before beginning work on your model. Make sure you have all parts and supplies.

**NOTE:** Test fit all parts together before applying glue. If parts don't fit properly, sand as required for precision assembly.

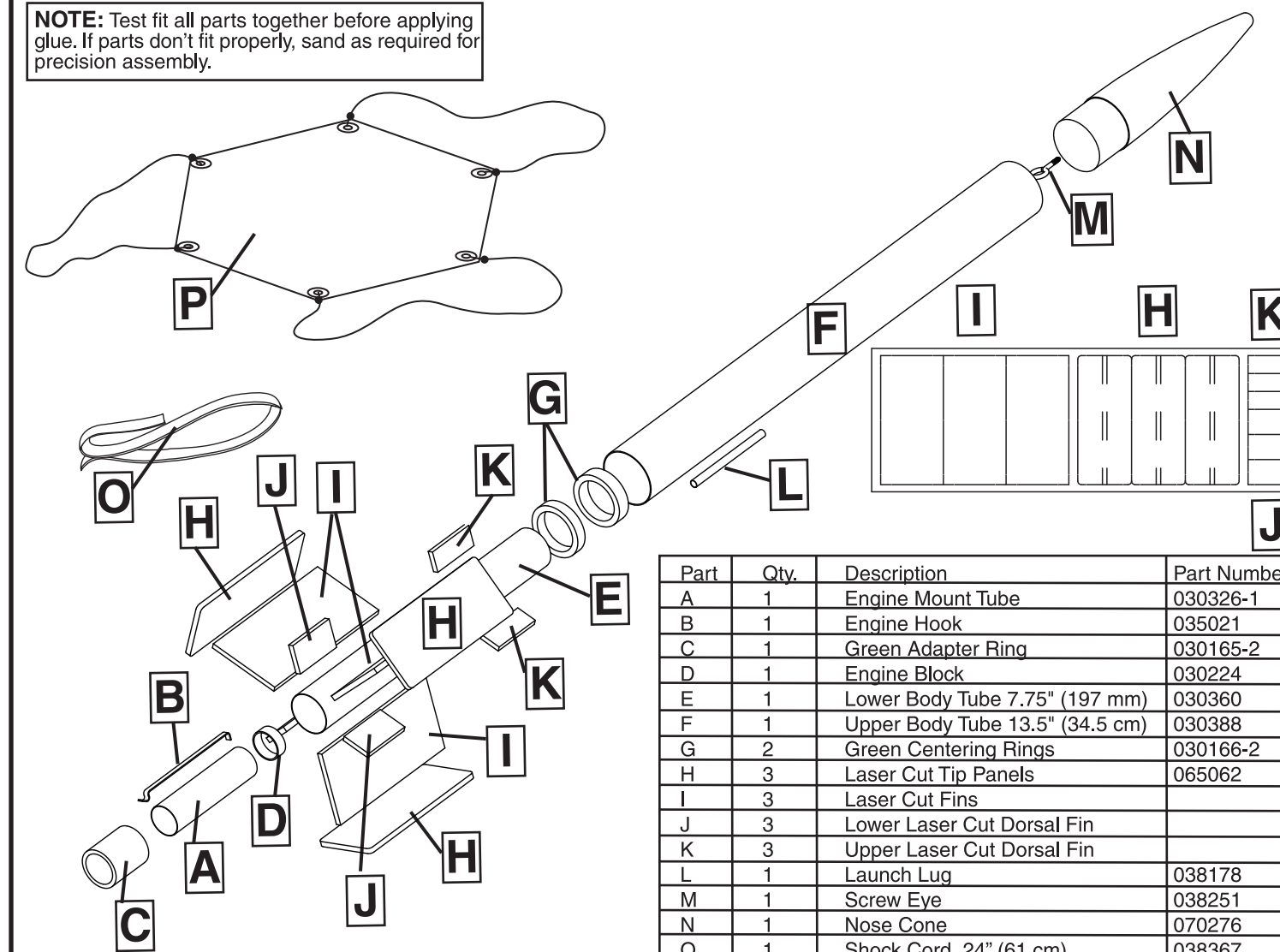

Part	Qty.	Description	Part Number
A	1	Engine Mount Tube	030326-1
B	1	Engine Hook	035021
C	1	Green Adapter Ring	030165-2
D	1	Engine Block	030224
E	1	Lower Body Tube 7.75" (197 mm)	030360
F	1	Upper Body Tube 13.5" (34.5 cm)	030388
G	2	Green Centering Rings	030166-2
H	3	Laser Cut Tip Panels	065062
I	3	Laser Cut Fins	
J	3	Lower Laser Cut Dorsal Fin	
K	3	Upper Laser Cut Dorsal Fin	
L	1	Launch Lug	038178
M	1	Screw Eye	038251
N	1	Nose Cone	070276
O	1	Shock Cord 24" (61 cm)	038367
P	1	Parachute 18" (45 cm)	035816
Q	1	Decal (not shown)	065207

### SUPPLIES

In addition to the parts included in the kit you will also need:

