

RECOVERY SYSTEM ATTACHMENT

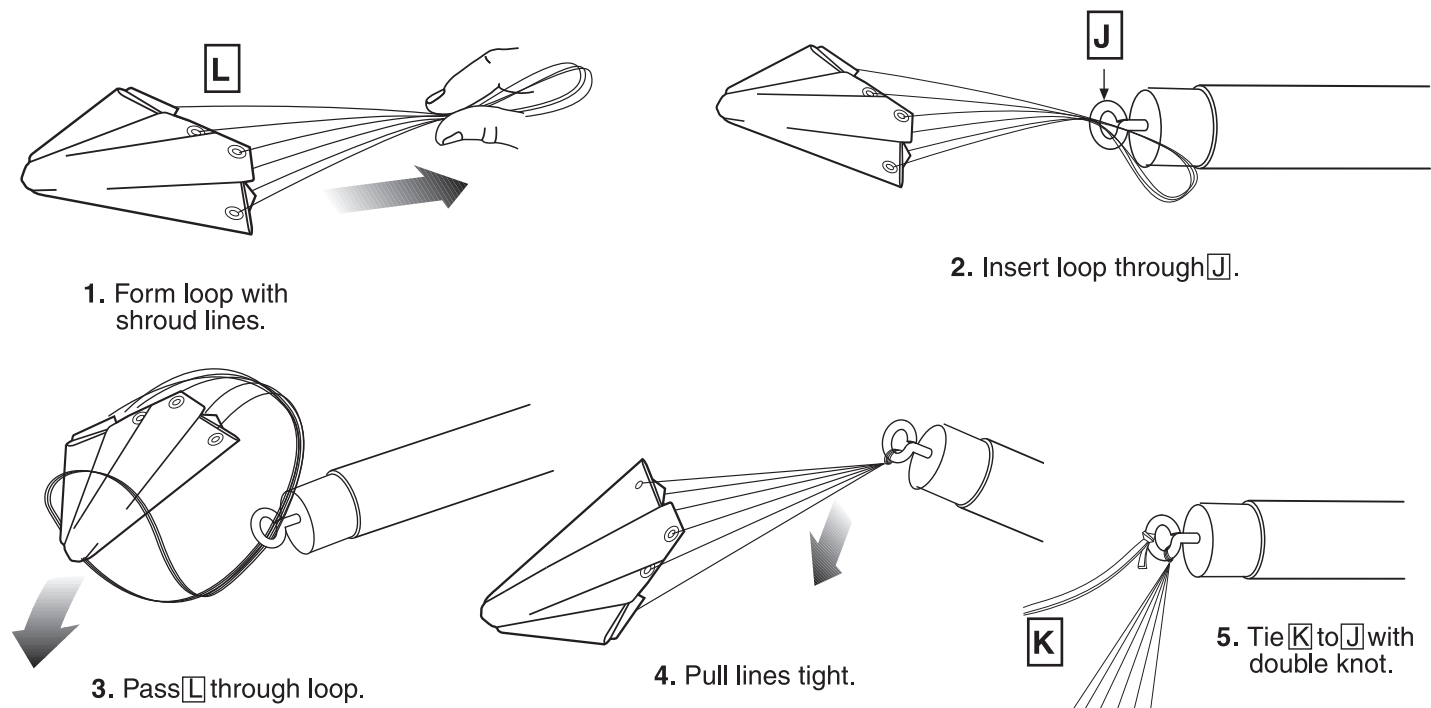

FLIGHT RECOVERY PREPARATION

NOTE: Only Estes Recovery Wadding (302274) recommended.

NOTE: Recovery wadding and parachute must slide easily into body tube. If too tight, redo.

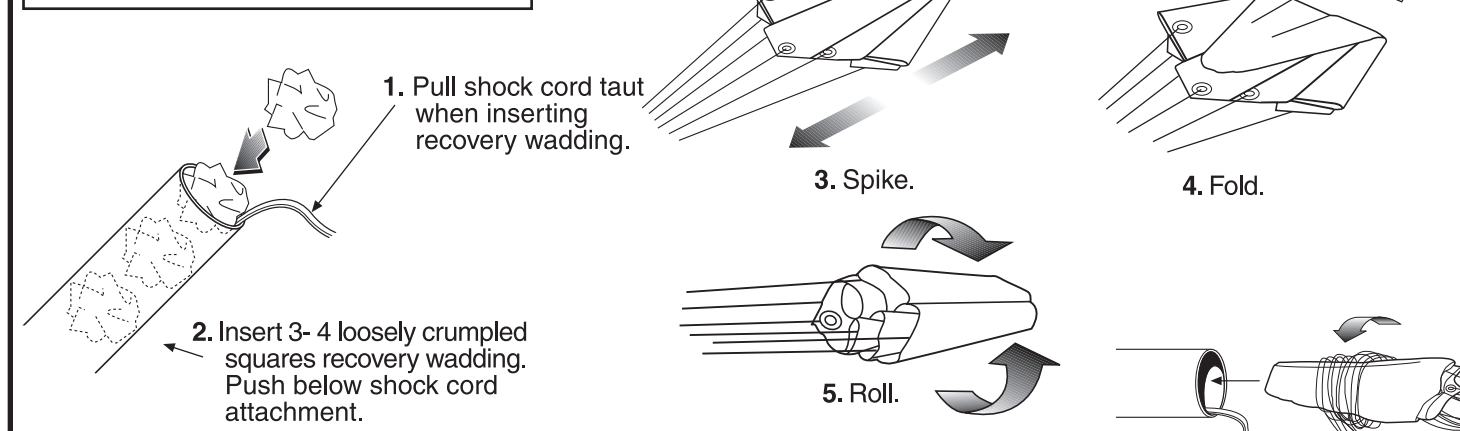

ENGINE PREPARATION

WARNING: FLAMMABLE

To avoid serious injury, read instructions & NAR Safety Code included with engines. **PREPARE ENGINE ONLY WHEN YOU ARE OUTSIDE AT THE LAUNCH SITE PREPARING TO LAUNCH!** If you do not use your prepared engine, remove the igniter before storing engine.

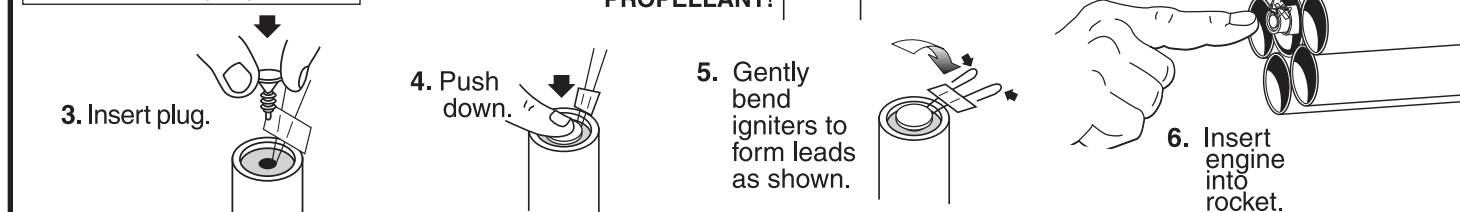

COUNTDOWN AND LAUNCH

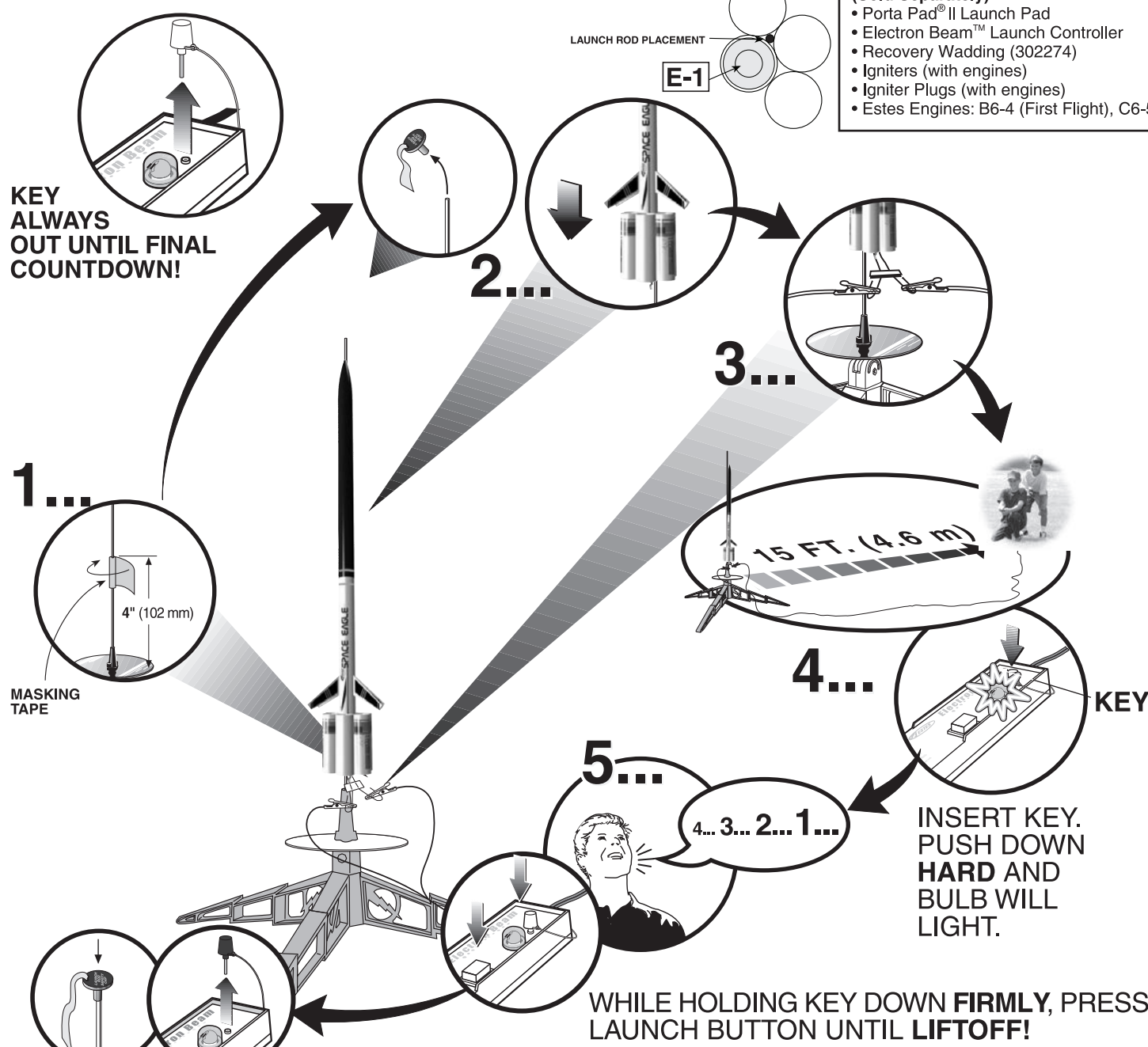

ESTES LAUNCH SUPPLIES NEEDED (Sold Separately)

- Porta Pad® II Launch Pad
- Electron Beam™ Launch Controller
- Recovery Wadding (302274)
- Igniters (with engines)
- Igniter Plugs (with engines)
- Estes Engines: B6-4 (First Flight), C6-5

PRECAUTIONS

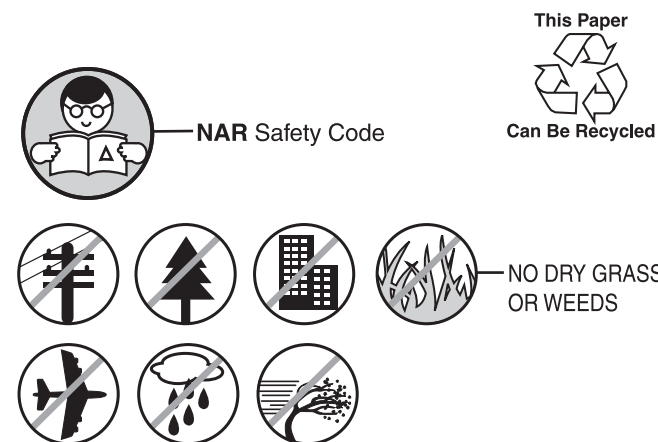

PRE-LAUNCH CHECK

For safety, never launch a damaged rocket. Check the rocket's body, nose cone and fins. Also, check the engine mount, recovery system and launch lug. Repair any damage before launching the rocket.

FLYING YOUR ROCKET

Choose a large field (500 ft. [153 m] square) free of dry weeds and brown grass. The larger the launch area, the better your chance of recovering your rocket. Football fields and playgrounds are great. Launch only with little or no wind and good visibility.

Always follow the National Association of Rocketry (NAR) SAFETY CODE.

MISFIRES

TAKE THE KEY OUT OF THE CONTROLLER. WAIT ONE MINUTE BEFORE GOING NEAR THE ROCKET! Disconnect the igniter clips and remove the engine. Take the plug and igniter out of the engine. If the igniter has burned, it worked but did not ignite the engine because it was not touching the propellant inside the engine. Put a new igniter all the way inside the engine without bending it. Push the plug in place. Repeat the steps under Countdown and Launch.



SPACE EAGLE™

FLYING MODEL ROCKET KIT INSTRUCTIONS

KEEP FOR FUTURE REFERENCE.

Estes-Cox Corp.
1295 H Street, PO Box 227
Penrose, CO 81240-0227
Printed in Guangdong, China

ASSEMBLY TIP

Read all instructions before beginning work on your model. Make sure you have all parts and supplies.

NOTE: Test fit all parts together before applying glue. If parts don't fit properly, sand as required for precision assembly.

IMPORTANT: Your Estes product is marked with a four digit lot code or codes. The code is two digits, a space and two more digits representing the week and year of manufacture, respectively. Lot codes can be found on the product package, decal, launch controller, launch pad and/or blast deflector. Please record the lot code found on the decal and keep for future reference. Lot code: _____

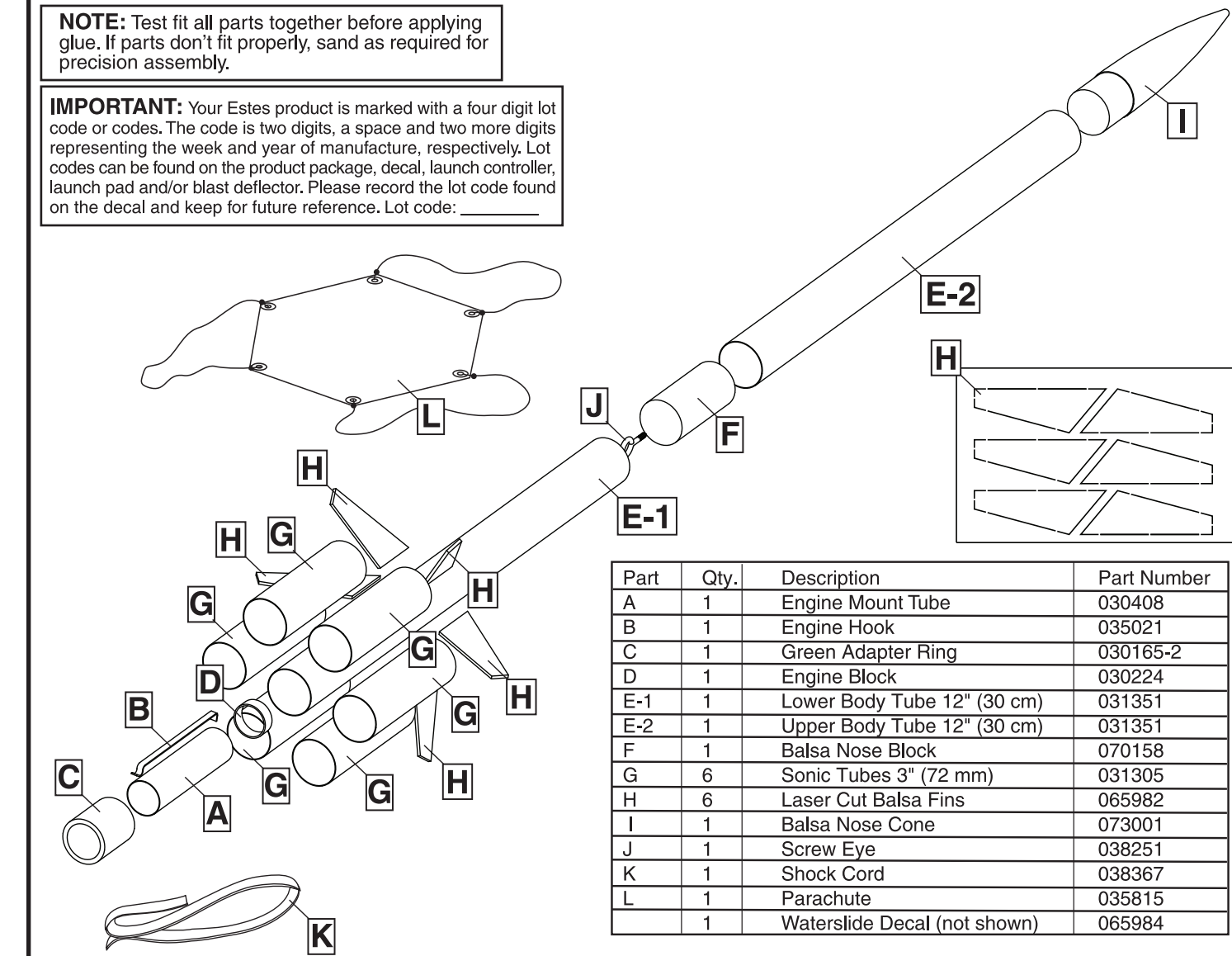

SUPPLIES

In addition to the parts included in the kit you will also need:

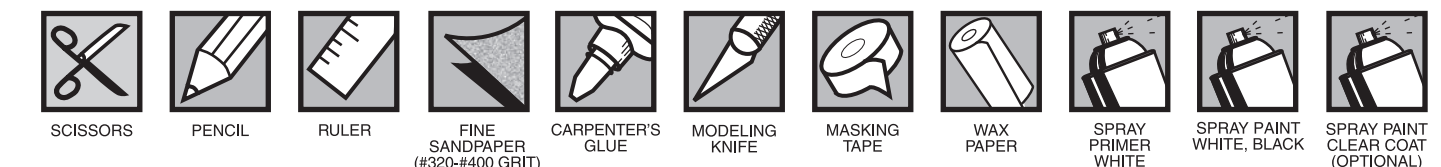

TUBE MARKING GUIDE

(Make a copy if you want to keep instructions.)

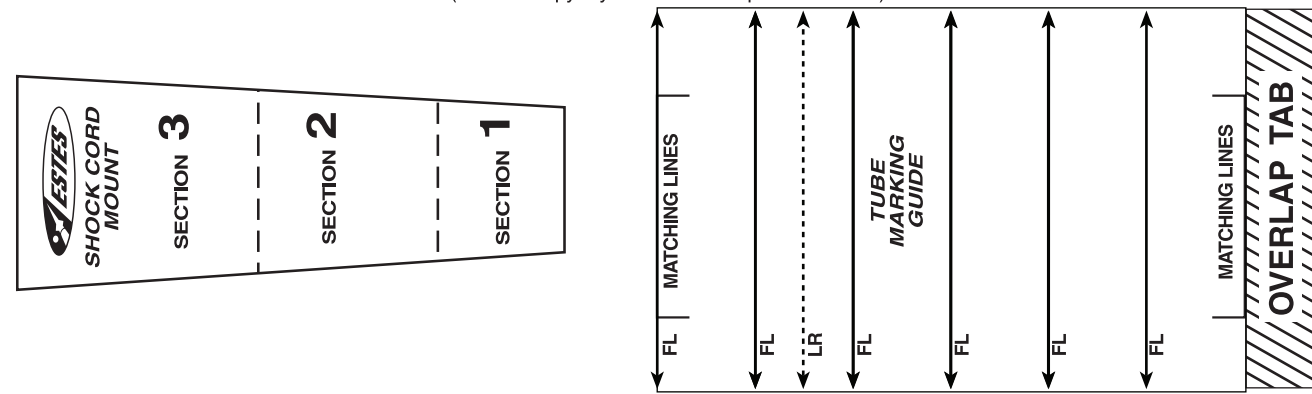

FIN PREPARATION

- Sand both sides of balsa sheet with fine sandpaper (#320 or #400 grit).
 - Remove **H** from sheet.
 - Stack all **H** together. Sand edges smooth.
 - Sand leading edge round. **DO NOT** round root edges.
-

ENGINE MOUNT ASSEMBLY

- Measure and mark **A**.
 - Cut small slit at mark.
 - Insert **B** in slit.
 - Slide **C** to mark. Apply ring of glue to both sides of **C**.
 - Apply ring of glue to inside of **A**. Insert **D** until it stops. Let dry.
-

TUBE MARKING

- Cut tube marking guide from instructions.
 - Tape guide on **E-1**. Mark fin lines **FL** and launch rod line **LR**.
 - Remove guide. Connect and extend all lines 6" (152 mm). Use door frame as a straight edge.
 - Measure and mark each **FL** where shown.
-

SONIC TUBE ASSEMBLY

NOTE: Make 3 sets of 2.

- Apply glue along one side of **G**.
 - Place next **G** along glue line. Let dry.
 - Repeat for other **G** assemblies.
-

SONIC TUBE ATTACHMENT

- Place wax paper on flat surface. Apply 3" (72 mm) long straight lines of glue to **FL** on both sides of **LR**.
 - Stand **E-1** on end. Position sonic tube assembly on glue lines with **LR** centered between the sonic tube assembly. Let dry.
 - Apply lines of glue along next two **FL**. Position next sonic tube assembly in place. Let dry.
 - Repeat for final sonic tube assembly. Let dry. Apply glue fillets between all sonic tubes. Let dry.
-

FIN ATTACHMENT

- Apply glue to root edge of **H**. Let dry 1 minute. Apply 2nd layer of glue.
 - Position **H** centered on **FL** forward of mark. Let dry.
 - Repeat for all **H**. Let dry.
-

UPPER BODY TUBE ASSEMBLY

- Measure and mark **F** at center.
 - Screw **J** centered into **F**.
 - Remove **J**. Place drop of glue in screw hole.
 - Screw **J** back in place. Let dry.
 - Check fit of **F** in **E-2**. Sand as required for easy insertion.
 - Apply glue around inside of **E-2**. Insert **F** to line. Wipe excess glue. Let dry.
-

ENGINE MOUNT INSTALLATION

NOTE: Fins removed from drawing for clarity.

- Apply ring of glue inside of **E-1**.
 - Align **B** with **LR** line.
 - Slide engine mount assembly in **E-1** until tube ends are even.
-

NOSE CONE ASSEMBLY

- Check fit of **I** in **E-2**.
 - Apply ring of glue inside of **E-2**.
 - Insert **I** in **E-2**. Wipe excess glue. Let dry.
-
- HELPFUL HINT: IF NOSE CONE FIT IS...**
 TOO LOOSE: ADD MASKING TAPE.
 TOO TIGHT: SAND FOR FIT.

SHOCK CORD INSTALLATION

- Cut shock cord mount from instructions.
 - Apply glue to section 2. Place **K** in glue. Fold forward.
 - Apply glue, fold forward.
 - Squeeze tight.
 - Apply glue to shock cord mount. Insert in body tube. Hold until glue sets. Let dry.
-

ROCKET FINISHING

NOTE: We have found Testors spray primers (Testors #2948 White Primer), Testors One Coat Lacquer spray paints, Testors Model Master spray paints and Testors Gloss Lacquer (#1961) to be excellent for providing a long lasting and durable finish on your rocket. Always be sure to spray your models outside or in a well ventilated area.

STEPS TO A QUALITY FINISH

- Insert shock cord into body tube and hold in place with paper.
 - Lightly sand body tube, fins and nose cone with fine sandpaper (#320 or #400 grit).
 - Apply glue fillets to fin tube joints.
 - Let dry overnight.
 - Use a stick inserted into the engine mount end of the rocket for painting.
 - Hold the upper body section by the screw eye for painting.
 - We recommend a good filler/primer to be applied to the balsa fins and nose cone before painting.
 - Apply 1-2 light coats of white primer to rocket body and nose cone, lightly sanding with fine sandpaper (#320 or #400 grit) between coats.
 - Allow to dry between coats.
 - Apply gloss white to lower rocket section.
 - Let paint dry overnight (24 hours is best).
 - Spray upper body section gloss black.
 - Let paint dry overnight (24 hours is best).
 - Apply waterslide decals where shown.
 - Cut decals to be applied from decal sheet, trimming close to the decal edge.
 - Place decal in bowl of warm water until decal begins to curl.
 - Remove decal, position in place and slide decal off of backing material and onto the model as close to final position as possible.
 - Gently blot out excess water with a clean paper towel.
 - Allow decals to set overnight before applying protective clear coat. This will provide added protection and shine to your Space Eagle™ rocket!
-