

RECOVERY SYSTEM ATTACHMENT

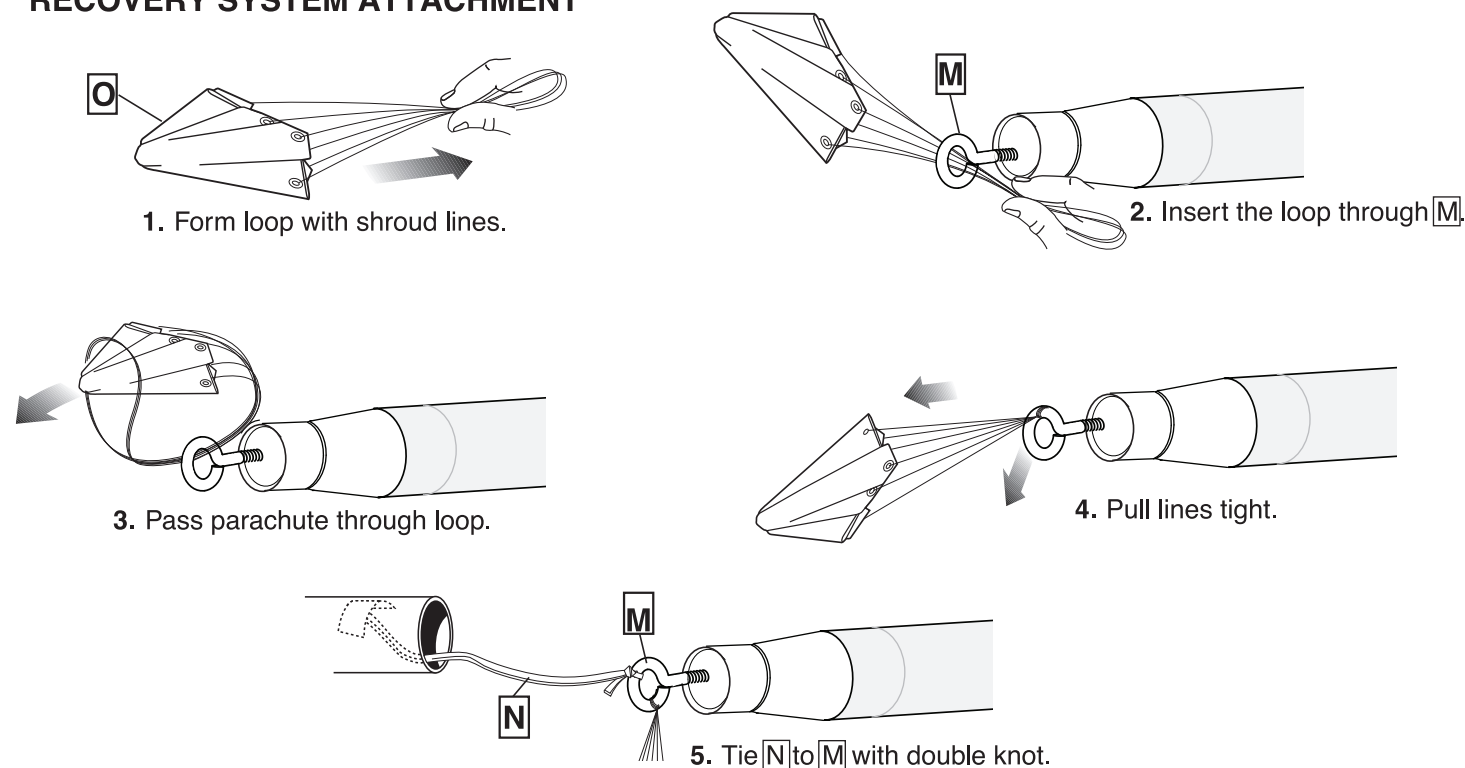

PREPARE FLIGHT RECOVERY

NOTE: Only Estes Recovery Wadding (302274) recommended.

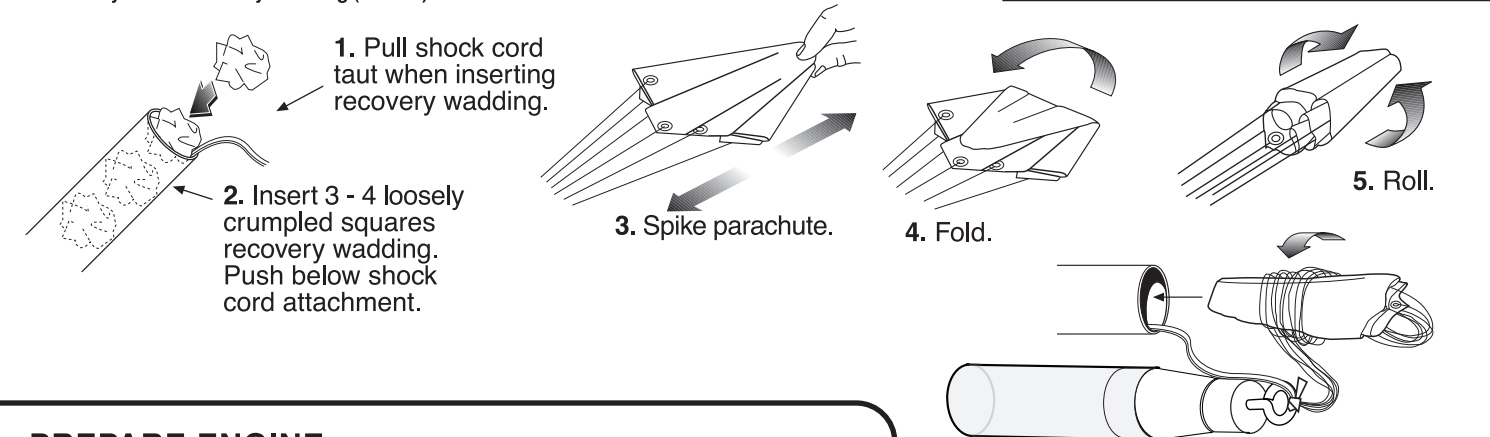

NOTE: Recovery wadding and streamer must slide easily into body tube. If too tight, redo.

PREPARE ENGINE

WARNING: FLAMMABLE

To avoid serious injury, read instructions & NAR Safety Code included with engines. **PREPARE ENGINE ONLY WHEN YOU ARE OUTSIDE AT THE LAUNCH SITE PREPARING TO LAUNCH!** If you do not use your prepared engine, remove the igniter before storing engine.

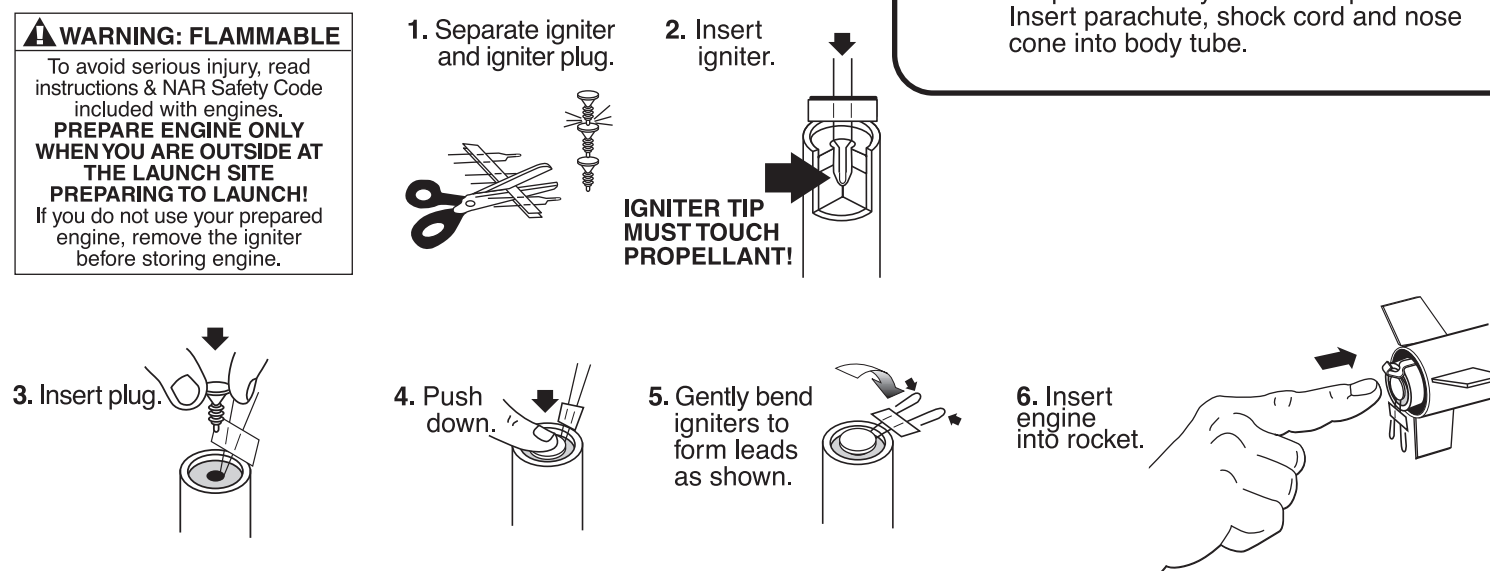

COUNTDOWN AND LAUNCH

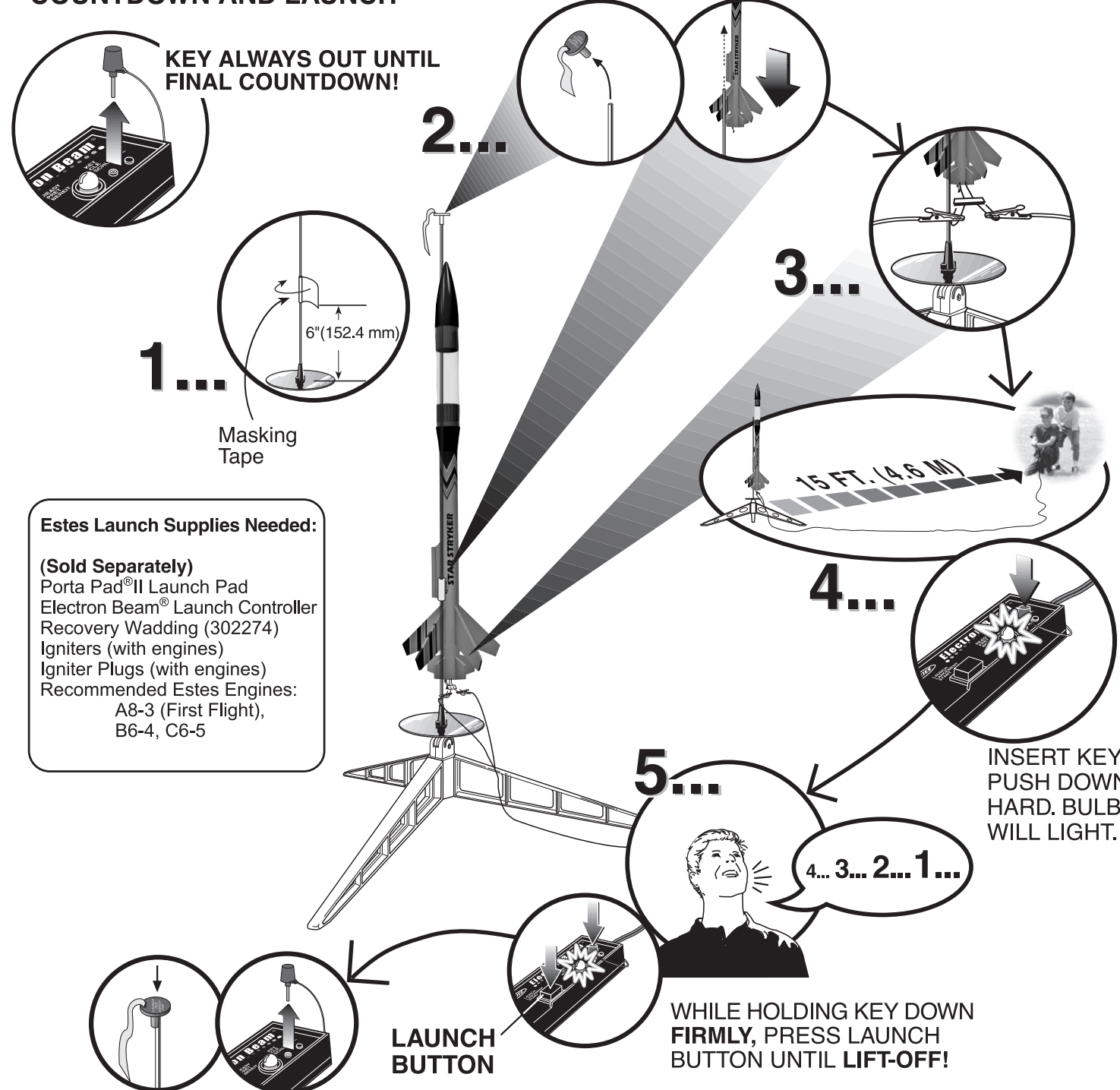

KEY ALWAYS OUT UNTIL FINAL COUNTDOWN!

1... Masking Tape

Estes Launch Supplies Needed:

(Sold Separately)
Porta Pad® II Launch Pad
Electron Beam® Launch Controller
Recovery Wadding (302274)
Igniters (with engines)
Igniter Plugs (with engines)
Recommended Estes Engines:
A8-3 (First Flight),
B6-4, C6-5

LAUNCH BUTTON

WHILE HOLDING KEY DOWN FIRMLY, PRESS LAUNCH BUTTON UNTIL LIFT-OFF!

PRECAUTIONS



NAR Safety Code



This paper can be recycled.



NO DRY GRASS OR WEEDS

PRE-LAUNCH CHECK

For safety, never launch a damaged rocket. Check the rocket's body, nose cone and fins. Also, check the engine mount, recovery system and launch lug. Repair any damage before launching the rocket.

FLYING YOUR ROCKET

Choose a large field (500 ft. [152 m] square) free of dry weeds and brown grass. The larger the launch area, the better your chance of recovering your rocket. Football fields and playgrounds are great. Launch only with little or no wind and good visibility.

Always follow the enclosed National Association of Rocketry (NAR) SAFETY CODE.

MISFIRES

TAKE THE KEY OUT OF THE CONTROLLER. WAIT ONE MINUTE BEFORE GOING NEAR THE ROCKET! Disconnect the igniter clips and remove the engine. Take the plug and igniter out of the engine. If the igniter has burned, it worked but did not ignite the engine because it was not touching the propellant inside the engine. Put a new igniter all the way inside the engine without bending it. Push the plug in place. Repeat the steps under Countdown and Launch.

ESTES STAR STRYKER™

Estes-Cox Corp.
1295 H Street, PO Box 227
Penrose, CO 81240-0227
Printed in China

FLYING MODEL ROCKET KIT INSTRUCTIONS

#7206

KEEP FOR FUTURE REFERENCE

ASSEMBLY TIP: Read all instructions before beginning work on your model. Make sure you have all parts and supplies.

www.estesrockets.com

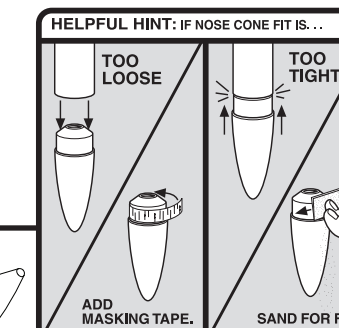

NOTE: Test fit all parts together before applying glue. If parts don't fit properly, sand as required for precision assembly.

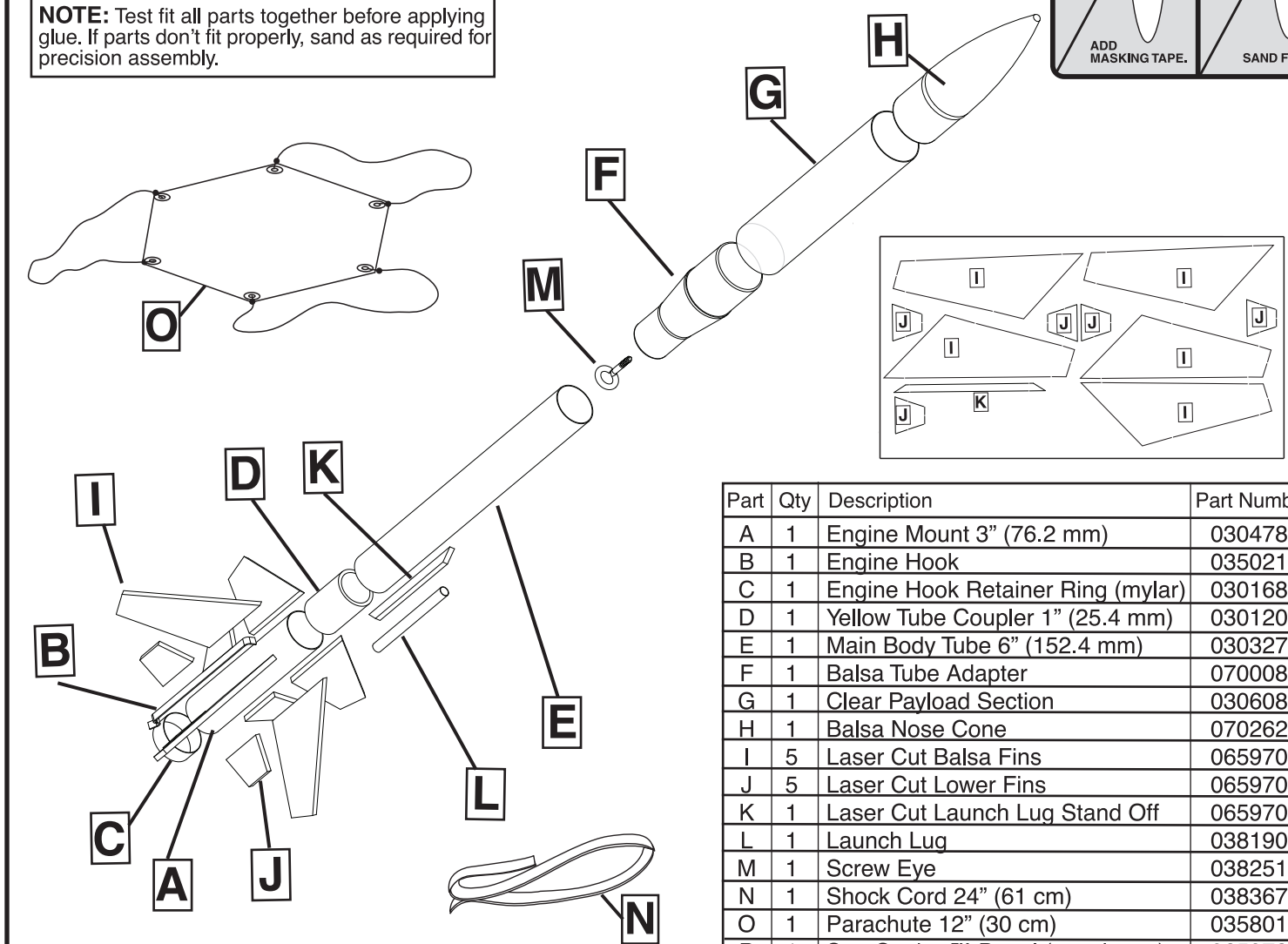

| Part | Qty | Description | Part Number |
|------|-----|-----------------------------------|-------------|
| A | 1 | Engine Mount 3" (76.2 mm) | 030478 |
| B | 1 | Engine Hook | 035021 |
| C | 1 | Engine Hook Retainer Ring (mylar) | 030168 |
| D | 1 | Yellow Tube Coupler 1" (25.4 mm) | 030120 |
| E | 1 | Main Body Tube 6" (152.4 mm) | 030327 |
| F | 1 | Balsa Tube Adapter | 070008 |
| G | 1 | Clear Payload Section | 030608 |
| H | 1 | Balsa Nose Cone | 070262 |
| I | 5 | Laser Cut Balsa Fins | 065970 |
| J | 5 | Laser Cut Lower Fins | 065970 |
| K | 1 | Laser Cut Launch Lug Stand Off | 065970 |
| L | 1 | Launch Lug | 038190 |
| M | 1 | Screw Eye | 038251 |
| N | 1 | Shock Cord 24" (61 cm) | 038367 |
| O | 1 | Parachute 12" (30 cm) | 035801 |
| P | 1 | Star Stryker™ Decal (not shown) | 065972 |

SUPPLIES

In addition to the parts included in the kit you will also need:

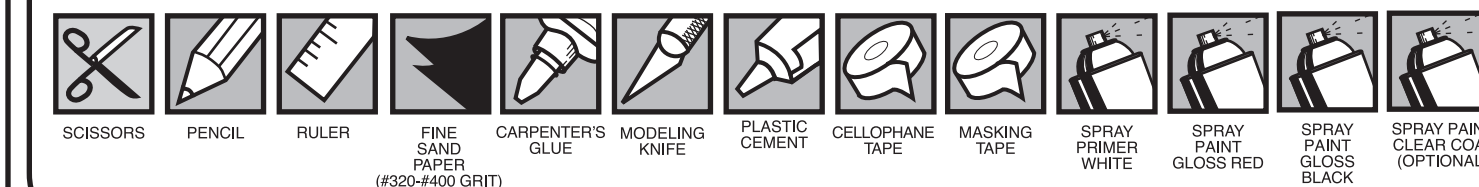

TUBE MARKING GUIDE AND SHOCK CORD MOUNT (Make a copy if you want to keep instructions.)

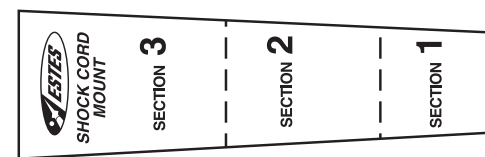
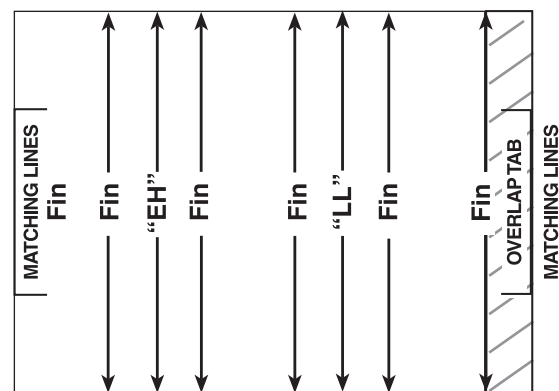

FIN PREPARATION

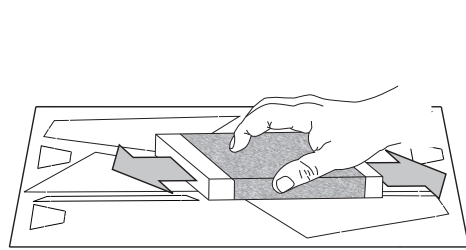

1. Sand both sides of balsa sheet with fine sandpaper (#320 or #400 grit).

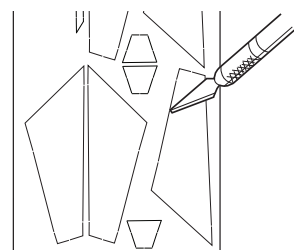

2. Cut I, J, and K from sheet.

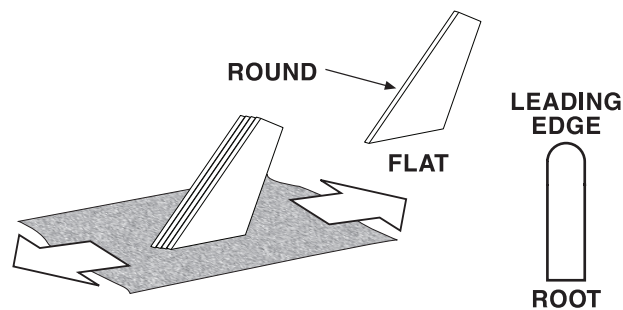

3. Stack like fins together. Sand edges smooth. Do not sand root edge round.

4. Sand leading edge round.

ENGINE MOUNT ASSEMBLY

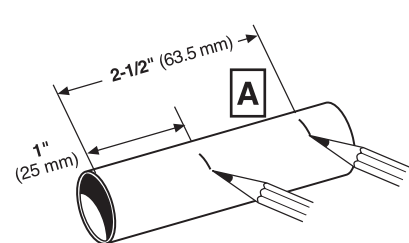

1. Measure and mark A.

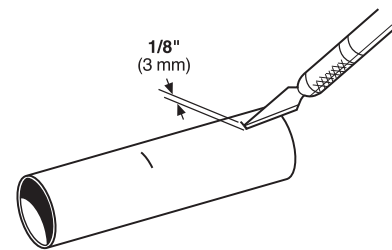

2. Cut slit at mark.

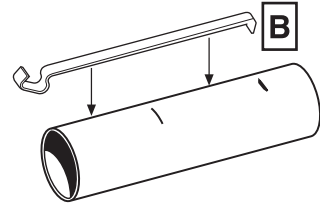

3. Insert B in slit.

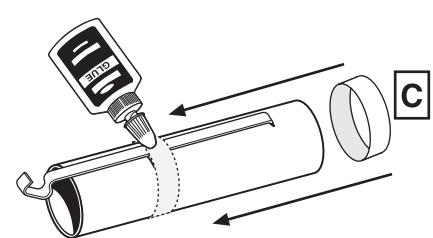

4. Apply ring of glue at mark. Slide C to mark.

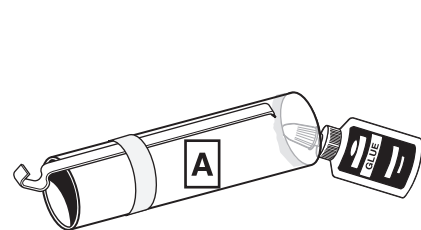

5. Apply glue in end of A.

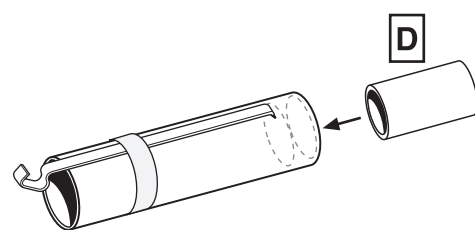

6. Insert D until it stops. Let dry.

LOWER BODY TUBE ATTACHMENT

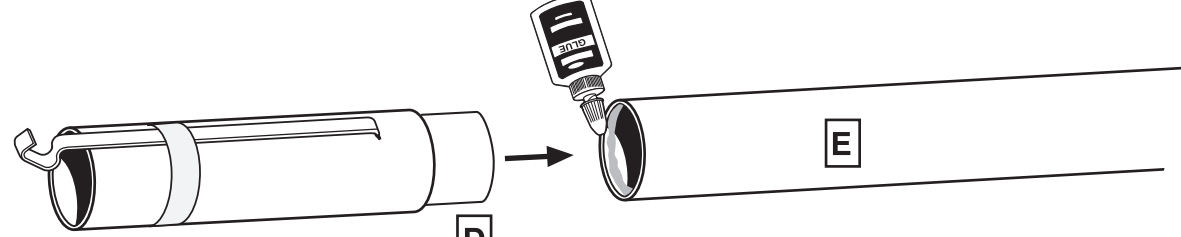

1. Apply glue inside of E.

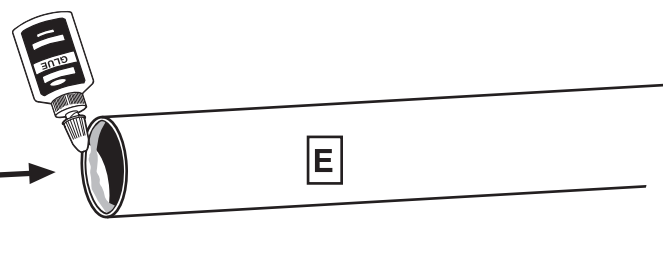

2. Slide D into E. Wipe excess glue. Let dry.

TUBE MARKING

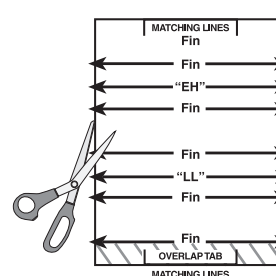

1. Cut tube marking guide from instructions.

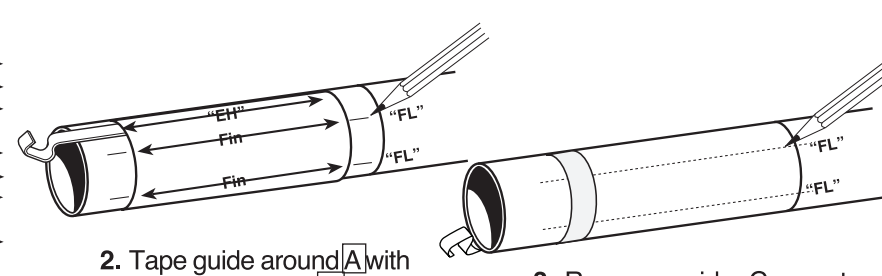

2. Tape guide around A with "EH" centered over B. Mark "FL" and "LL" at arrows.

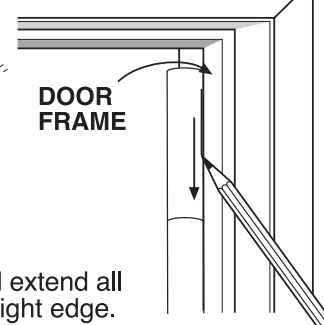

3. Remove guide. Connect and extend all lines. Use door frame as a straight edge.

FIN ATTACHMENT

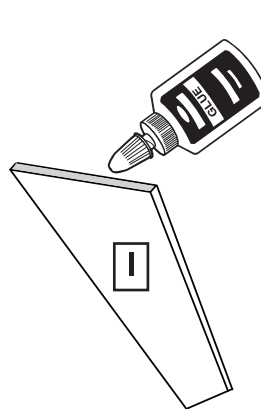

1. Apply glue to root end of I. Allow to dry 1 minute. Apply 2nd layer of glue.

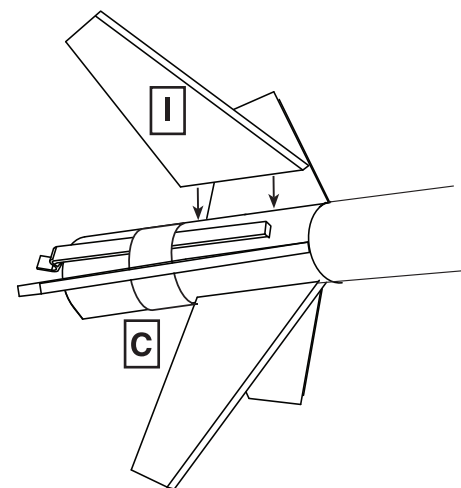

2. Attach I centered on fin line. NOTE: make sure fin is just forward of C.

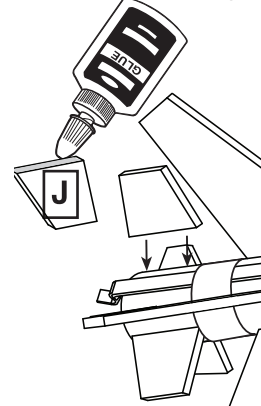

3. Apply glue to root edge of J. Allow to dry 1 minute. Apply 2nd layer of glue. Attach J centered on fin line even with end of A. Repeat for remaining J.

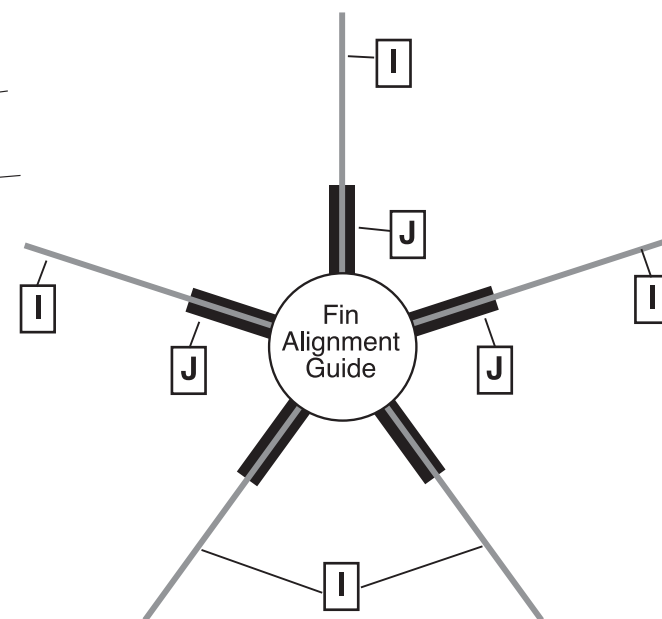

Use fin alignment guide for fin attachment accuracy. Let dry.

LAUNCH LUG ATTACHMENT

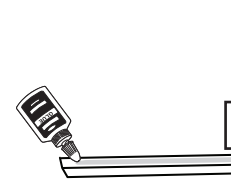

1. Apply glue to long edge of K.

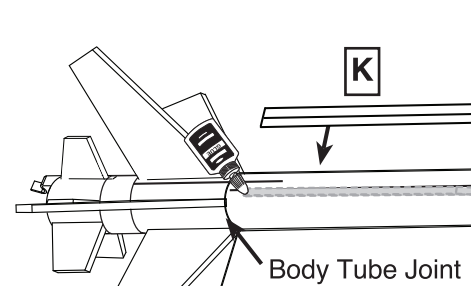

2. Position K over "LL" forward of body tube joint. Let dry.

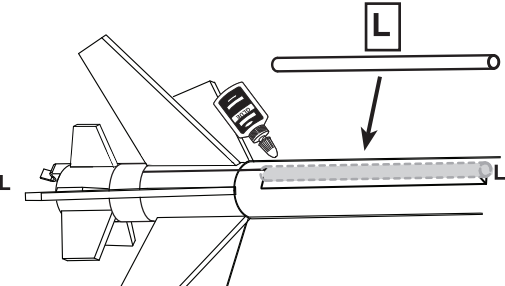

3. When dry, glue L centered on K.

PAYLOAD SECTION ASSEMBLY

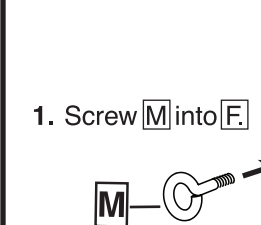

1. Screw M into F.

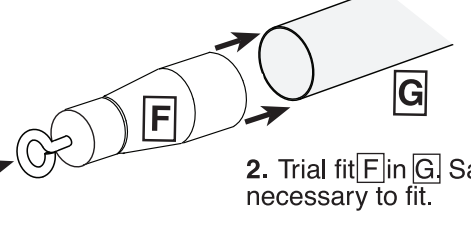

2. Trial fit F in G. Sand F if necessary to fit.

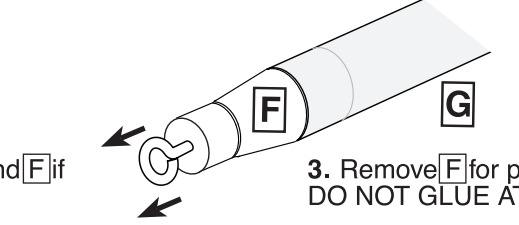

3. Remove F for painting. DO NOT GLUE AT THIS TIME.

NOSE CONE ASSEMBLY

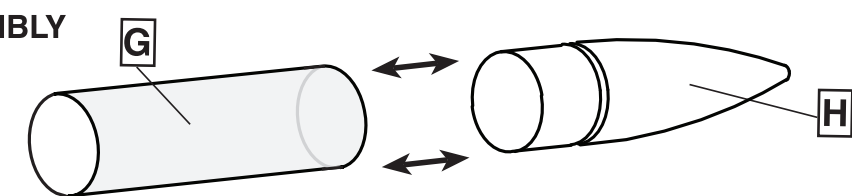

1. Check fit of H in G. Sand as necessary to fit. DO NOT GLUE IN PLACE.

2. Remove H for painting.

ROCKET FINISHING

NOTE: We have found Testors spray primers (Testors # 2948 White Primer), Testors One Coat Lacquer spray paints (color of your choice), Testors Model Master spray paints (color of your choice) and Testors Gloss Lacquer (#1961) to be excellent for providing a long lasting and durable finish on your rocket. Always be sure to spray your models outside or in a well ventilated area.

Steps for a Quality Finish:

- Stuff shock cord into body tube and hold in place with paper.
- Lightly sand main rocket section, tube adapter and nose cone with fine sandpaper (#320 or #400 grit).
- Apply glue fillets to fins and Launch lug.
 - Allow glue to dry overnight.
- Use a stick inserted into the engine tube end of the rocket for painting.
- Hold the payload section by the screw eye with a clip or pliers for painting.
- Insert small nail into base of nose cone and hold with clip or pliers for painting.
- We recommend a good filler/primer to be applied to the balsa fins, tube adapter and nose cone before painting.
 - Sand between applications for a smooth finish.
- Apply 1-2 light coats of white primer to rocket body and nose cone. Lightly sand with fine sandpaper (320 or 400 grit) between coats.
- Apply gloss red to main rocket section.
 - Let dry overnight (24 hours is best).
- Spray nose cone and tube adapter gloss black.
 - Let dry overnight (24 hours is best).
- Apply waterslide decals.
 - Cut the decal to be applied from the decal sheet, trimming close to the decal edge.
 - Hold the decal in warm water until decal begins to curl.
 - Remove the entire decal, position in place and slide the decal backing material from under the decal and onto the model as close to final position as possible.
 - Gently blot out excess water with a clean paper towel.
 - Allow decals to set overnight before applying protective clear coat.
- When decals are dry, spray entire rocket (main rocket section and nose cone) with a light coat of Testors Gloss Lacquer (#1961). This will provide added protection and shine to your Star Stryker™ rocket!
- Apply cement to inside of (G).
- Insert (F) into (G). Let dry.
- Attach nose cone to (G) with small piece of clear tape.



INSTALL SHOCK CORD MOUNT

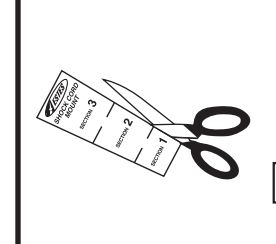

1. Cut shock cord mount from instructions.

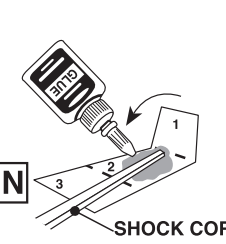

2. Apply glue to mount. Place shock cord N on Section 2. Fold forward.

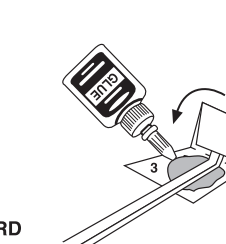

3. Apply glue and fold forward.

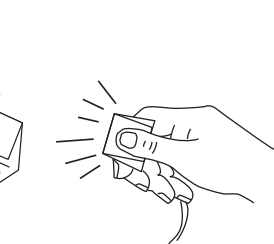

4. Squeeze tight!

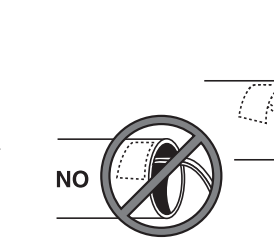

5. Apply glue to shock cord mount and insert in body tube. Hold until glue sets. Let dry.