





CITATION MK 5

BOEING IM-99A BOMARC



General Information

The BOMARC is a United States Air Force missile used for defense ground to air against manned bombers. Driven by a 30,000 lb. thrust rocket engine and two ramjet engines of over 50,000 horsepower in the nacelles, the 15,000 lb. BOMARC reaches over twice the speed of sound at up to 60,000 feet of altitude.

The first fully operational production unit of the missile was "rolled out" on December 30, 1957. The first prototype had been fired in September 1952.

BOMARC utilizes extensive electronic control for a fully automatic intercept. Alert to launch takes less than two minutes.

Like the actual missile, your 1/24 scale BOMARC blasts vertically into the sky and then transitions to flying as a winged vehicle.

The BOMARC'S glide has a relatively high sink rate, giving about 25 seconds with a B-2 and one minute with a C-3 engine.

This scale model features thermoformed plastic parts for the most accurate reproduction of the contours of the original "bird". Die-cut and pre-formed balsa complete the picture for a fast-building beautiful model.

RECOMMENDED ENGINES

For first flight and small fields use a B-2. When you have unlimited space and visibility, a C-3 will give spectacular results.

START

Tools & Materials Required

Sharp knife or razor blade
 Sand paper - fine and extra fine
 Sanding sealer
 Flat white, flat black, silver paints
 "White" glue and Plastic cement
 Ruler and masking tape
 CITATION "Star Port" launch system

PRE - ASSEMBLY INSTRUCTIONS

- 1 Trim the thermoformed parts on marked lines.
- 2 Carefully separate balsa parts from sheet.
- 3 Mark body tube with marking guide as shown.
- 4 Mark a straight line down each nacelle tube.
- 5 Glue means white glue, cement means plastic cement.

- 1** CEMENT THE NOSE CONE LINER INTO THE TUBE.
 CLOSED END FORWARD

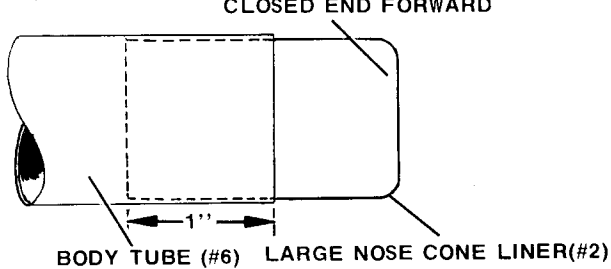

- 2** GLUE WING PARTS TOGETHER. GLUE TO BODY. ALIGN CAREFULLY WITH TOP LINE.

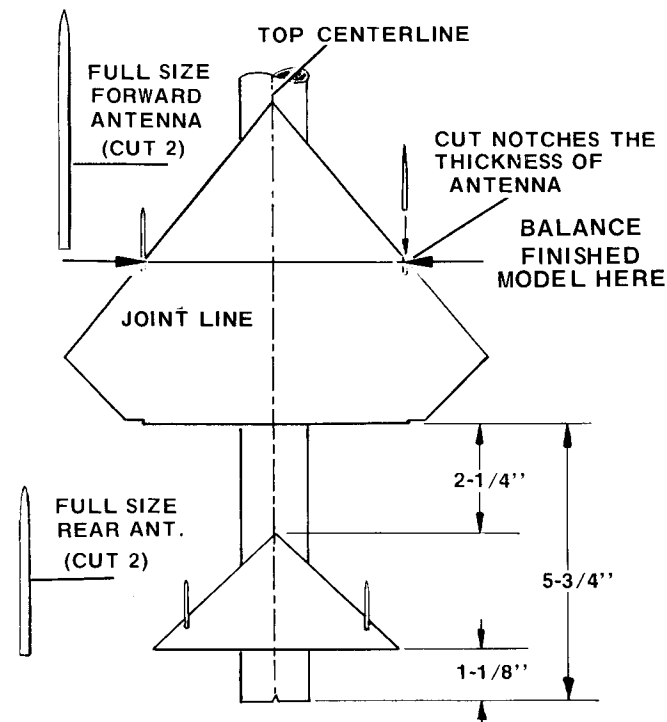

- 3** GLUE STABILIZER ON. ALIGN CAREFULLY WITH TOP LINE, THEN LAY MODEL UPSIDE DOWN ON A FLAT TABLE TO DRY.

- 4** CUT AN 1/8" NOTCH IN TUBE TAIL ON TOP LINE.

Assemble parachute (leave 3" of shroud line for elev hold down) and tape to center of pod.

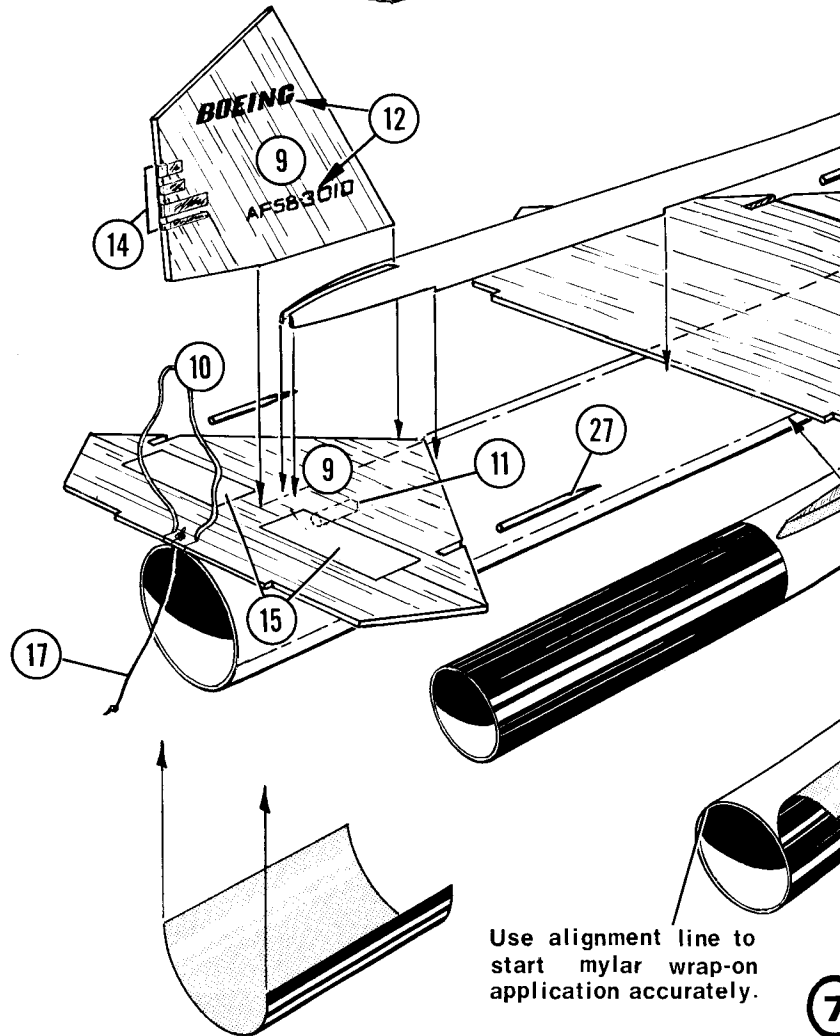
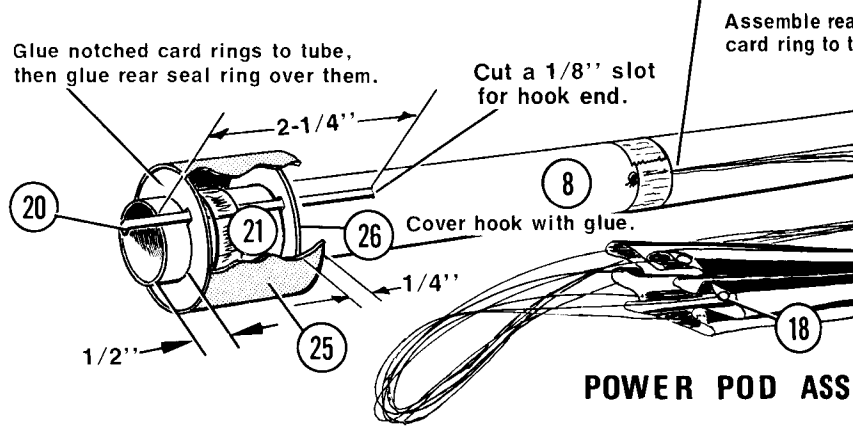

- 5** CEMENT NACELLE CONE TO LINER THEN INTO TUBE.

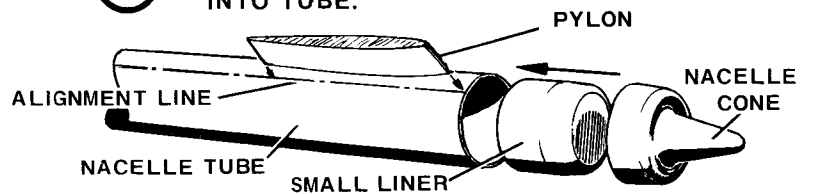

- 6** GLUE SHAPED PYLON TO NACELLE FLUSH WITH TUBE END. REPEAT FOR OTHER NACELLE.

r elevator

Smear inside of tube front with glue. Quickly slide retainers and discs in tube to positions shown.

Slide rear of pod first, then glue hinge to tube and add seal ring.

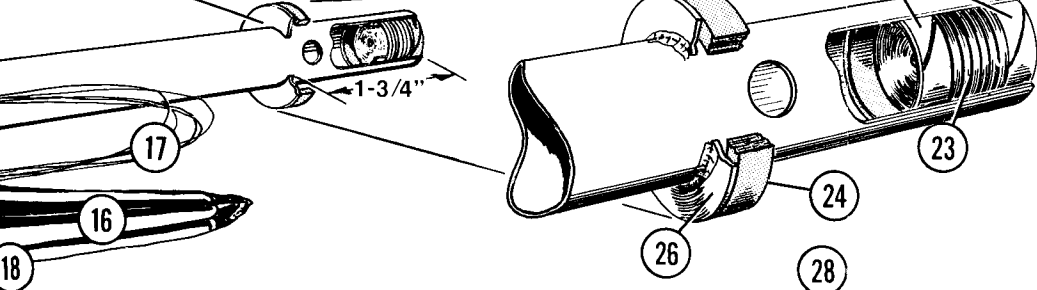

ASSEMBLY

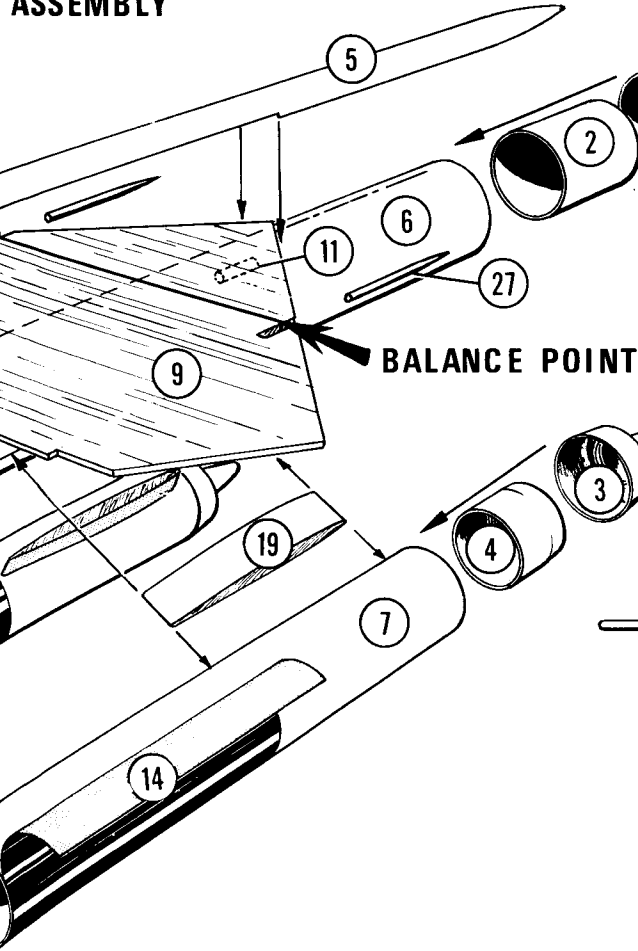

MARKING THE BODY TUBE

8 CEMENT RACEWAY TO THE WING, TAIL, FUSELAGE.

9 GLUE THE NACELLES ON LOWER LINES. PYLON LEADING EDGE IS 10" FROM THE REAR OF THE BODY TUBE.

PART # PART NAME

- 1 1- Nose Cone
- 2 1- Large Liner
- 3 2- Nacelle Cones
- 4 2- Small Liners
- 5 1- Raceway
- 6 1- Body Tube
- 7 2- Nacelle Tubes
- 8 1- Pod Tube, Punched
- 9 1- Die Cut Balsa
- 10 1- Elastic Thread
- 11 2- Launch Lugs
- 12 1- Decal
- 13 1- Vinyl Tape
- 14 1- Die-Cut Metal Mylar
- 15 1- Hinge Material
- 16 1- Parachute
- 17 1- Shroud Line
- 18 1- Tape Disc
- 19 2- Pylons
- 20 1- Engine Hook
- 21 1- Mylar Hook Retainer
- 22 2- Ballast Retainers
- 23 6- Ballast Discs
- 24 1- Front Seal Ring
- 25 1- Rear Seal Ring
- 26 1- Card Die-Cut
- 27 4- Antennas
- 28 1- Modeling Clay

KIT ALSO INCLUDES (2) SAFETY CERTIFIED ENGINES, ENGINE IGNITERS, IGNITER TAPE DISCS AND ESTES COUNTDOWN CHECK-LIST CARD. NOTE: NO RECOVERY WADDING IS REQUIRED FOR THE BOMARC.

REAR VIEW

10 GLUE LAUNCH LUGS UNDER WING LEADING EDGE AND STAB TRAILING EDGE.

7 GLUE VERTICAL TAIL ON TOP OF HORIZONTAL STABILIZER. CHECK THE ALIGNMENT BY SIGHTING FROM THE FRONT OF THE MODEL.

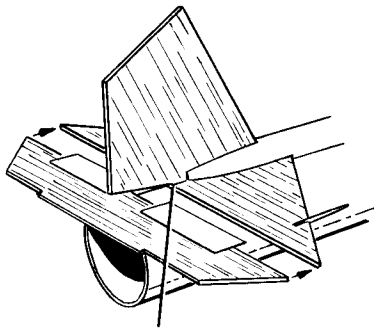

NOTE POSITION OF VERTICAL TAIL.

Final Assembly - Painting

Sand and seal all balsa parts. Paint the entire model except main nose cone flat white. Hinge the elevator to the stabilizer. The hinge material goes on top of the surfaces. Paint the model as shown in photographs. Assemble Pod. Cut 3" off the shroud line hank. Tie a double knot in one end. Slide pod into rocket with the knot end of the string held in by the rear spacer. Hold the elevator full down and glue the string tight into the center of the elevator to act as a hold-down during boost. Stretch elastic thread around the front of the vertical tail and glue into the elevator trailing edge. Balance the model at the root of the wing antennas by pressing modeling clay into the point of the nose cone (inside). Cement the cone onto the liner. Decorate the model with the tape, decals, and metallized mylar provided, as shown in the photographs.

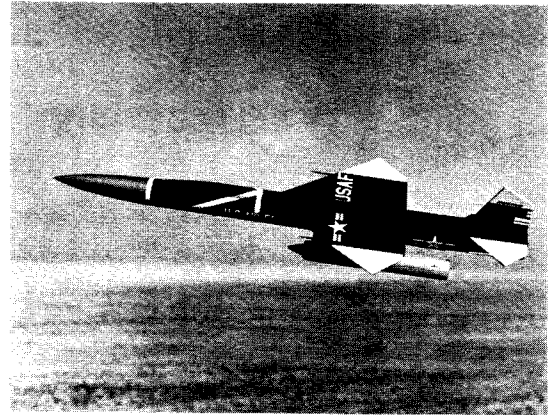
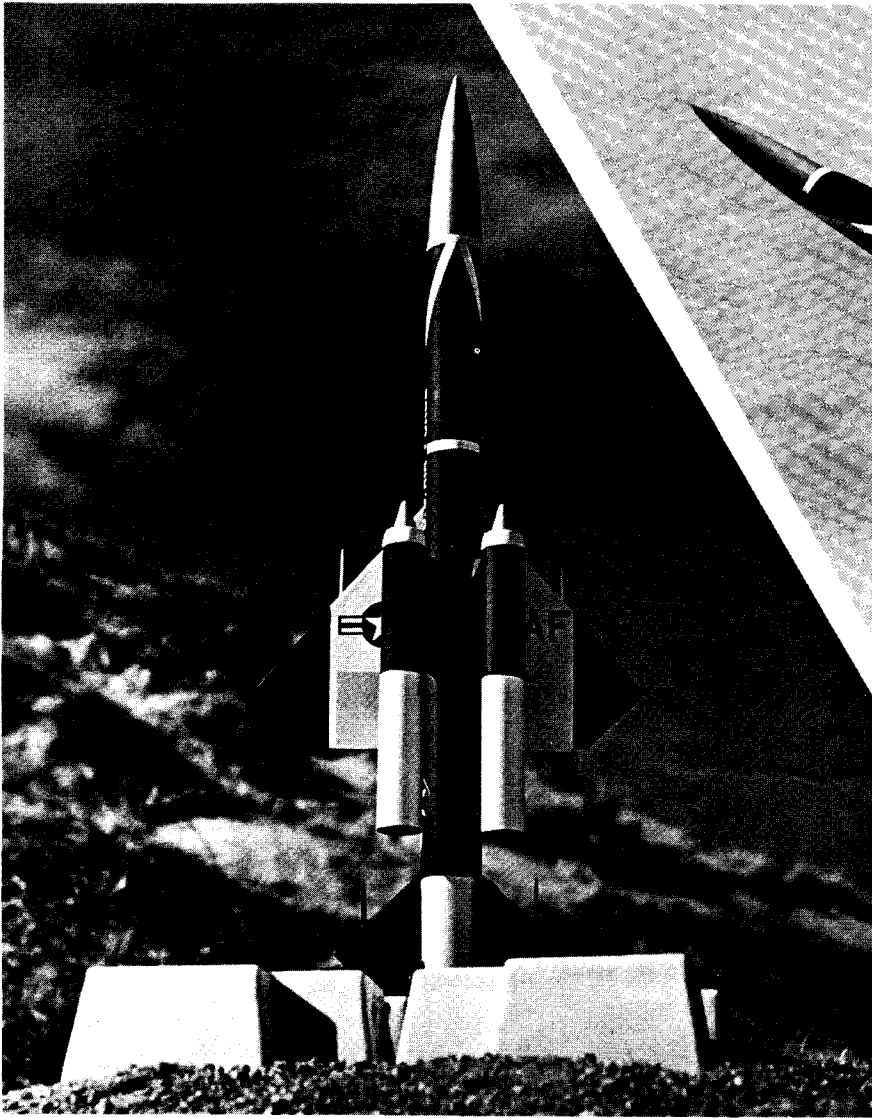

Flight Preparation & Trim

Slip the pod into the model with the parachute wrapped loosely around the rear of the pod. Be absolutely sure that the hold down string pulls the elevator full down against the body tube. Recheck this when model is on launch pad. Install an igniter into an engine and the engine into the pod. NOTE: No ejection wadding is required.

Carefully following the countdown procedure, launch your BOMARC.

Observe the glide

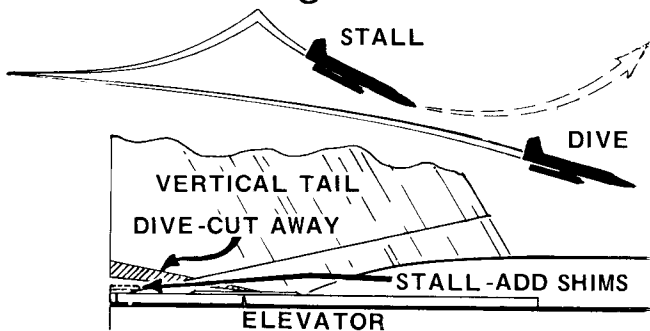

If the model stalls, glue thin shims to the elevator where it hits the vertical tail to reduce the angle of pop-up.

If the model dives, open up the cut out in the vertical tail slightly to allow the elevator more movement.

If the model turns too tightly, check the vertical tail for warps or misalignment. A slight turn is desirable to keep the model in the flying area.

After Completing Your Model, Fill In This Coupon And Return It To Estes Industries, Dept. 209 And We Will Send You A Certificate For Your Wall.

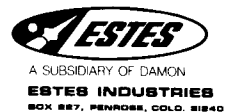

I Flew My **BOMARC** On (Date) _____

Name _____

Address _____

City _____ State _____ Zip _____

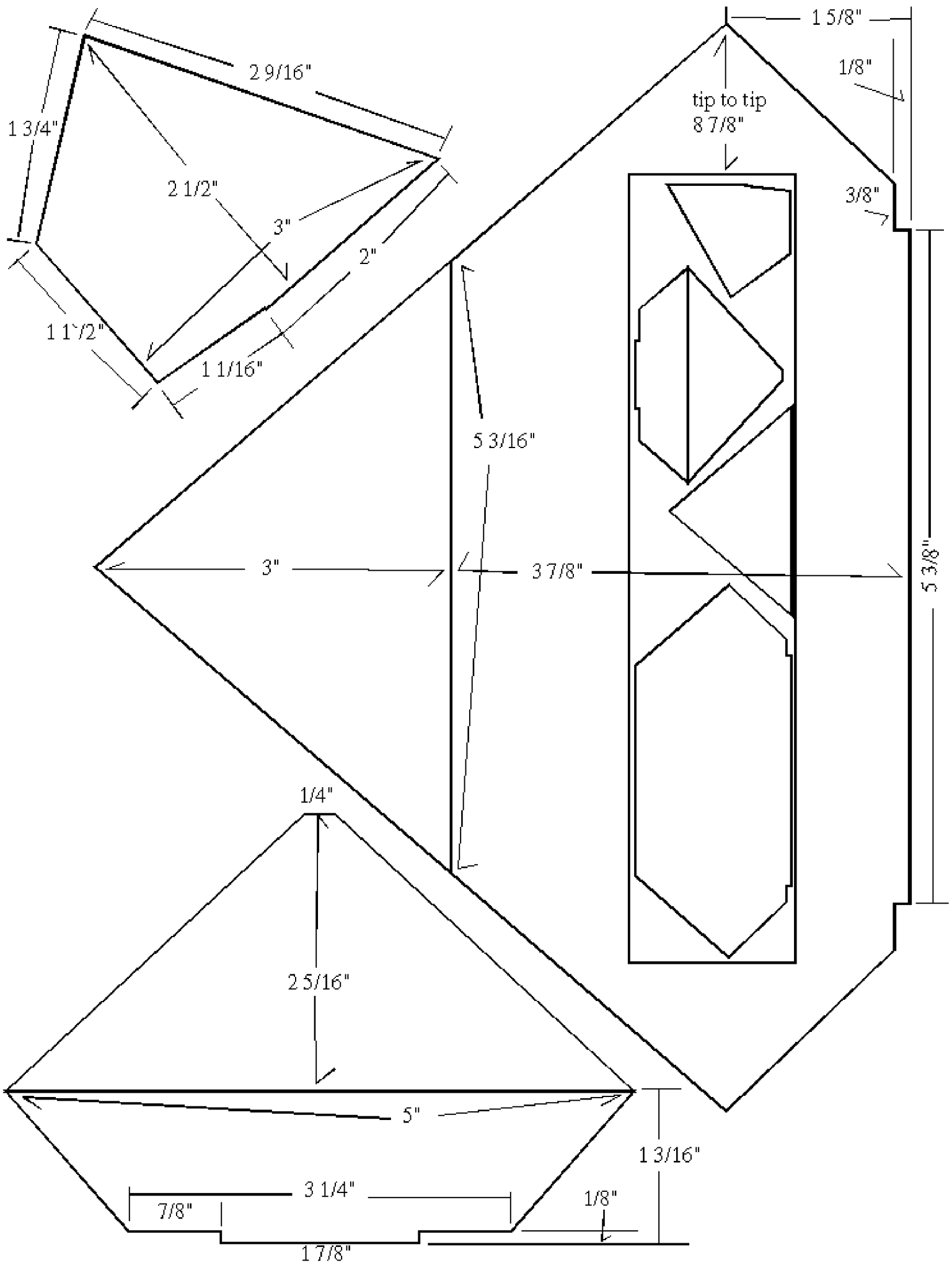

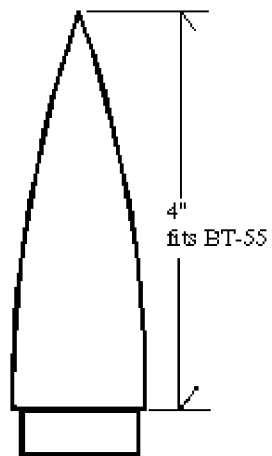
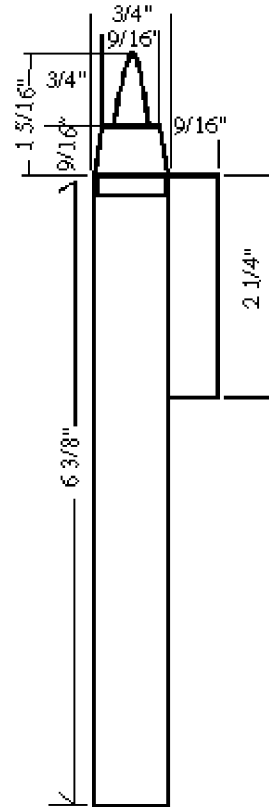
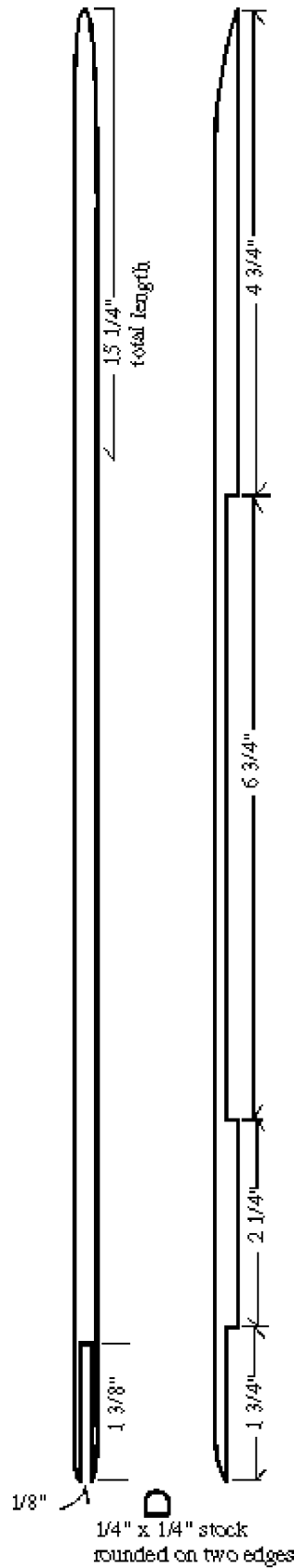
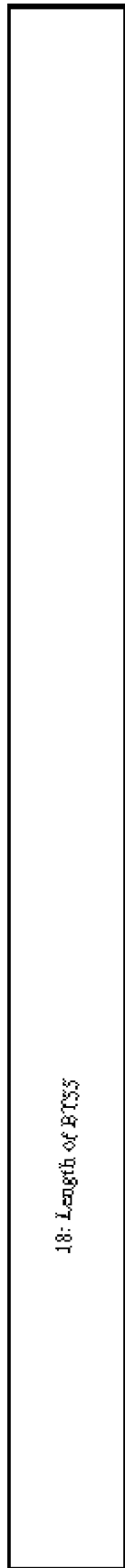
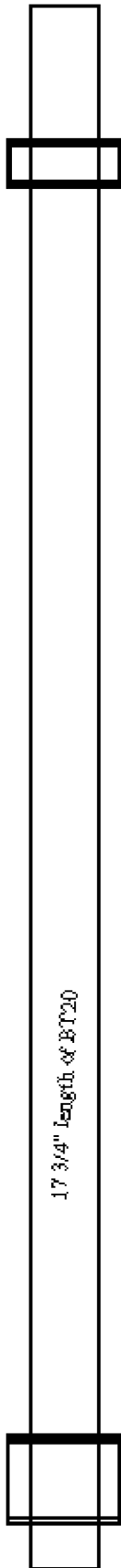

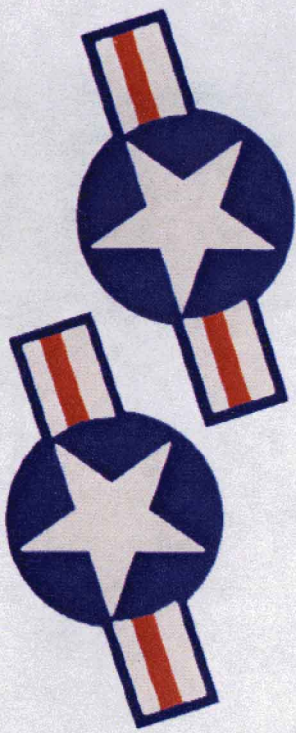

BOMARC

← 1 inch →

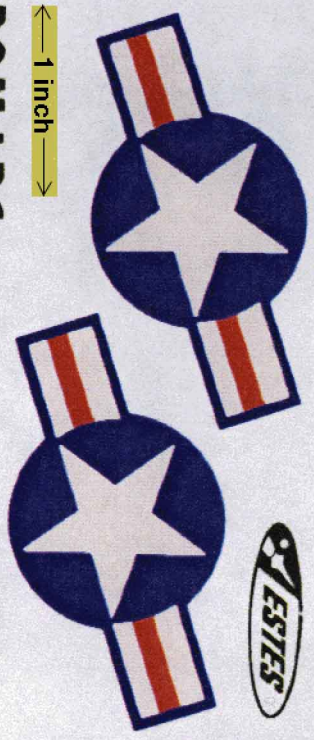

U.S. AIR FORCE

U.S. AIR FORCE

USAF

USAF

BOEING
BOEING

PN 37209

CAF



446

CAF



446



60446



60446



1:24 Scale CAF
Boeing MiM-10B Bomarc