





estesrockets.com

# GREEN EGGS™

1718



## MODEL ROCKET INSTRUCTIONS

### KEEP FOR FUTURE REFERENCE

**IMPORTANT:** Please record date found on decal and keep for future reference. \_\_\_\_\_

**READ ALL INSTRUCTIONS.** Make sure you have all parts and supplies. Test fit all parts before applying glue. Sand as necessary for precision assembly. Product color and shape may vary.

### SUPPLIES



SCISSORS



PENCIL



RULER



FINE SANDPAPER



CARPENTER'S GLUE



HOBBY KNIFE



MASKING TAPE



CLEAR TAPE



PRIMER (WHITE)



CLEAR COAT (OPTIONAL)



PAINT (GREEN, WHITE)

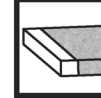

SAND BLOCK

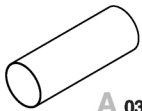

**A 030362**  
Engine mount tube

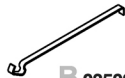

**B 035021**  
Engine hook



**C 030164-2**  
Green engine block



**D 030480**  
Black engine hook retainer ring

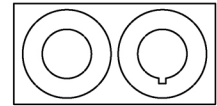

**E 090052-1718**  
Laser cut centering rings



**090001-1718**  
Self-stick decal

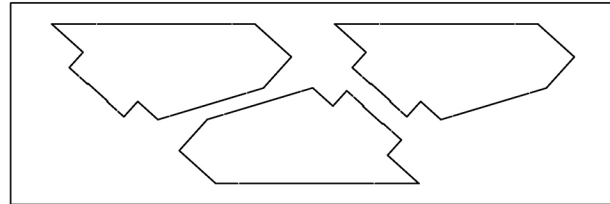

**G 090051-1718**  
Laser cut wood sheet

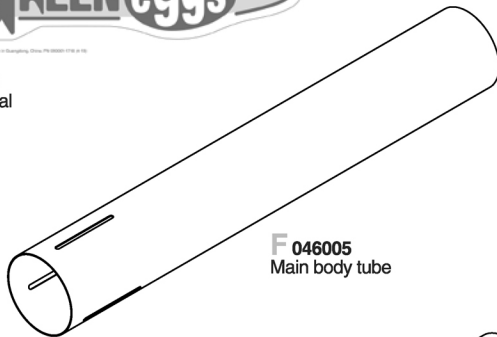

**F 046005**  
Main body tube

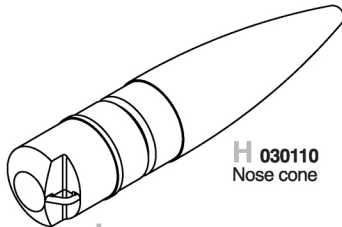

**H 030110**  
Nose cone

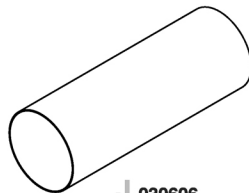

**J 030606**  
Clear payload section



**K 038166**  
Launch lug

**I 030110**  
Adapter

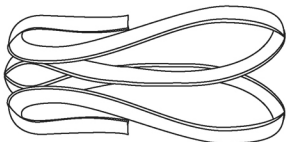

**L 038363**  
Shock cord

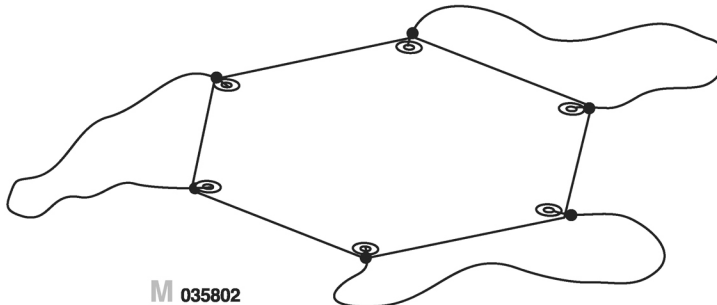

**M 035802**  
Parachute

### SHOCK CORD MOUNT

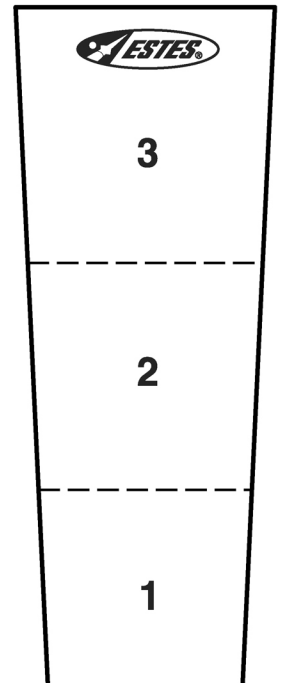

Make a copy if you want to keep instructions.

## PREPARE FINS

1. Sand both sides.

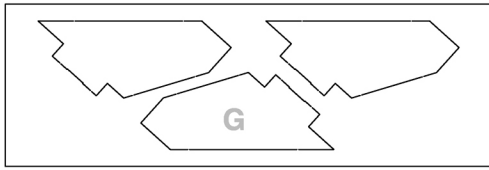
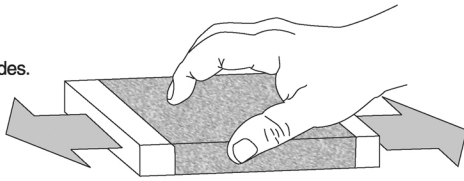

2. Use hobby knife to gently remove fins.

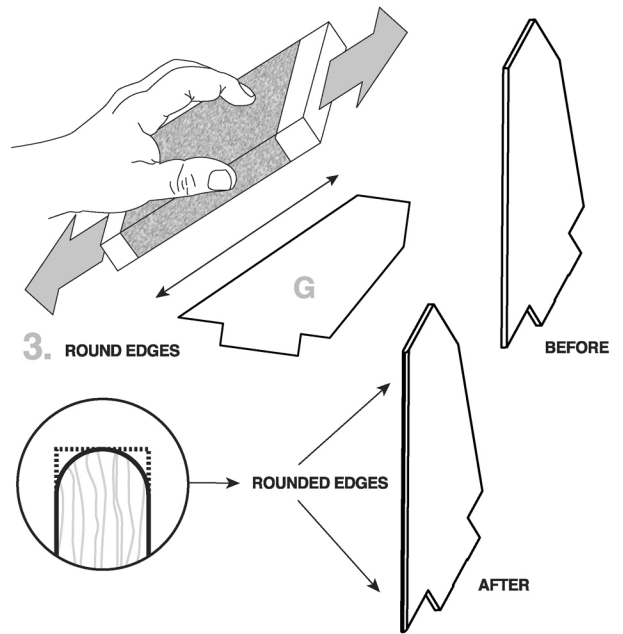
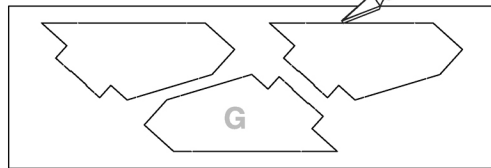

## MARK BODY TUBE

1. Make a mark in the middle of any two fin slots.

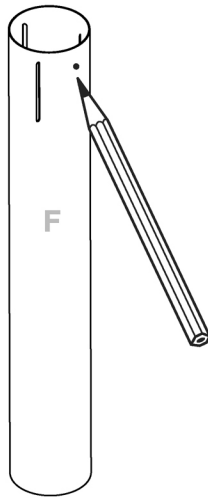

2. Use a door frame to extend mark into line.

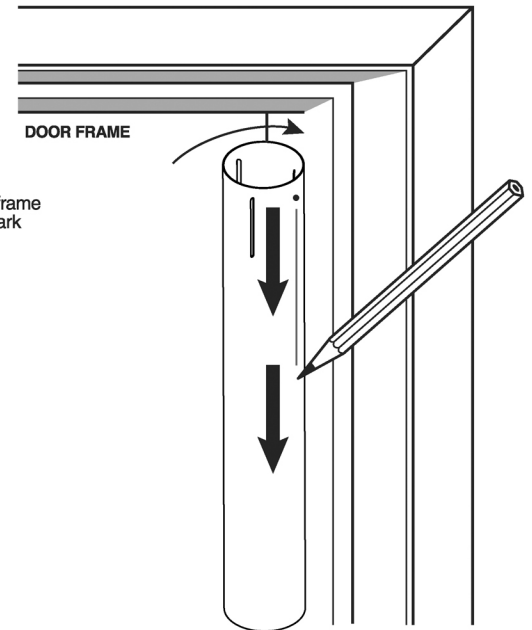

## ASSEMBLE ENGINE MOUNT

1. Use hobby knife to remove centering rings.

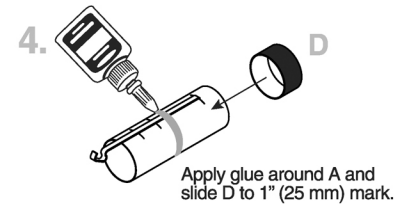
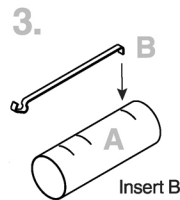
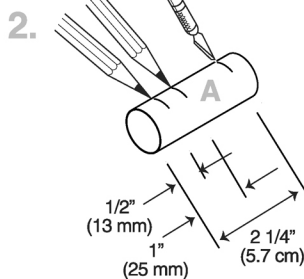
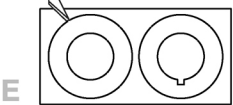

Apply glue around A and slide D to 1" (25 mm) mark.

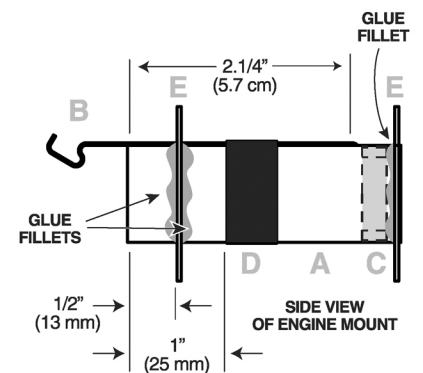
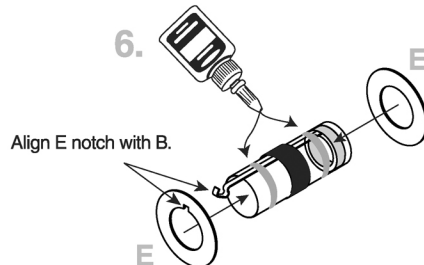
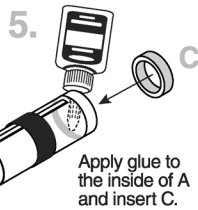

# INSERT ENGINE MOUNT AND ATTACH FINS

1. Apply glue inside F.  
Insert the engine mount.

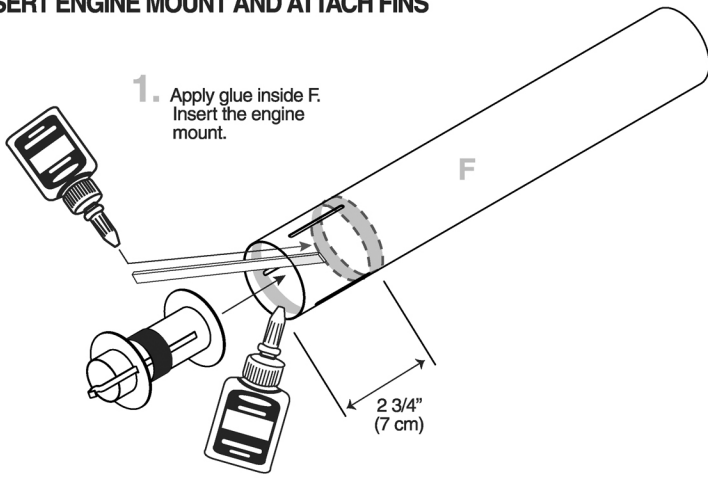

2.

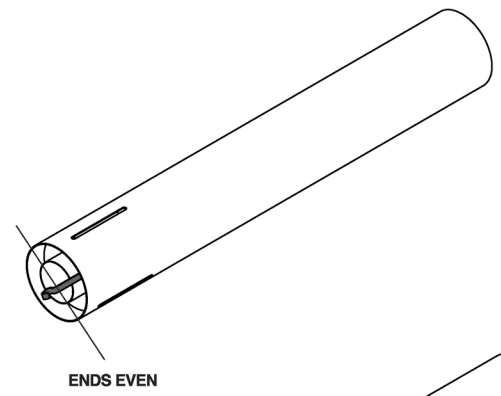

3.

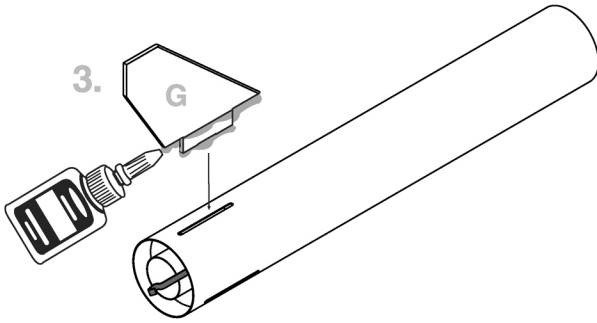

4.

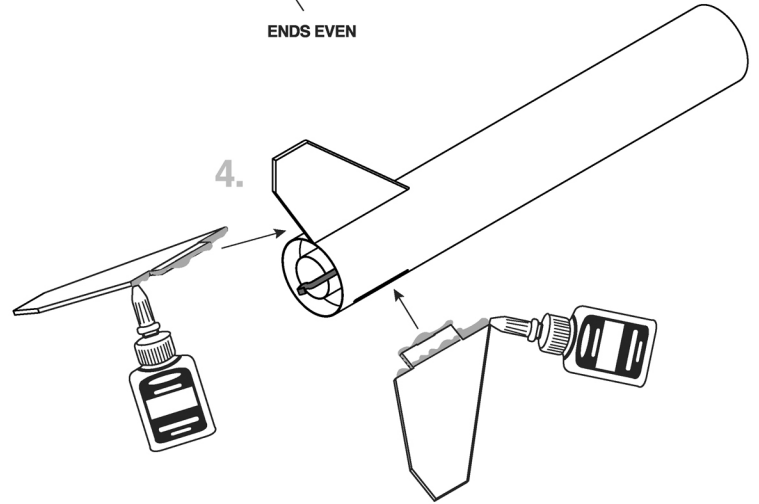

5. Check alignment using  
alignment guide below.

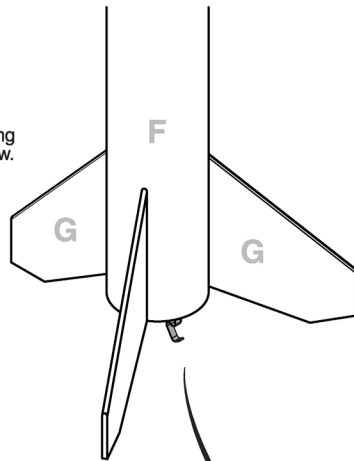

6. Let dry.

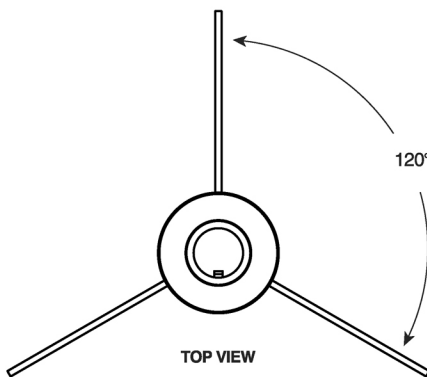
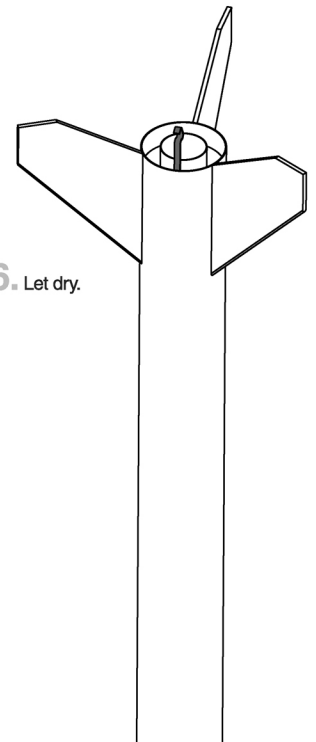

ALIGNMENT GUIDE



## ATTACH LAUNCH LUG

1. Apply glue to F. Attach K as shown.

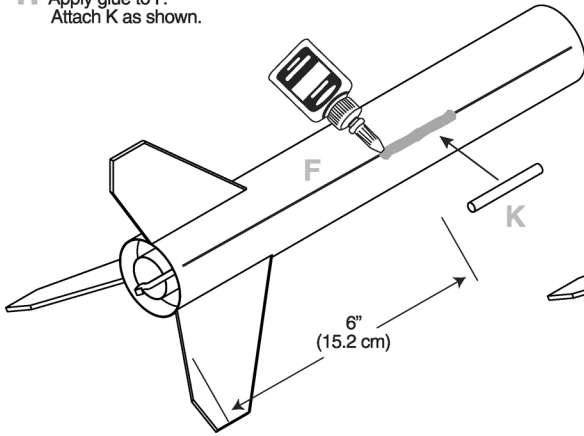

2. Apply glue fillets to both sides of all joints.

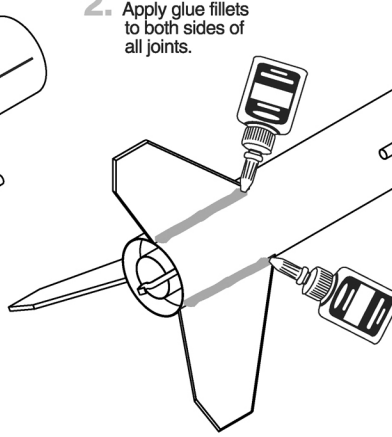

3. Smooth glue fillets with finger. Let dry.

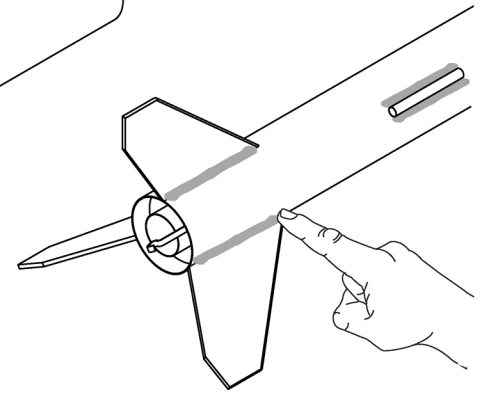

## INSTALL SHOCK CORD

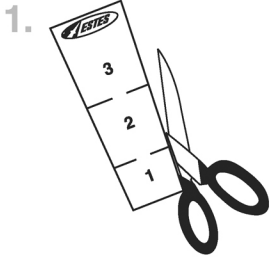

**NOTE:**  
Cut from page 1.

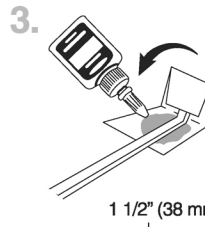
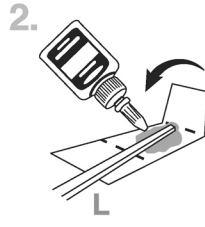

4. Hold until set.

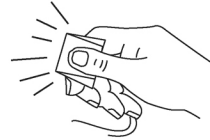

5. Apply glue to shock cord mount.



6. Glue shock cord mount to the inside of E.

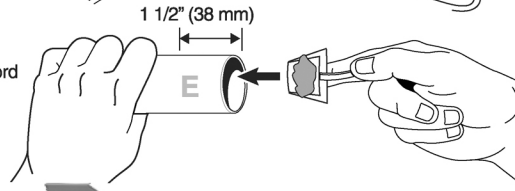

7. 1 1/2" (38 mm)

Use finger to hold until glue sets.

## ROCKET FINISHING

1. Spray rocket with white primer, let dry, and sand. Repeat until rocket is smooth, then paint.

2. Apply self-stick decal.

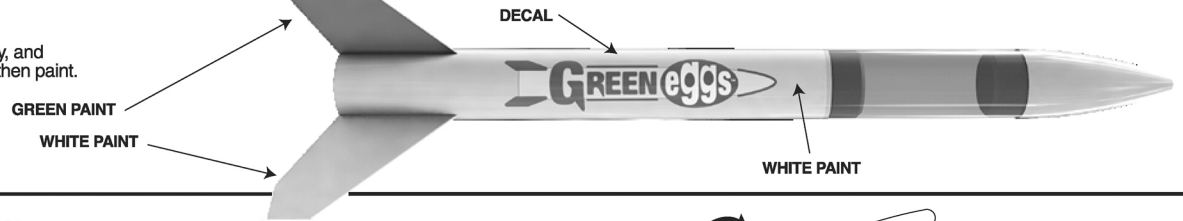

## ASSEMBLE PAYLOAD SECTION

1. Use hobby knife to cut nose cone into 2 sections.

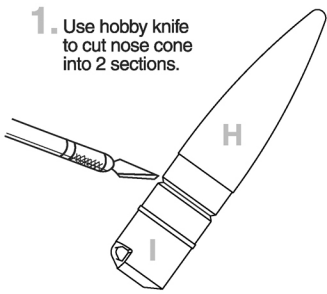

2. Use hobby knife to remove excess plastic from eyelet piece.

**NOTE:**  
Do not cut off eyelet.



- 3.

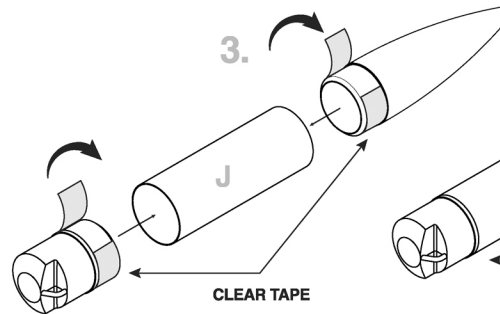

- 4.

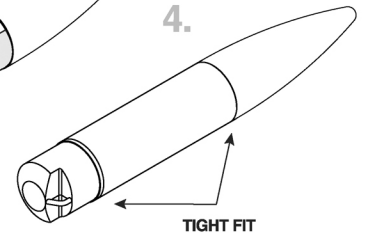

## ATTACH PARACHUTE

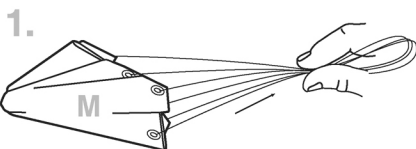

- 2.

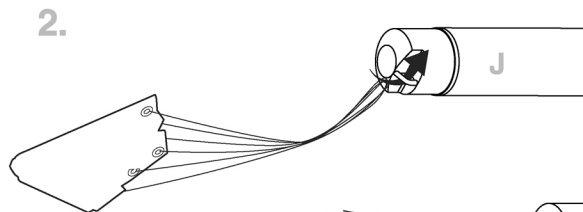

- 3.

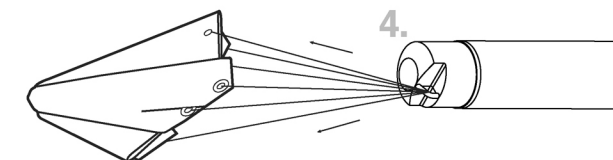
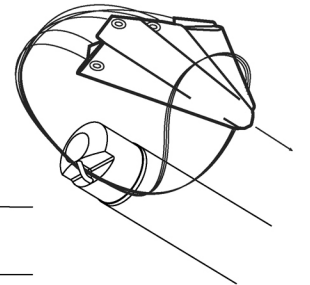

- 5.

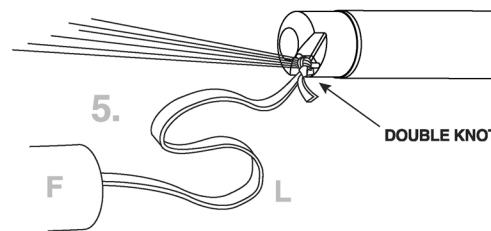

## PREPARE RECOVERY SYSTEM

1. Push recovery wadding down towards end of body tube.

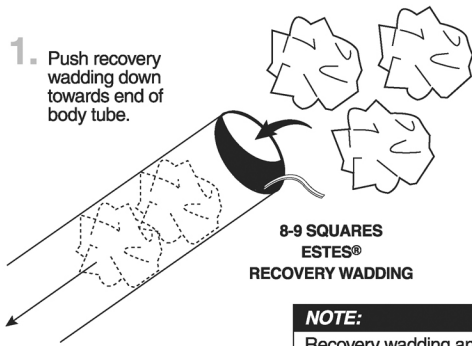

2.

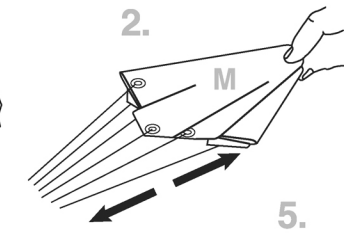

3.

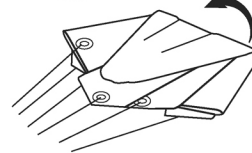

4.

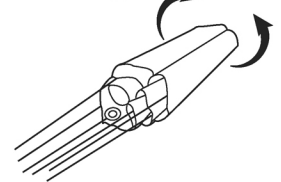

5.

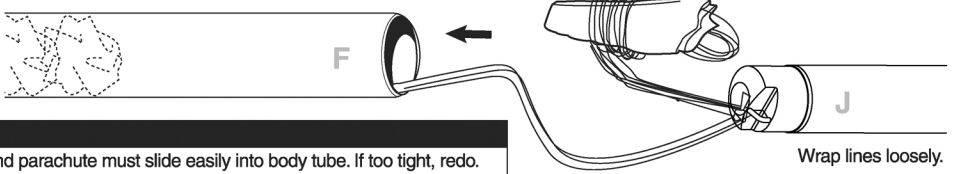

**NOTE:**

Recovery wadding and parachute must slide easily into body tube. If too tight, redo.

## PREPARE PAYLOAD SECTION FOR LAUNCH

1. Remove nose cone from payload section.

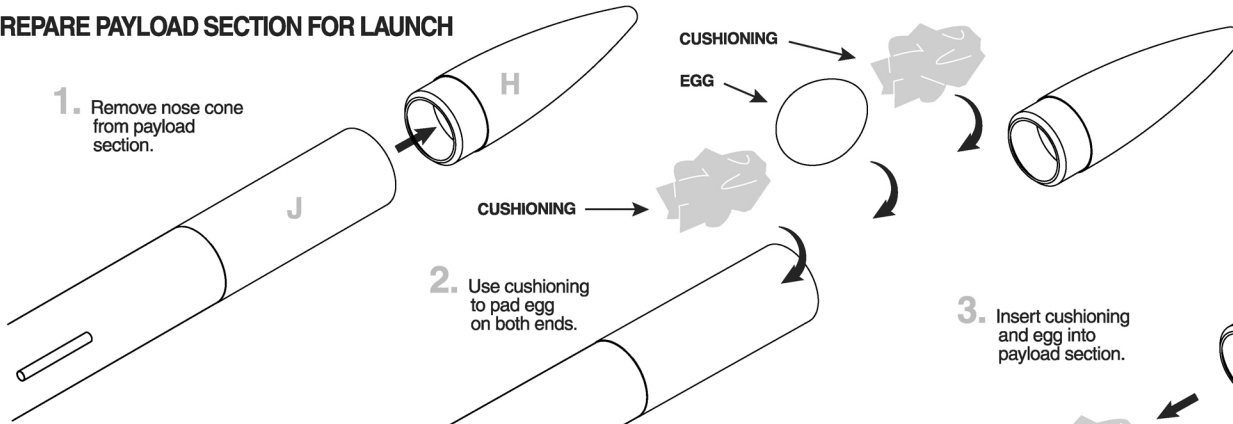

2. Use cushioning to pad egg on both ends.

3. Insert cushioning and egg into payload section.

4. Reattach nose cone to payload section.

### SUGGESTIONS FOR CUSHIONING

- Paper
- Paper towels
- Tissue
- Tissue paper
- Sponge
- Foam

## PREPARE ENGINE

1. STARTER

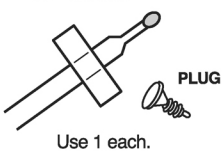

2.

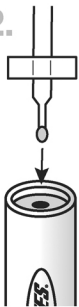

TIP MUST TOUCH PROPELLANT!

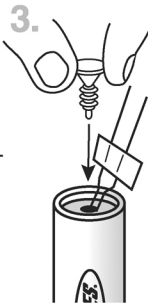

4.



5.

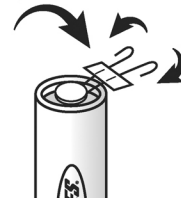

6.

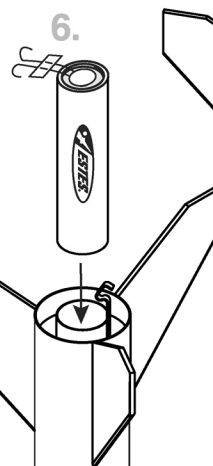

7.

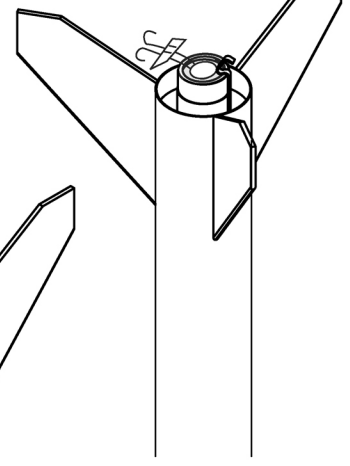

**⚠ WARNING: FLAMMABLE**

To avoid serious injury, read instructions & NAR Safety Code included with engines. PREPARE YOUR ENGINE ONLY WHEN YOU ARE OUTSIDE AT THE LAUNCH SITE PREPARING TO LAUNCH. If you do not use your prepared engine, remove the starter before storing your engine.

# LAUNCH PROCEDURE

- ESTES® LAUNCH SUPPLIES NEEDED (Sold Separately)**
- Launch Pad
  - Launch Controller
  - 3/16 in. (5mm) Maxi™ Launch Rod
  - Recovery Wadding
  - Starters (with engines)
  - Plugs (with engines)
  - Recommended Estes® Engines  
With Egg: C11-3, C11-5, D12-5  
Without Egg: C11-5, D12-5, D12-7

**NOTE:**  
Key always out until final countdown!

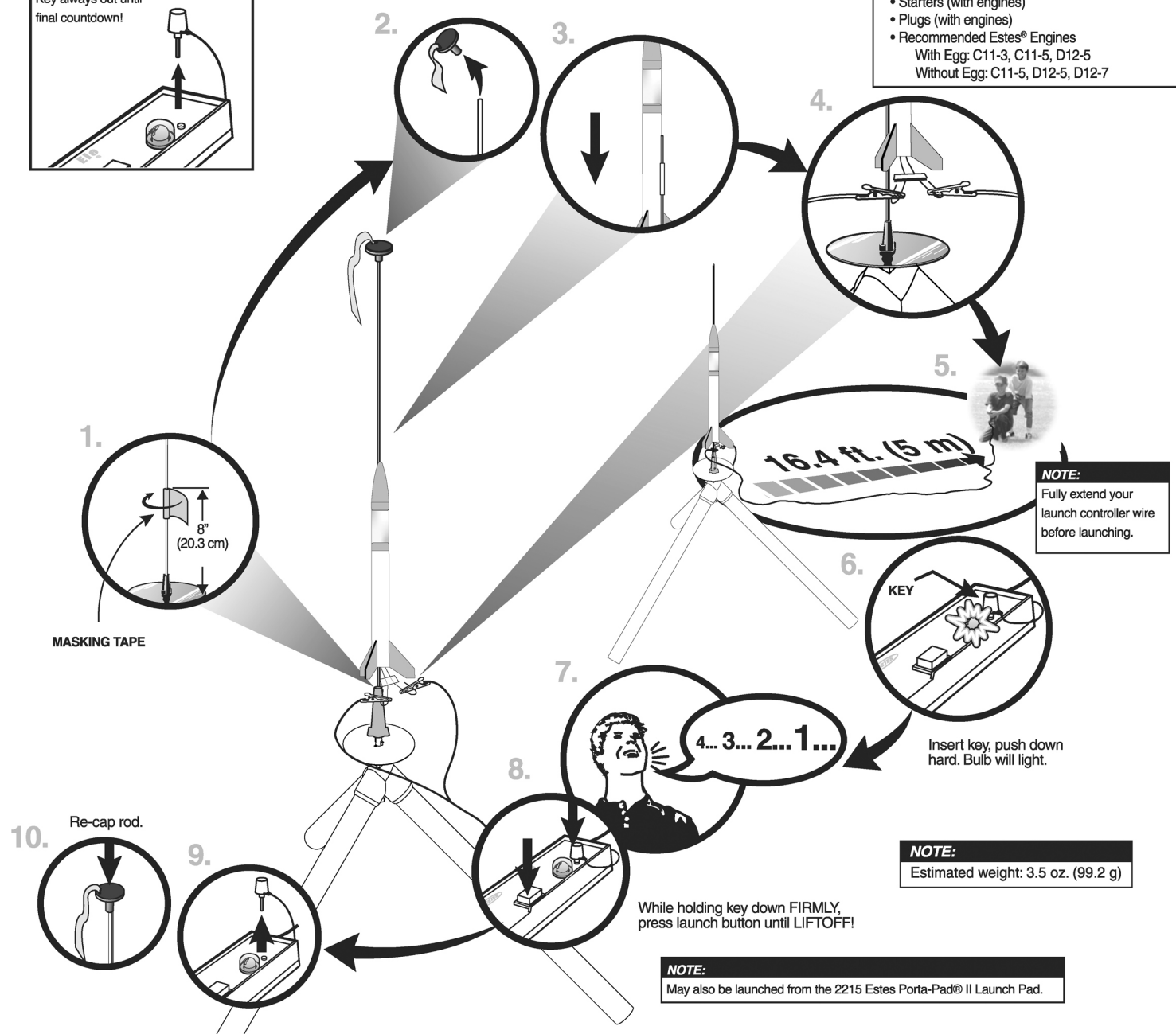

**NOTE:**  
Fully extend your launch controller wire before launching.

**NOTE:**  
Estimated weight: 3.5 oz. (99.2 g)

While holding key down FIRMLY, press launch button until LIFTOFF!

**NOTE:**  
May also be launched from the 2215 Estes Porta-Pad® II Launch Pad.

# PRECAUTIONS

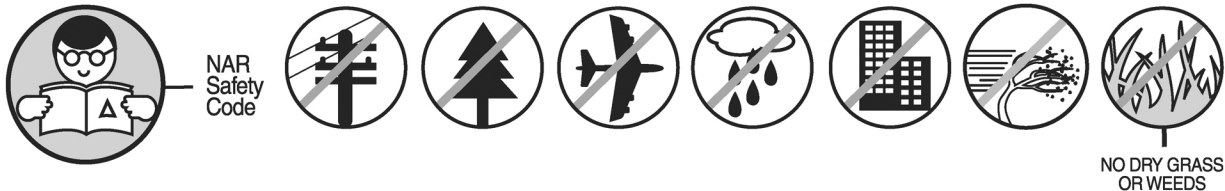

**PRE-LAUNCH CHECK** For safety, never launch a damaged rocket. Check the rocket's body, nose cone and fins. Also, check the engine mount, recovery system and launch lug(s). Repair any damage before launching the rocket.

**FLYING YOUR ROCKET** Choose a large field (500 ft. [152 m] square) free of dry weeds and brown grass. The larger the launch area, the better your chance of recovering your rocket. Football fields and playgrounds are great. Launch only with little or no wind and good visibility. Always follow the National Association of Rocketry (NAR) SAFETY CODE (enclosed).

**MISFIRES** TAKE THE KEY OUT OF THE CONTROLLER. WAIT ONE MINUTE BEFORE GOING NEAR THE ROCKET! Disconnect the micro clips and remove the engine. Take the plug and starter out of the engine. If the starter has burned, it worked but did not ignite the engine because it was not touching the propellant inside the engine. Put a new starter all the way inside the engine without bending it. Push the plug in place. Repeat the steps under Countdown and Launch.

