





Estes-Cox Corp.
1295 H Street, PO Box 227
Penrose, CO 81240-0227
Printed in China

REFLECTOR™

#2422

FLYING MODEL ROCKET KIT INSTRUCTIONS

KEEP FOR FUTURE REFERENCE

ASSEMBLY TIP: Read all instructions before beginning work on your model. Make sure you have all parts and supplies.



www.
estes
rockets
.com

NOTE: Test fit all parts together before applying glue. If parts don't fit properly, sand as required for precision assembly.

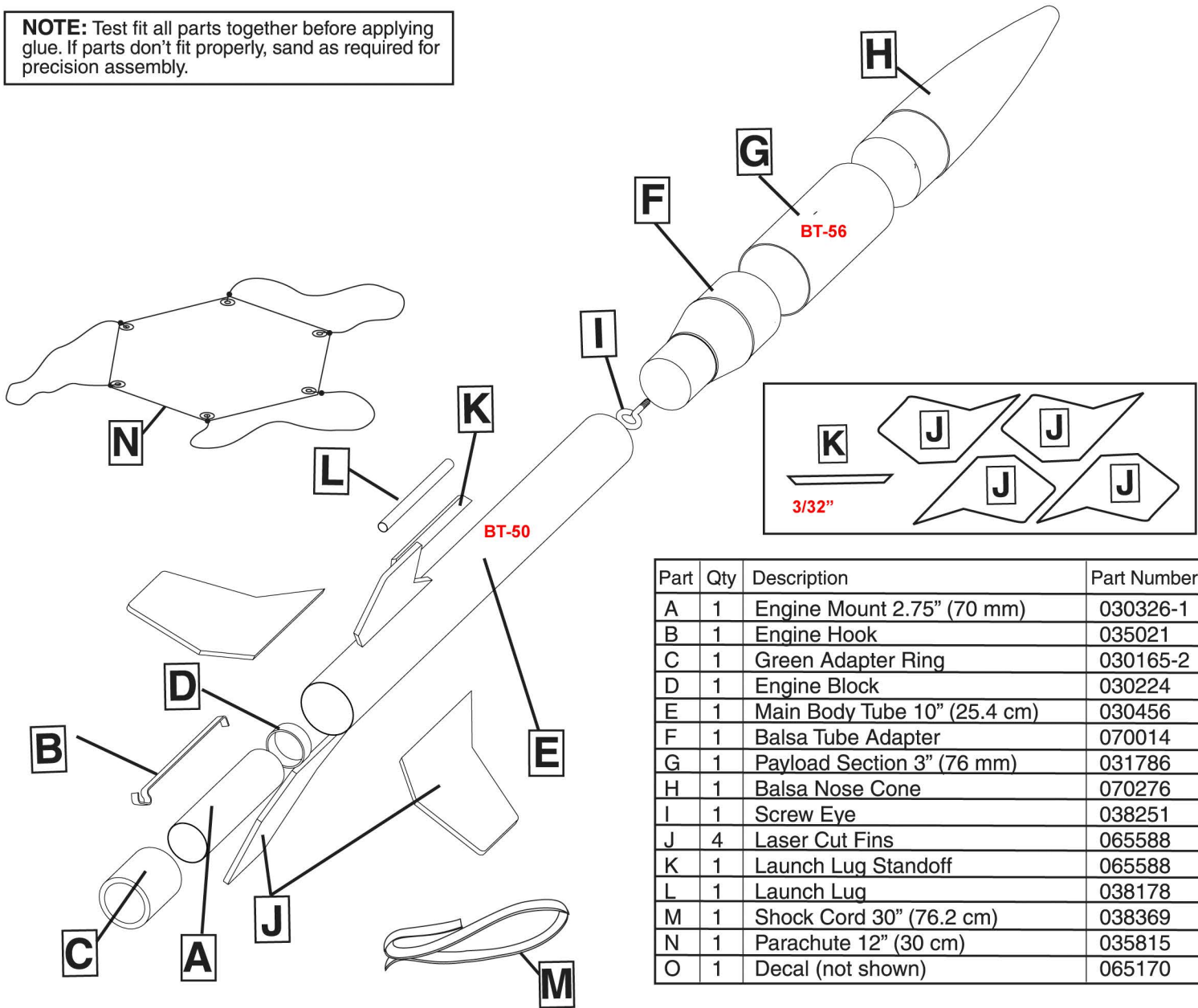

Part	Qty	Description	Part Number
A	1	Engine Mount 2.75" (70 mm)	030326-1
B	1	Engine Hook	035021
C	1	Green Adapter Ring	030165-2
D	1	Engine Block	030224
E	1	Main Body Tube 10" (25.4 cm)	030456
F	1	Balsa Tube Adapter	070014
G	1	Payload Section 3" (76 mm)	031786
H	1	Balsa Nose Cone	070276
I	1	Screw Eye	038251
J	4	Laser Cut Fins	065588
K	1	Launch Lug Standoff	065588
L	1	Launch Lug	038178
M	1	Shock Cord 30" (76.2 cm)	038369
N	1	Parachute 12" (30 cm)	035815
O	1	Decal (not shown)	065170

SUPPLIES In addition to the parts included in the kit you will also need:

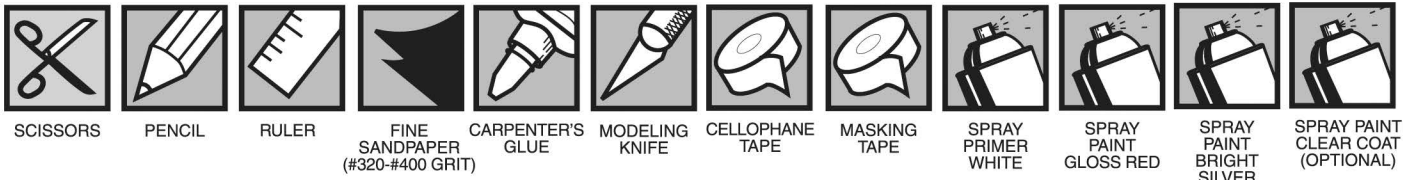

TUBE MARKING GUIDE AND SHOCK CORD MOUNT

(Make a copy if you want to keep instructions.)

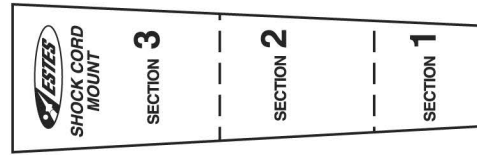
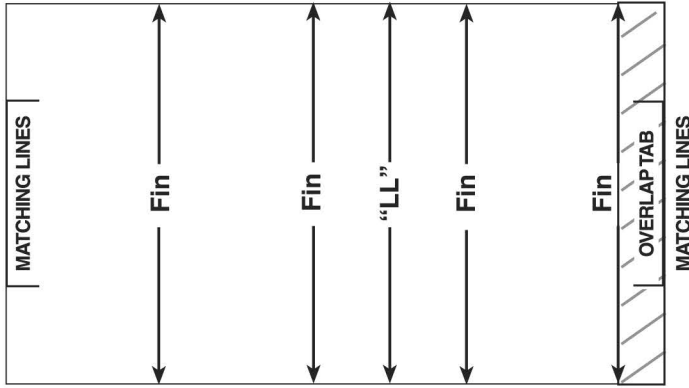

FIN PREPARATION

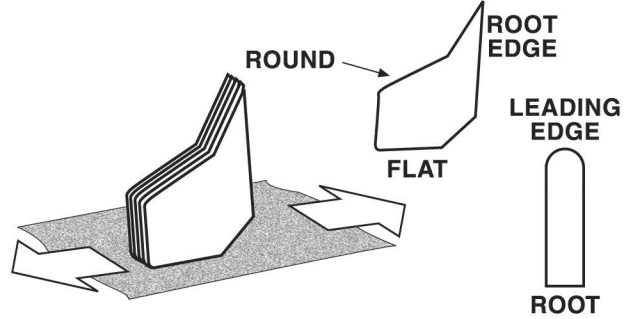
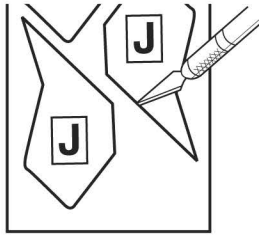
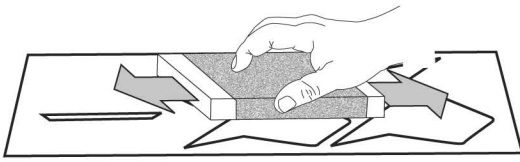

1. Sand both sides of balsa sheet with fine sandpaper (#320 or #400 grit).

2. Cut **J** and **K** from sheet.

3. Stack like fins together. Sand edges smooth. Do not sand root edge round.

4. Sand leading edge round.

ENGINE MOUNT ASSEMBLY

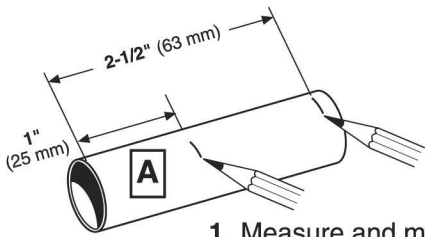

1. Measure and mark **A**.

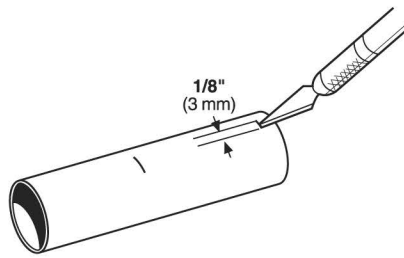

2. Cut slit at mark.

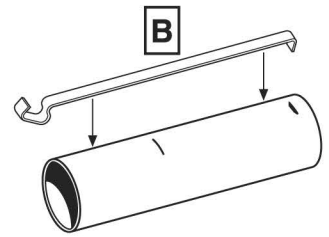

3. Insert **B** in slit.

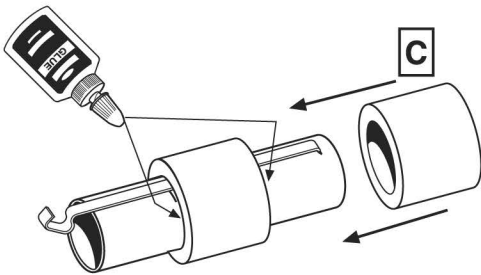

4. Slide **C** to mark. Apply glue to both sides of **C**.

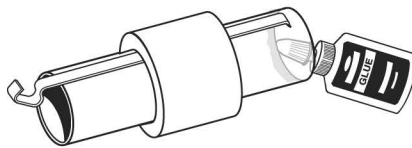

5. Apply glue in end of **A**.

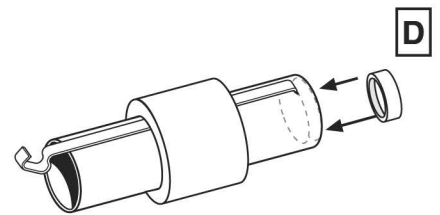

6. Insert **D** until it stops. Let dry.

TUBE MARKING

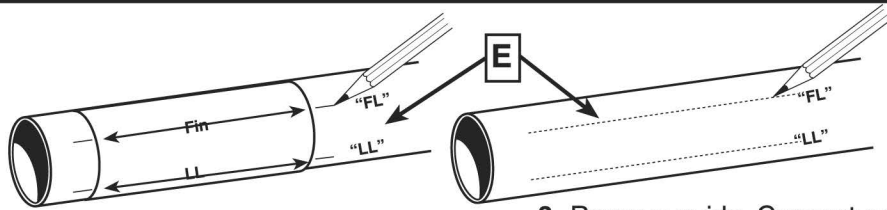
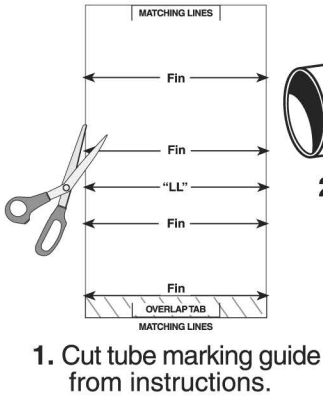

3. Remove guide. Connect and extend all lines. Use door frame as a straight edge.

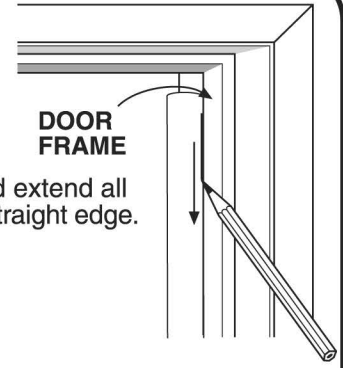
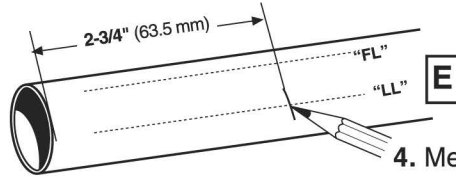

FIN ATTACHMENT

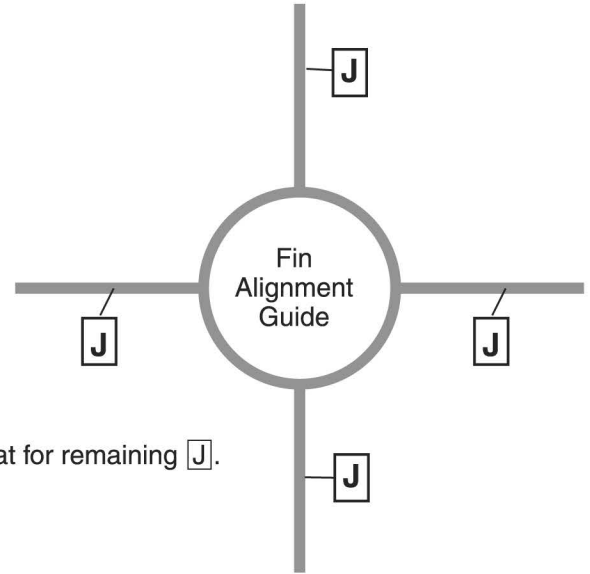
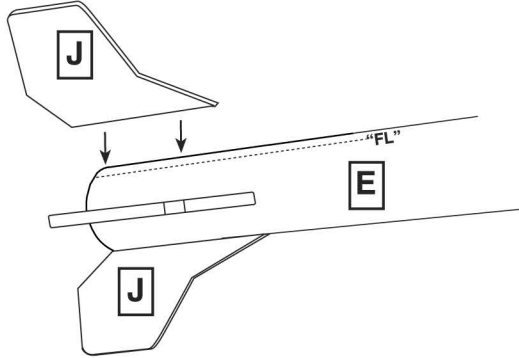
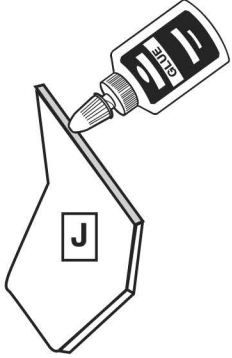

LAUNCH LUG ATTACHMENT

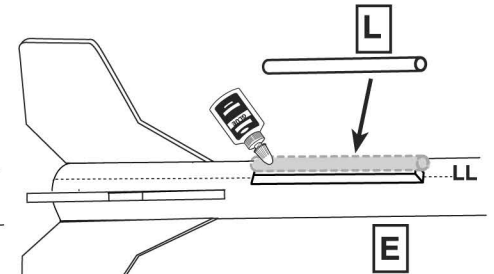
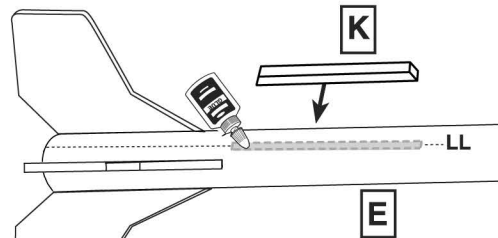
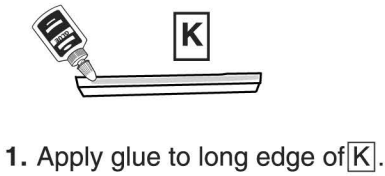

ENGINE MOUNT INSTALLATION

NOTE: Fin removed from drawing for clarity.

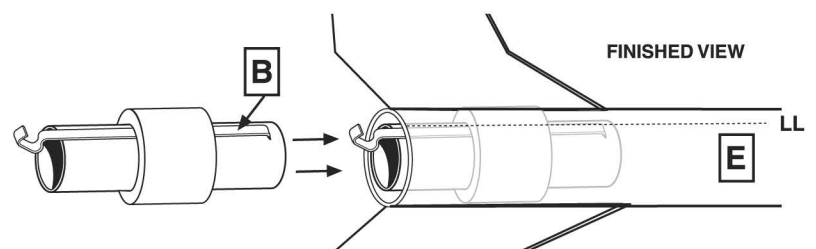
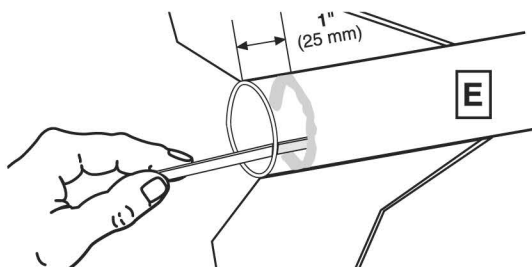

PAYLOAD SECTION ASSEMBLY

1. Screw **I** into **F**.

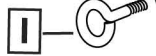

2. Test fit **F** in **G**. Sand **F** if necessary to fit.

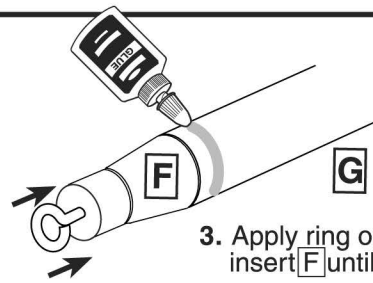

3. Apply ring of glue in end of **G** insert **F** until stops. Let dry.

NOSE CONE ASSEMBLY

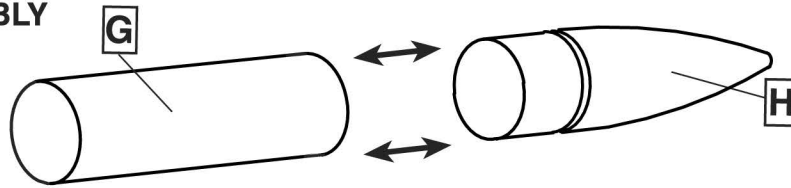

1. Test fit **H** in **G**. If necessary sand to fit. **DO NOT GLUE IN PLACE.**

2. Remove **H** for painting.

HELPFUL HINT: IF NOSE CONE FIT IS...

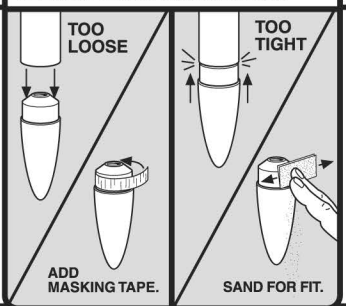

SHOCK CORD MOUNT INSTALLATION

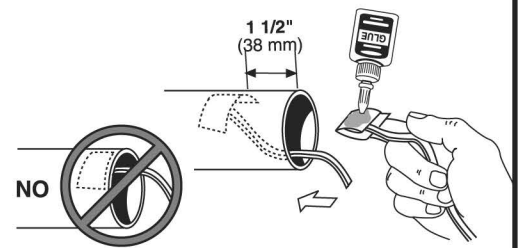
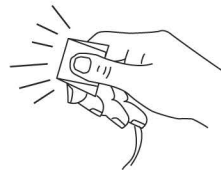
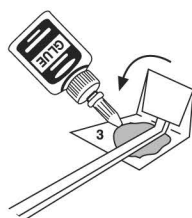
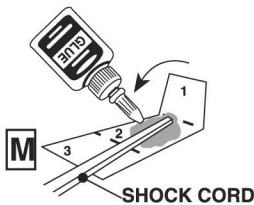
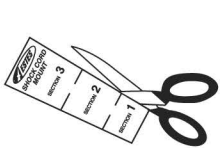

1. Cut shock cord mount from instructions.

2. Apply glue to section 2. Place **M** on glue. Fold forward.

3. Apply glue and fold forward.

4. Squeeze tight!

5. Apply glue to shock cord mount and insert in body tube. Hold until glue sets. Let dry.

ROCKET FINISHING

NOTE: We have found Testors spray primers (Testors #2948 White Primer), Testors One Coat Lacquer spray paints (color of your choice), Testors Model Master spray paints (color of your choice) and Testors Gloss Lacquer (#1961) to be excellent for providing a long lasting and durable finish on your rocket. Always be sure to spray your models outside or in a well ventilated area.

STEPS FOR A QUALITY FINISH

1. Insert shock cord into body tube and hold in place with paper.
2. Lightly sand entire rocket with fine sandpaper (#320 or #400 grit).
3. Apply glue fillet to fins and launch lug joints.
 - a. Let glue dry overnight.
4. Paint the main rocket body, payload section and nose cone separately. Assemble after painting is complete.
5. Use a stick inserted into the motor tube end of the rocket body for painting.
6. Hold the payload section by the screw tube with a clip or pliers for painting.
7. Insert a small nail into the base of the nose cone for painting.
8. We recommend a good filler/primer to be applied to the balsa fins, tube adapter and nose cone before painting.
9. Sand after each application for a smooth finish.
10. Apply 1-2 light coats of white primer to upper and lower rocket sections.
11. Lightly sand with fine sandpaper (#320 or #400 grit) between coats. Allow to dry between each coat.
12. Spray paint main rocket body gloss white.
 - a. Let paint dry overnight (24 hours is best).
13. Apply masking tape and protective cover around main rocket body above fins.
14. Spray paint fins bright red.
 - a. Let paint dry overnight (24 hours is best). Remove tape.
15. Spray payload section bright silver or platinum.
 - a. Let paint dry overnight (24 hours is best).
16. Spray paint nose cone bright silver or platinum.
 - a. Let paint dry overnight (24 hours is best). Remove tape.
17. Apply waterslide decals where shown.
 - a. Cut the decal to be applied from the decal sheet, trimming close to the decal edge.
 - b. Hold the decal in warm water until decal begins to curl.
 - c. Remove the entire decal, position in place and slide the decal from the backing material and onto the model as close to final position as possible.
 - d. Gently blot out excess water with a clean paper towel.
 - e. Let decals set overnight before applying protective clear coat.
18. When decals are dry, spray entire rocket (main body, payload section and nose cone separately) with a light coat of Testors Gloss Lacquer (#1961). This will provide added protection and shine to your Reflector™ rocket!



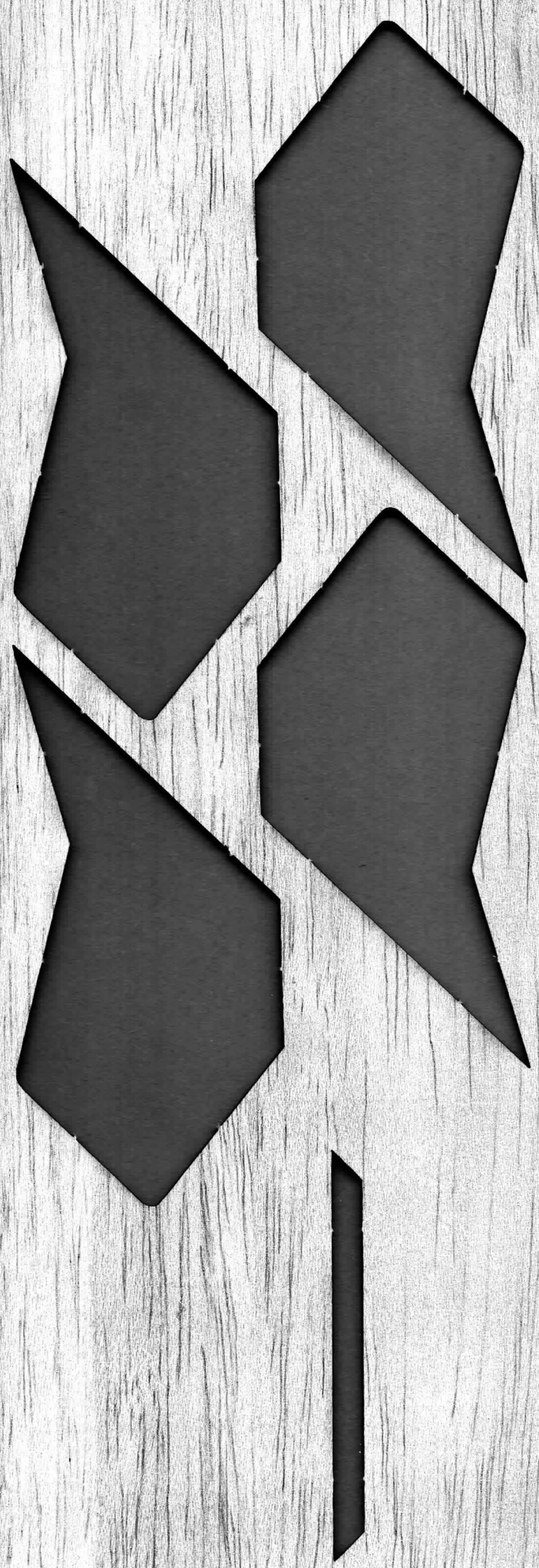
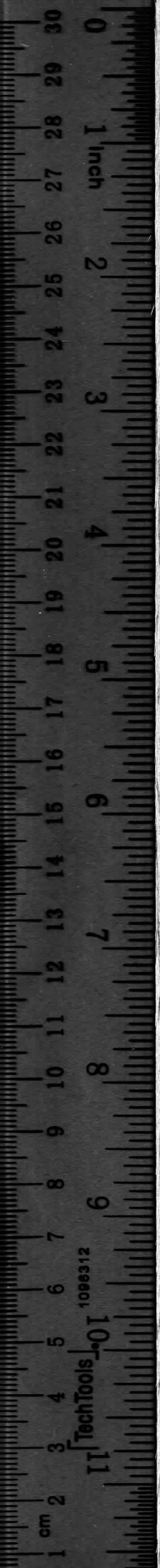



© 2008-2010 Estes-Cox Corp.
All rights reserved.
Printed in Guangdong, China.
PN 65170 (6-10)

26 10

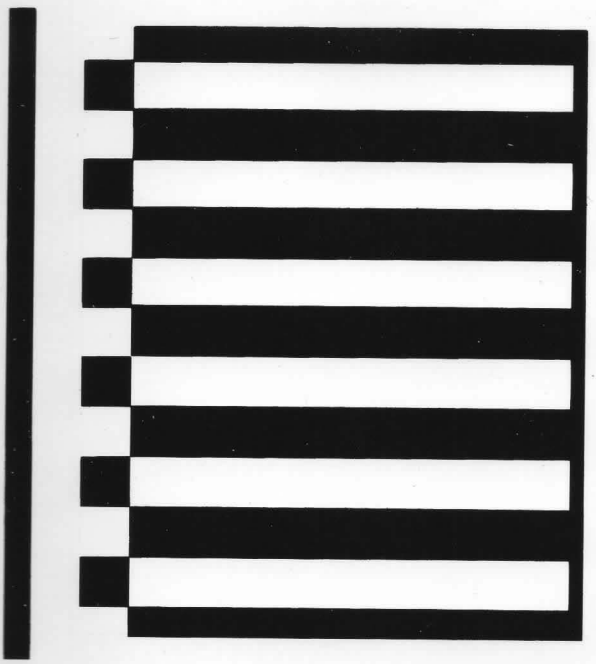



REFLECTOR

FLYING WINGS ROCKET KIT

Model Rocket

Kit Level 1

- Huge Payload Section!
- Laser Cut Balsa Fins!
- 12" (30 cm) Parachute Recovery!

FLIES
UP TO
750
FEET
HIGH!

OVER
20 INCHES
DIA. PAYLOAD
TALL!



2422



© 2004 Estes Industries, Inc.
All rights reserved. The name of the
company is a registered trademark.

