

KEEP FOR FUTURE REFERENCE

ASSEMBLY TIP: Read all the instructions before beginning work on your model. TEST FIT all parts before applying any glue. If any parts don't fit properly, sand as required for precision assembly.

SUPPLIES REQUIRED:



PLASTIC CEMENT



CARPENTER'S GLUE



MODELING KNIFE



PENCIL



FINE SAND PAPER (#400-600 GRIT)



RULER



MASKING TAPE

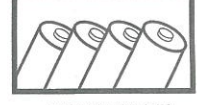

4 'AA' ALKALINE BATTERIES

ALL GLUED AREAS ARE SHADED IN GRAY

PARTS LAYOUT:

Locate the parts shown below and lay them out on the table in front of you. DO NOT USE THIS DRAWING TO ASSEMBLE YOUR ROCKETS.

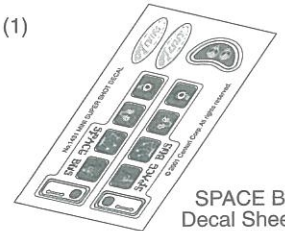
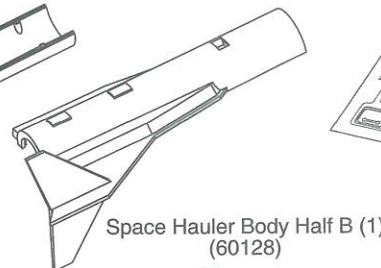
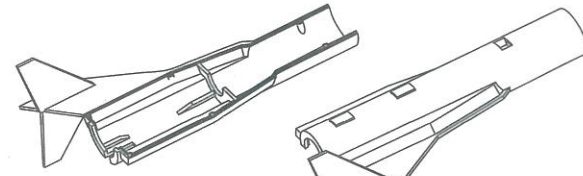
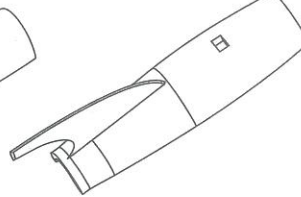
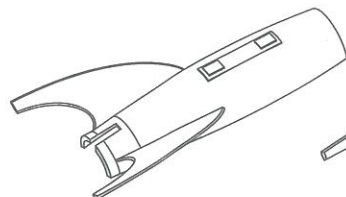
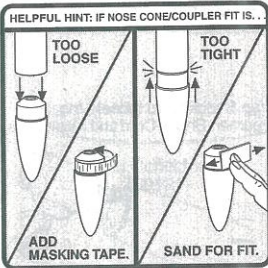

SPACE BUS ROCKET ASSEMBLY: ALWAYS TEST FIT PARTS BEFORE FINAL ASSEMBLY

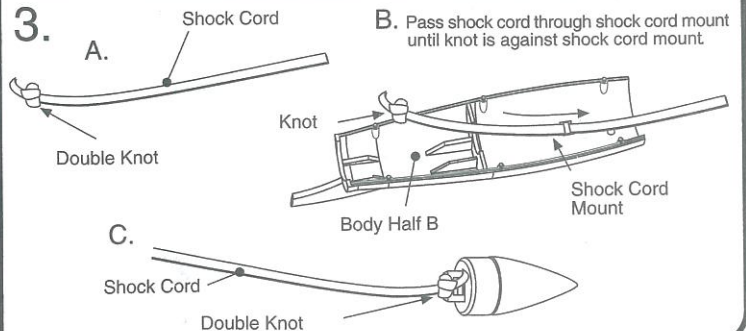
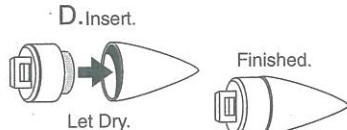
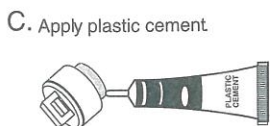
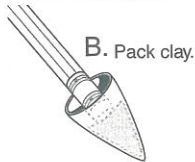
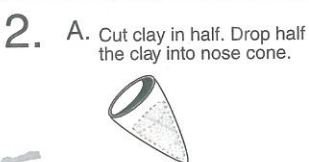
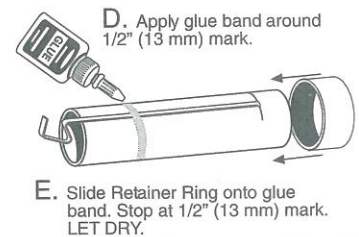
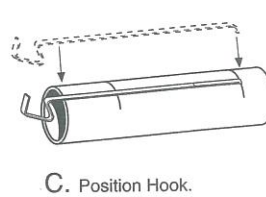
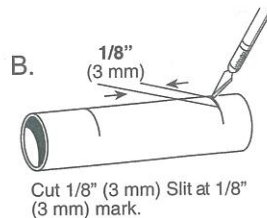
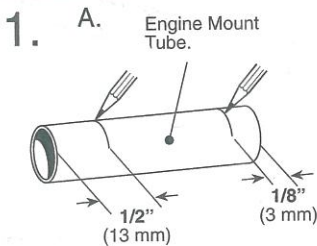

4. A. Align Engine Hook with slot and place Engine Mount inside.

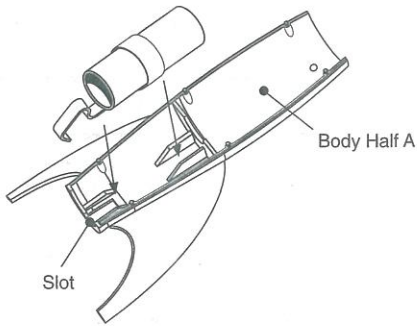

- B. Apply plastic cement to Body Half A.

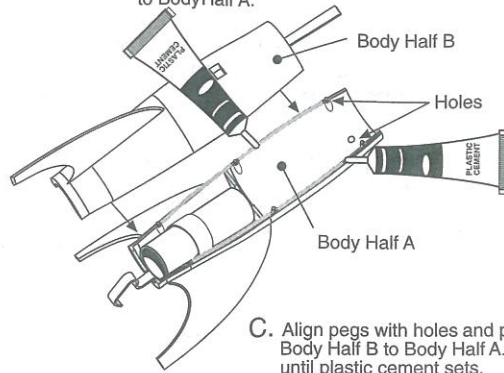

- D. Apply plastic cement to Launch Lug.

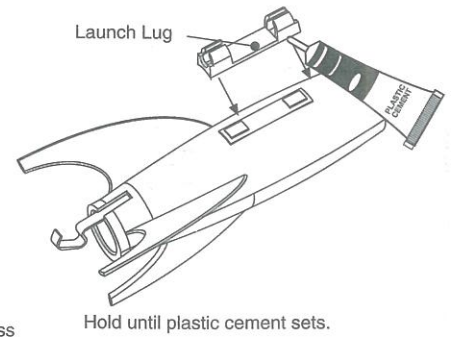

- C. Align pegs with holes and press Body Half B to Body Half A. Hold until plastic cement sets.

FINISH YOUR ROCKET - USE PACKAGE PANEL FOR DECAL PLACEMENT.

ROCKET PREFLIGHT

- A. Tie Streamer to Shock Cord.

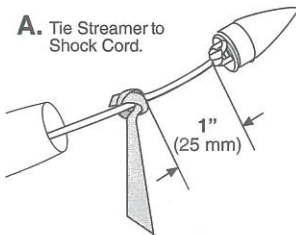

- B. Insert 1/2 loosely crumpled square of recovery wadding.

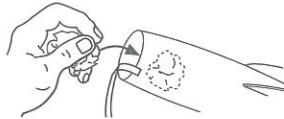

- C. Fold streamer.



- D. Roll.

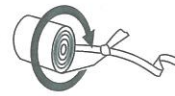

- E. Wrap Shock Cord loosely, insert Streamer, Shock Cord and Nose Cone.

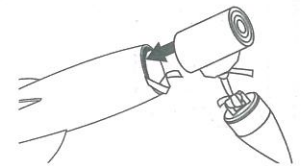

SPACE HAULER ROCKET ASSEMBLY: ALWAYS TEST FIT PARTS BEFORE FINAL ASSEMBLY

1. A. Engine Mount Tube.

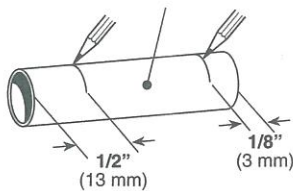

- B. Cut 1/8" (3 mm) slit at 1/8" (3 mm) mark.

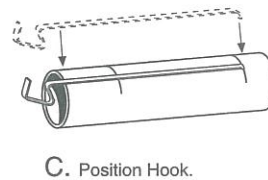
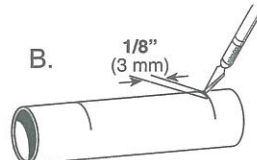

- C. Position Hook.

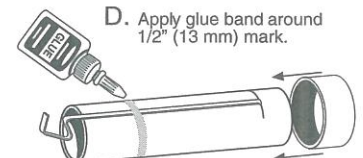

- E. Slide retainer ring onto glue band. Stop at 1/2" (13 mm) mark. LET DRY.

2. A. Drop remaining clay into Nose Cone.



- B. Pack clay.

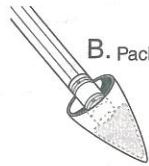

- C. Apply plastic cement.



- D. Insert.

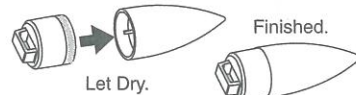

3. A. Shock Cord

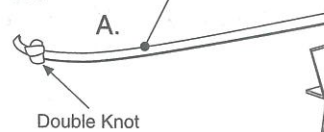

- B. Pass Shock Cord through Shock Cord Mount until knot is against Shock Cord Mount.

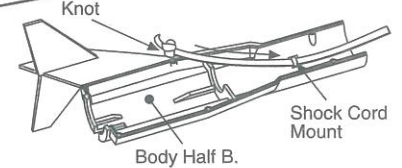

- C. Tie shock cord to nose cone.



4. A. Align Engine Hook with slot in body half and place Engine Mount inside.

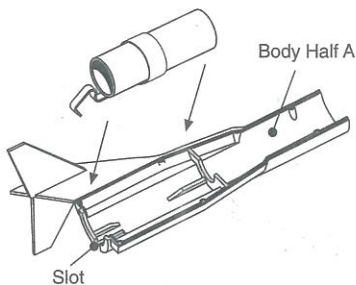

- B. Apply plastic cement to Body Half A.

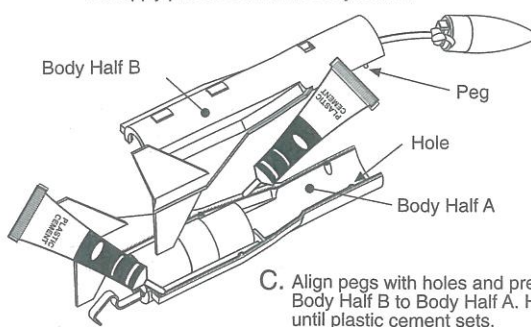

- D. Apply plastic cement to Launch Lug.

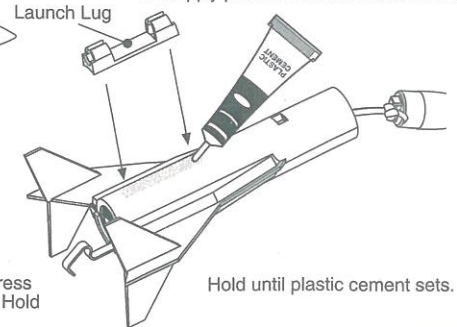

- C. Align pegs with holes and press Body Half B to Body Half A. Hold until plastic cement sets.