



ESTES INDUSTRIES (1-98) 84515
1295 H Street
Penrose, CO 81240

EST 2077



SKYWINDER™

FLYING MODEL ROCKET KIT INSTRUCTIONS

MATERIALS REQUIRED:

PENCIL, RULER, PAPER TOWEL OR RAG, WHITE OR YELLOW GLUE, SANDPAPER, TUBE-TYPE PLASTIC CEMENT, SCISSORS, HOBBY KNIFE

ALL GLUED AREAS ARE SHADED IN GRAY

BE SURE TO READ ALL INSTRUCTIONS, TEST FIT ALL PARTS, AND SAND IF NECESSARY BEFORE GLUING.

PARTS LAYOUT

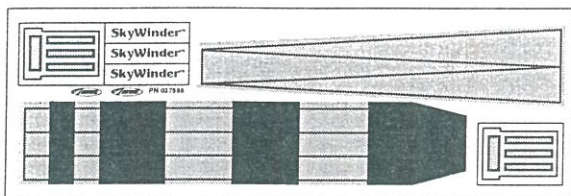

DECAL SHEET (1)
37588



CLAY WEIGHT
(2 PACKS)
85705

NOSE
CONE
56A (1)
72015



EXTERNAL SLIDE (1)
37972-1



BLACK SUPPORT RING (1)
30200-3



SLIDE STOP (1)
37973-1

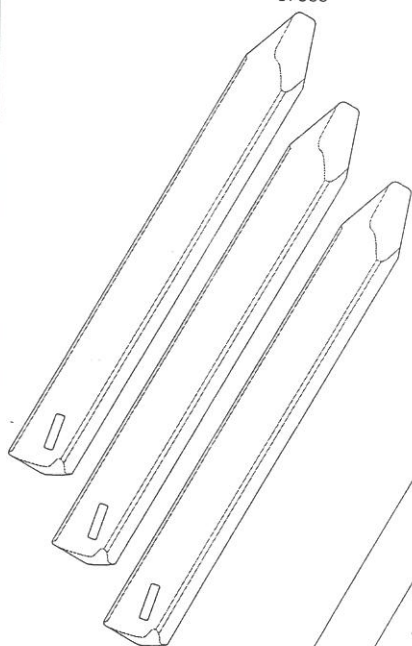

ROTOR BLADES (3)
37970



WHITE BODY
TUBE (1)
31217

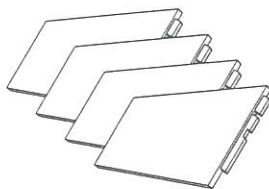

PLASTIC FINNS (4)
37968



RUBBER BANDS (3)
44060



RED TUBE COUPLER (1)
30184-5



ROTOR HUB (1)
37901

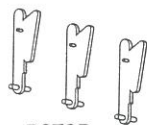

ROTOR
MOUNTS (3)
37971



ROTOR BASE (1)
37979-1



CARDBOARD RING (1)
32468



BLUE ENGINE
MOUNT TUBE (1)
30295



LAUNCH LUG (1)
37967

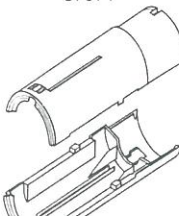

PLASTIC ENGINE
MOUNT HALVES (2)
37964

1.

A. Test fit the plastic engine mount halves together. Use a hobby knife to carefully remove any excess plastic (flash) that may interfere with a good fit.

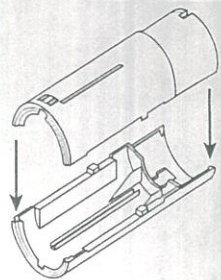

B. Cement the two plastic engine mount halves together.

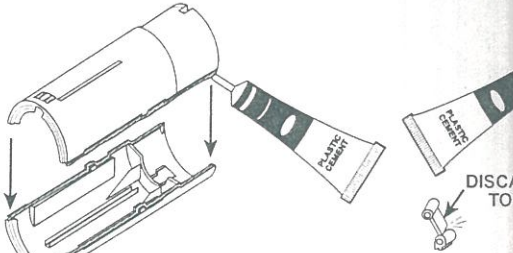

C. Snap the launch lug into the lower launch area on the engine. Let assembly dry.

4.

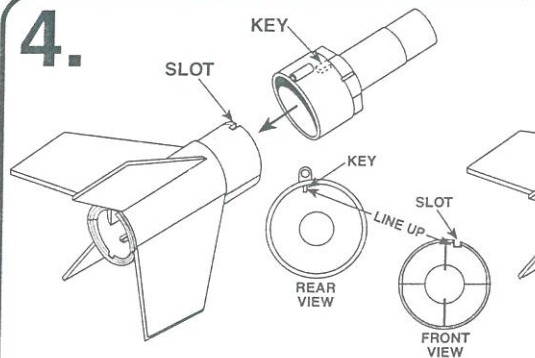

A. Test fit the rotor base onto the shoulder of the rotor hub. Note how the "key" in the base fits into the slot in the shoulder. Apply plastic cement around the interface as shown and slide back onto fin assembly shoulder.

5.

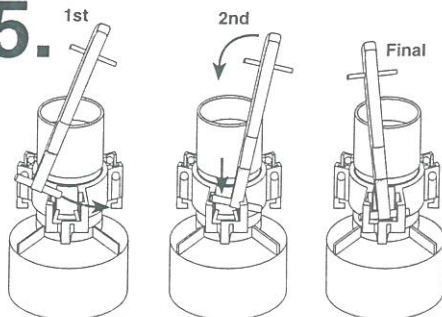

A. Slide the right side pin of a rotor mount into the right side of one of the mount slots on the rotor hub. Gently push pin to the right and slip the left pin into its slot. DO NOT FORCE THE MOUNTS INTO POSITION! If the mount is upside down, it will not fit.

B. Repeat step "A" to apply the other two mounts.

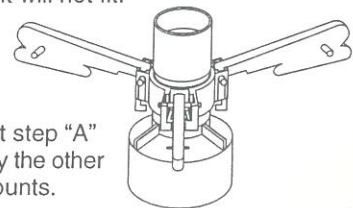

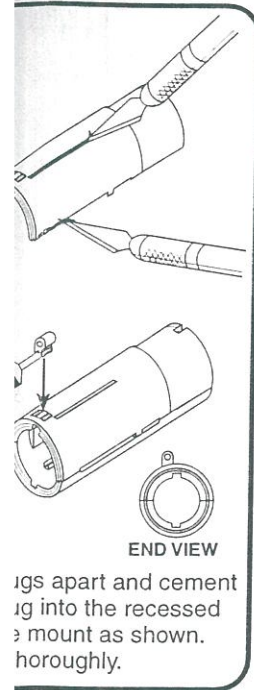

ings apart and cement
ng into the recessed
mount as shown.
oroughly.

2.

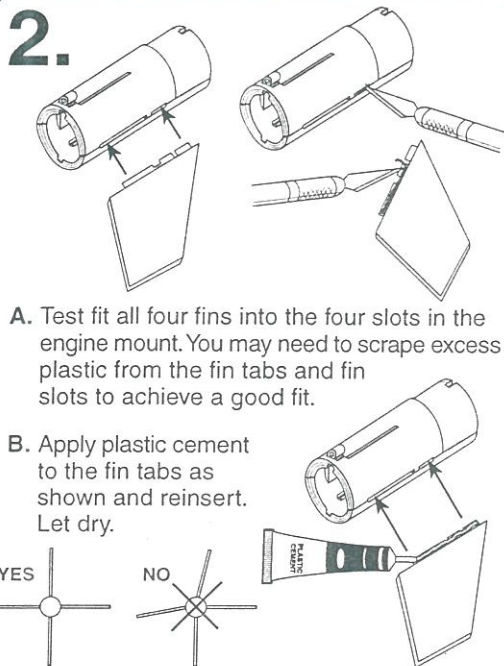

- A. Test fit all four fins into the four slots in the engine mount. You may need to scrape excess plastic from the fin tabs and fin slots to achieve a good fit.
- B. Apply plastic cement to the fin tabs as shown and reinsert. Let dry.

3.

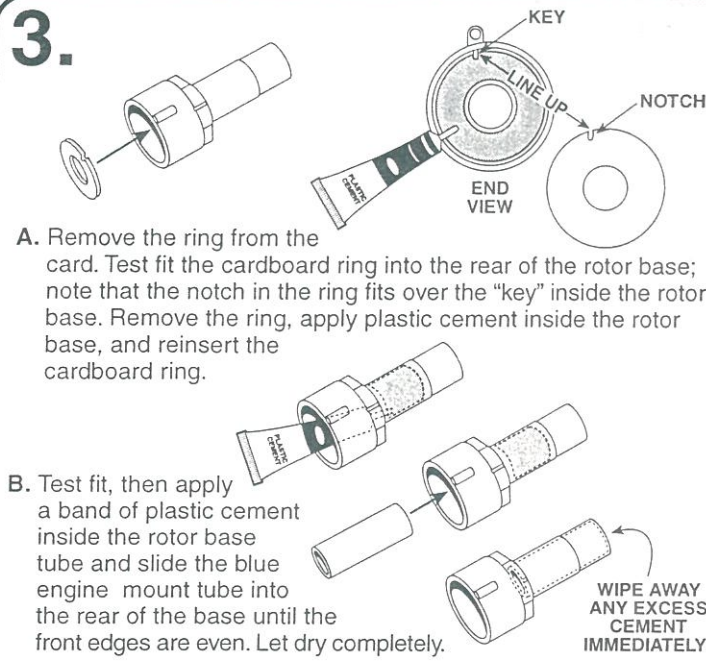

- A. Remove the ring from the card. Test fit the cardboard ring into the rear of the rotor base; note that the notch in the ring fits over the "key" inside the rotor base. Remove the ring, apply plastic cement inside the rotor base, and reinsert the cardboard ring.
- B. Test fit, then apply a band of plastic cement inside the rotor base and slide the blue engine mount tube into the rear of the base until the front edges are even. Let dry completely.

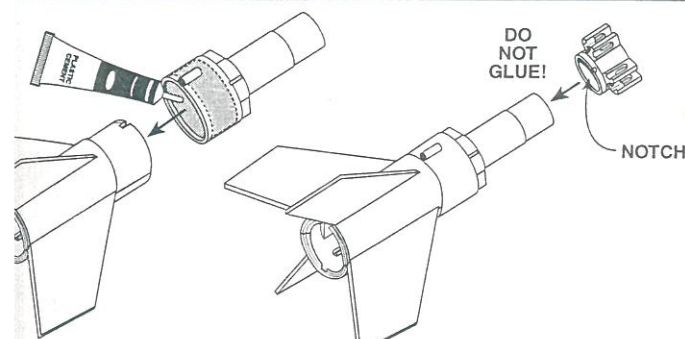

assembly. Note
n assembly
of the base as
Let dry.

- B. Slide the rotor hub onto the front of the rotor base with the notched end facing the fins. **DO NOT GLUE!**

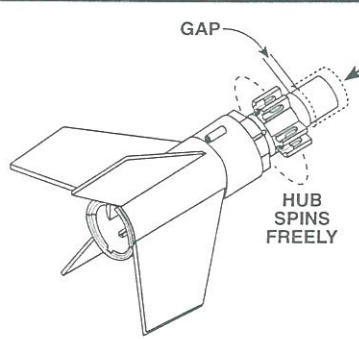

- C. Test fit the red tube coupler onto the front of the rotor base. Leave a slight gap between the coupler and the hub, and check that the hub still spins freely. If not, use fine grain sandpaper to sand the inside of the hub until it spins freely.

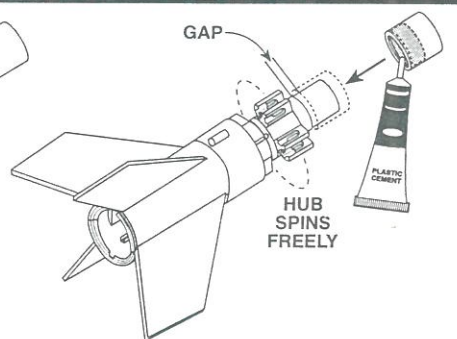

- D. Apply a thin ring of plastic cement inside the tube coupler and slide back into position. **BEFORE CEMENT DRIES: BE SURE YOU HAVE LEFT SMALL GAP AND THAT THE HUB SPINS FREELY!** Let dry.

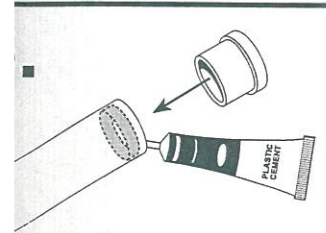

Apply plastic cement just
inside one end of the body
tube and insert the slide stop
as shown. Let dry.

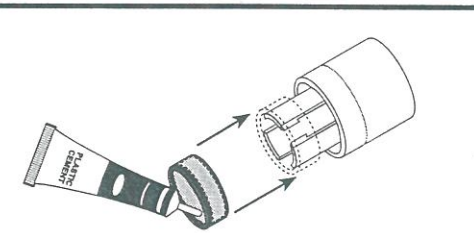

- B. Apply a ring of plastic cement around the inside of the black support ring and slide the ring onto the tongs of the external slide until the edge of the ring is even with the end of the tongs. Let dry completely.

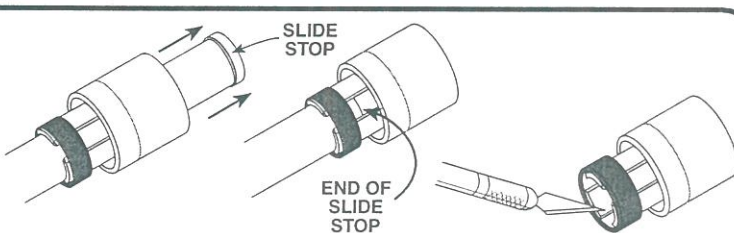

- C. Check that the cement around the slide stop is completely dry, and slide the external slide up the body tube as shown until it hits the slide stop. **DO NOT GLUE!**
NOTE: You may need to remove excess plastic from the inside of the tongs in order for the external slide to move smoothly down the tube.

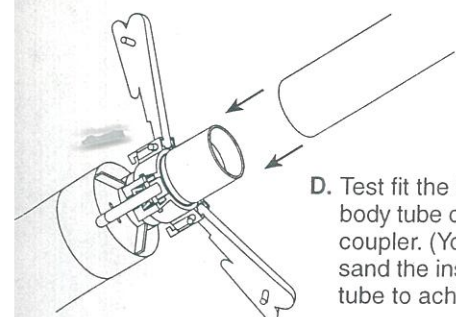

- D. Test fit the free end of the body tube onto the red tube coupler. (You may need to sand the inside of the white tube to achieve a good fit.)

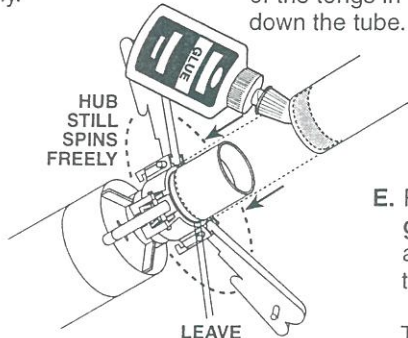

- E. Remove tube, apply a ring of white or yellow glue just inside the free end of the body tube, and in one continuous motion slide the body tube over the coupler until their edges are even. Be careful not to slide the body tube too far - **THE HUB MUST SPIN FREELY!** Let dry.